

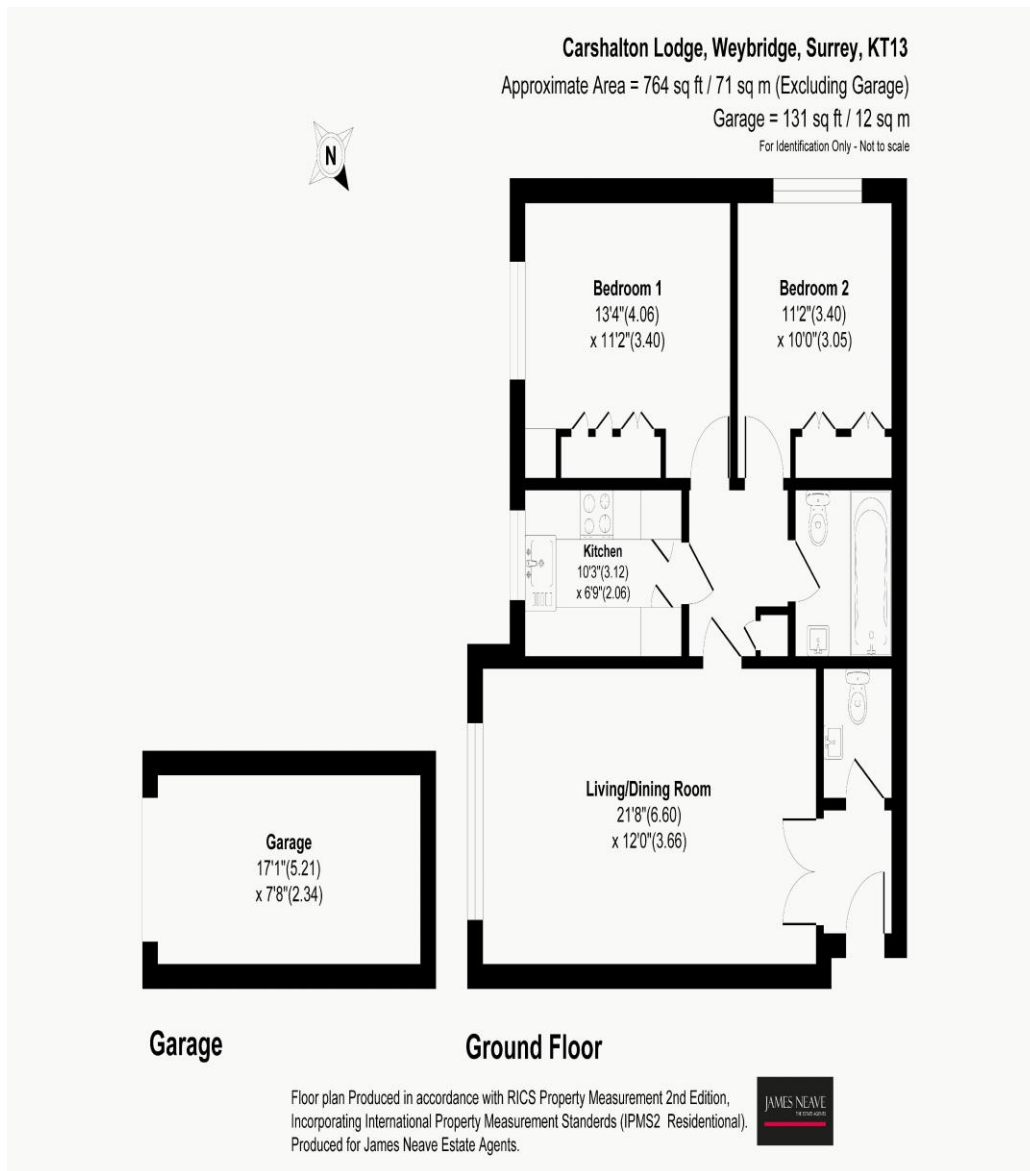

1 Carshalton Lodge Oatlands Drive Weybridge Surrey KT13 9LJ

Offers Over £340,000





Located in the heart of the highly sought-after Oatlands area, this well presented two-bedroom, ground-floor apartment is offered with the benefit of no onward chain. This property represents a fantastic opportunity for first-time buyers, downsizers, or savvy investors looking for a turn-key home in a prime KT13 location. The apartment has been thoughtfully maintained and updated, offering a bright and airy feel throughout. The heart of the home is a spacious, separate lounge that provides ample room for both relaxation and dining. The modern kitchen is well-appointed, while the family bathroom is complemented by the convenient addition of a separate cloakroom. Both bedrooms are well-proportioned, and the overall presentation ensures the new owner can move straight in if desired.

Positioned within a well-kept and quiet residential block, the property benefits from a Share of Freehold with an impressive underlying lease of over 900 years. Practicality is also well-catered for, with the inclusion of a private garage en bloc and residents' parking available within the communal grounds. Location is everything here. You are perfectly placed equidistant between Weybridge and Walton-on-Thames town centres, giving you easy access to a superb mix of high-end boutiques, cafes, and supermarkets. For the commuter, Walton mainline station is approximately 0.9 miles away, offering fast and frequent services into London Waterloo. Oatlands Village itself is just a short stroll away, home to charming local shops and the area's highly regarded schooling options. EPC Rating D.



AGENTS NOTES: These details do not constitute any part of an offer or contract. In issuing them we do not have any authority to give any warranty or representation whatsoever in respect of this property. These details are provided without any responsibility on our part or the part of the vendors. No statements in these details are to be relied upon as representations of fact and purchasers should satisfy themselves by inspection or otherwise as to the accuracy of the statements contained therein.

Equipment: We have not tested the equipment or central heating system mentioned in these particulars and purchasers are advised to satisfy themselves as to their working order and condition.

Measurements: Great care is taken when measuring but measurements should not be relied upon for ordering carpets, equipment, etc.