



**13 CHURCH RISE
CHESSINGTON
KT9 2HA
OFFERS IN EXCESS OF
£475,000**

LINK TERRACE HOUSE

THREE BEDROOMS

12'5 X 10'8 LIVING ROOM

15'7 X 12' KITCHEN DINING ROOM

DOUBLE GLAZED WINDOWS

GAS CENTRAL HEATING

EASTERLY FACING GARDEN

14'9 X 10'11 LOG CABIN TO THE REAR

OFF STREET PARKING

VIEWINGS HIGHLY RECOMMENDED



Ground Floor
60.2 sq.m. (648 sq.ft.) approx.

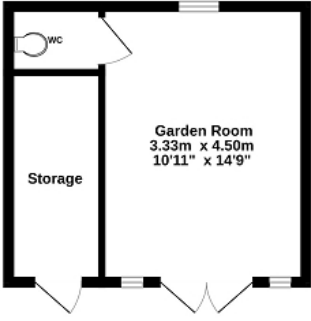
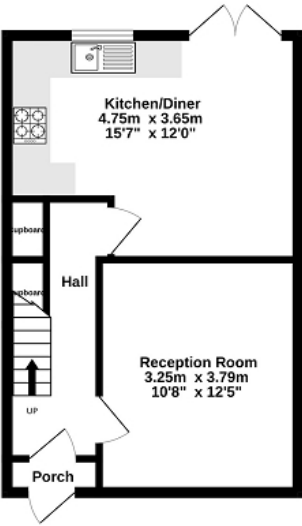

1st Floor
39.5 sq.m. (425 sq.ft.) approx.

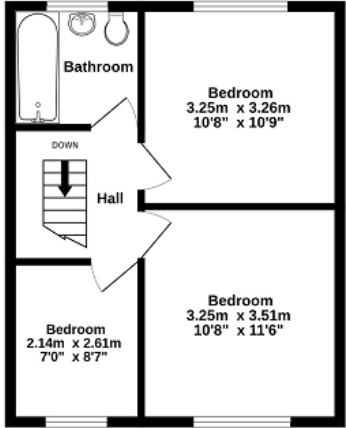

TOTAL FLOOR AREA : 99.7 sq.m. (1073 sq.ft.) approx.

Whilst every attempt has been made to ensure the accuracy of the floorplan contained here, measurements of doors, windows, rooms and any other items are approximate and no responsibility is taken for any error, omission or mis-statement. This plan is for illustrative purposes only and should be used as such by any prospective purchaser. The services, systems and appliances shown have not been tested and no guarantee as to their operability or efficiency can be given.
Made with Metropix ©2025

Energy Efficiency Rating		
	Current	Potential
Very energy efficient - lower running costs		
(92+) A		95
(81-91) B		
(69-80) C	71	
(55-68) D		
(39-54) E		
(21-38) F		
(1-20) G		
Not energy efficient - higher running costs		
England, Scotland & Wales	EU Directive 2002/91/EC	

The energy efficiency rating is a measure of the overall efficiency of a home. The higher the rating the more energy efficient the home is and the lower the fuel bills will be.