



Welbeck Close, Eastbourne BN22 0UA

welcome to

Welbeck Close, Eastbourne

*** GUIDE PRICE -£150,000 - £165,000 ***

A one-bedroom ground-floor maisonette in the popular Hampden Park, featuring its own private entrance and communal side and rear gardens. Located close to local amenities and Hampden Park station, this property is perfect for first-time buyers or investors.



Welbeck Close, Eastbourne, East Sussex
Approximate Gross Internal Area
48 Sq M/517 Sq Ft

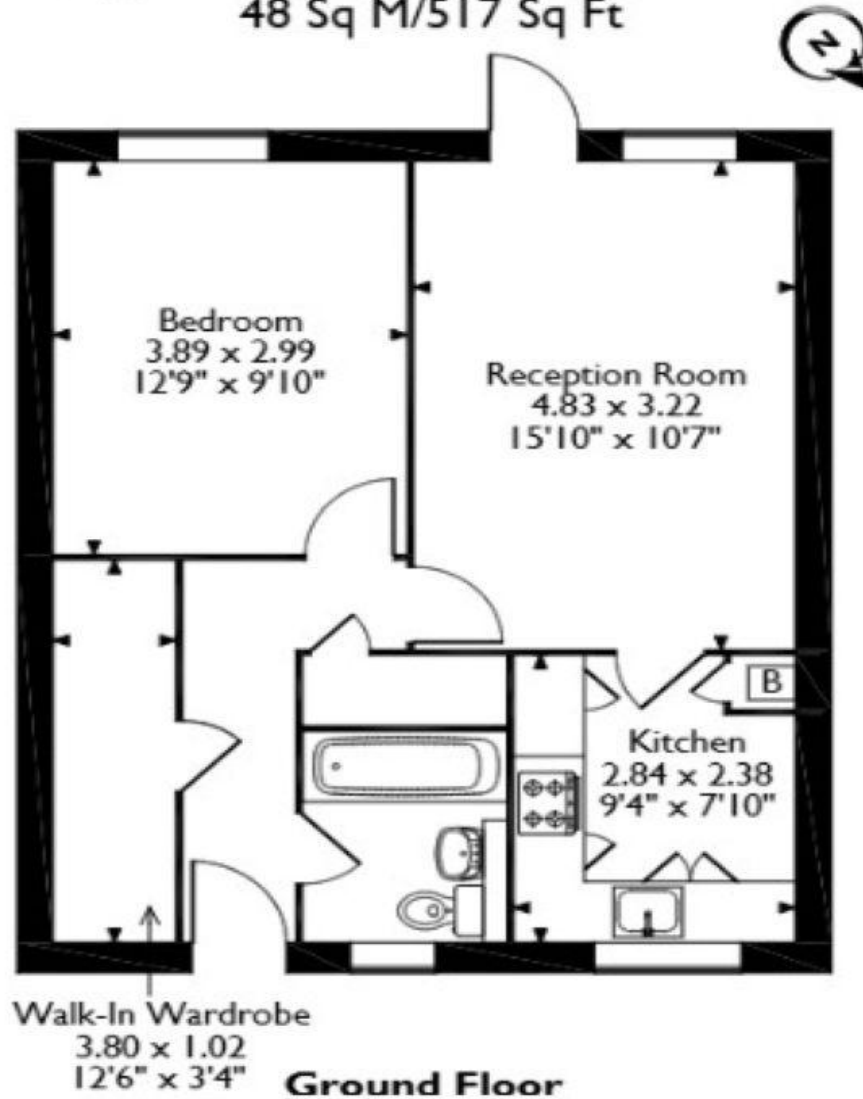

Entrance Hall

Lounge

10' 6" x 15' 10" (3.20m x 4.83m)

Kitchen

9' 3" x 7' 9" (2.82m x 2.36m)

Bedroom

12' 9" x 9' 9" (3.89m x 2.97m)

Bathroom

Communal Garden

welcome to

Welbeck Close, Eastbourne

- ONE BEDROOM GROUND FLOOR MAISONETTE
- *** GUIDE PRICE -£150,000 - £165,000 ***
- SPACIOUS THROUGHOUT
- FITTED KITCHEN WITH SPACE FOR APPLIANCES
- MODERN BATHROOM

Tenure: Leasehold EPC Rating: C

Council Tax Band: A Service Charge: 1020.00

Ground Rent: 10.00

This is a Leasehold property. We are awaiting further details about the Term of the lease. For further information please contact the branch. Please note additional fees could be incurred for items such as Leasehold packs.

£150,000



Please note the marker reflects the postcode not the actual property

view this property online fox-and-sons.co.uk/Property/EBN120836



Property Ref:
EBN120836 - 0005

1. MONEY LAUNDERING REGULATIONS Intending purchasers will be asked to produce identification documentation at a later stage and we would ask for your co-operation in order that there is no delay in agreeing the sale. 2. These particulars do not constitute part or all of an offer or contract. 3. The measurements indicated are supplied for guidance only and as such must be considered incorrect. Potential buyers are advised to recheck measurements before committing to any expense. 4. We have not tested any apparatus, equipment, fixtures or services and it is in the buyers interest to check the working condition of any appliances. 5. Where an EPC, or a Home Report (Scotland only) is held for this property, it is available for inspection at the branch by appointment. If you require a printed version of a Home Report, you will need to pay a reasonable production charge reflecting printing and other costs. 6. We are not able to offer an opinion either written or verbal on the content of these reports and this must be obtained from your legal representative. 7. Whilst we take care in preparing these reports, a buyer should ensure that his/her legal representative confirms as soon as possible all matters relating to title including the extent and boundaries of the property and other important matters before exchange of contracts.

Fox & Sons is a trading name of Sequence (UK) Limited which is registered in England and Wales under company number 4268443, Registered Office is Cumbria House, 16-20 Hockliffe Street, Leighton Buzzard, Bedfordshire, LU7 1GN. VAT Registration Number is 500 2481 05.

fox & sons



01323 410911



Eastbourne@fox-and-sons.co.uk



19 Cornfield Road, EASTBOURNE, East Sussex,
BN21 4QD



fox-and-sons.co.uk