



Roach Road, E3

£685,000

A modern three double bedroom, two bathroom apartment that measures in excess of 1,040 Square feet with a private balcony. This property has an open plan living room and kitchen with a newly integrated island. The kitchen has built in appliances and there are floor to ceiling windows throughout this space for extra light. Legacy house has a secure entry system and lift access.

Located in Fish Island village and bordering the canal, this apartment has an abundance of shops, delis and cafes within 200 yards. Hackney wick station is under a quarter of a mile away with Stratford international and Underground just over half a mile walk.

Features

- Three Double Bedrooms
- Two Bathrooms
- Modern
- Secure Development
- 1040+ Square Feet
- Open Plan

Roach Road, London, E3

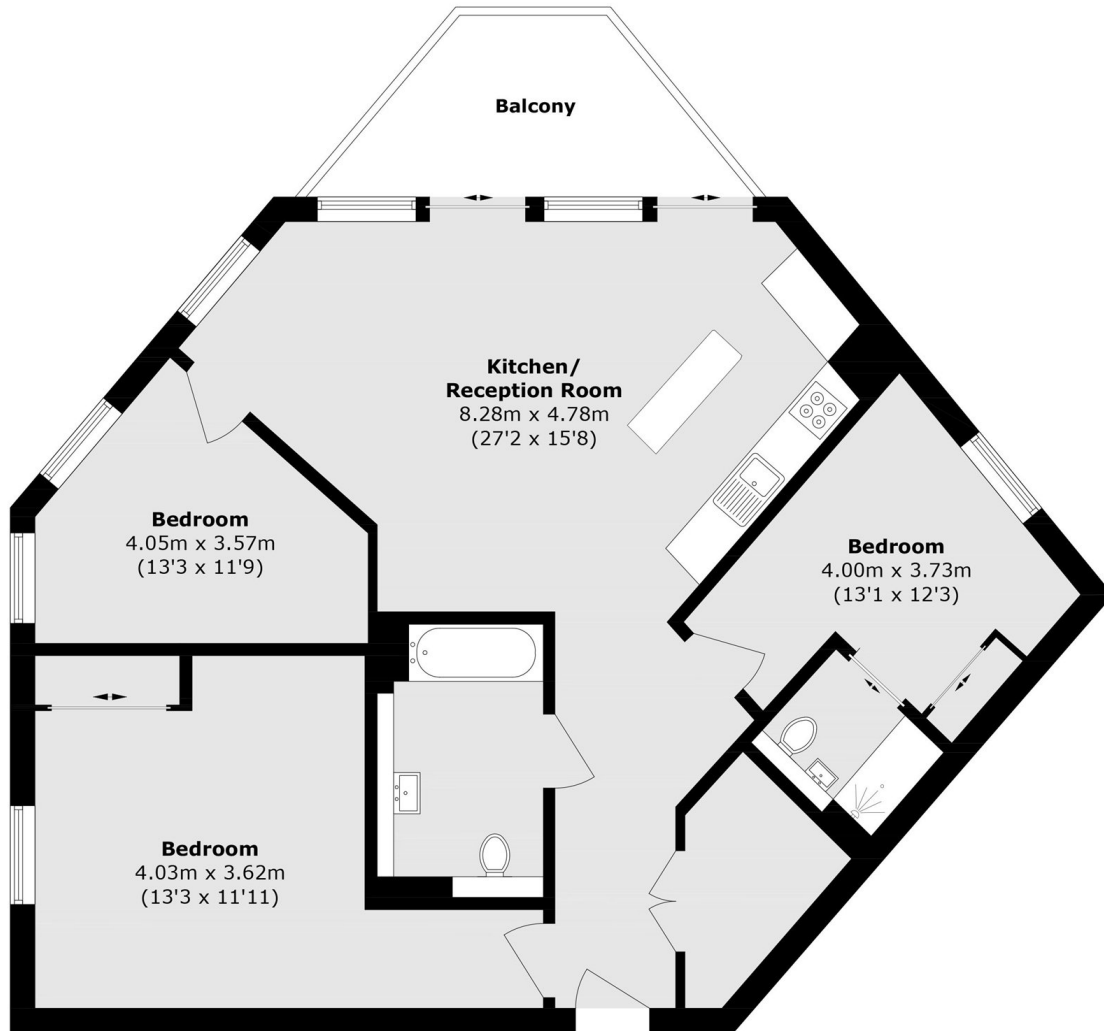

Total area (approx.): 96.7 sq. m (1040.8 sq. ft)

Balcony area (approx.): 8.0 sq. m (86.1 sq. ft)