

Location:

Mill Hill Road is in a peaceful pocket of Acton within a short walk from Gunnersbury Park, Acton Town (District and Piccadilly Line) and South Acton Overground stations, and within easy reach of Chiswick High Road.

Key points:

- One-bedroom
- Split-level flat
- 559 sq.ft / 52 sq.m
- Long lease
- No onward chain

Do Better:

Acton

sales@astonrowe.co.uk

57-59 Churchfield Road,
Acton, London, W3 6AY

020 8992 3600

Aston Rowe

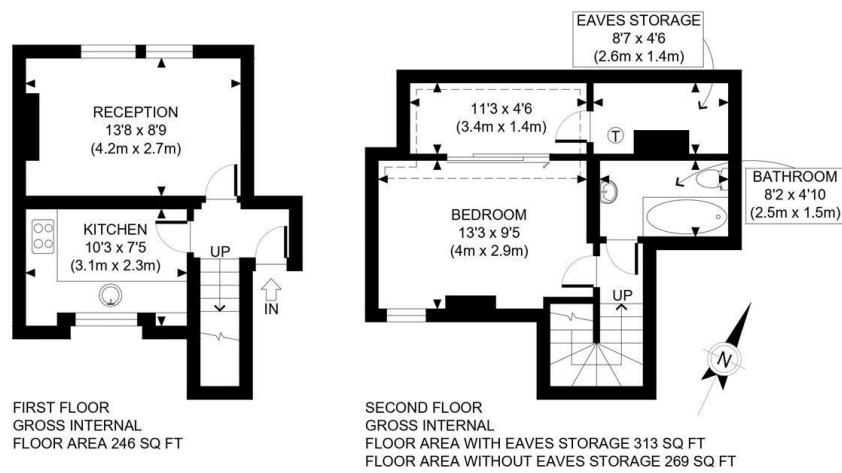

This plan is for illustrative purposes only and should be used as such by any prospective client. Whilst every attempt has been made to ensure the accuracy of the Floor Plan contained here, measurements of the doors, windows, rooms and any other items are approximate and no responsibility is taken for any errors, omissions, or misstatement. The services, systems and appliances shown have not been tested and no guarantee as to the operability or efficiency can be given.

PROPERTY PHOTO PLANS
THE STOP SHOP FOR PROPERTY BUILDING

£350,000

Mill Hill Road, Acton W3 8JF

Energy Efficiency Rating		Environmental Impact (CO ₂) Rating	
Current	Potential	Current	Potential
	74		
51			

England & Wales EU Directive 2002/91/EC

- 1 Reception Rooms
- 1 Bedrooms
- 1 Bathrooms

The current owner says:

The property is in a fantastic location for the local shops, parks, and transport links.

A rare one-bedroom split-level flat located within the popular Mill Hill Conservation area in Acton.

The first floor offers a large front reception room and separate kitchen to the rear with a pleasant outlook onto private gardens. The second and top floor offers a good size bedroom, bathroom and useful eaves storage.

Mill Hill Road is in a peaceful pocket of Acton within a short walk from Gunnersbury Park, Acton Town (District and Piccadilly Line) and South Acton Overground stations, and within easy reach of Chiswick High Road. The property also provides easy access to Acton Main Line (Elizabeth Line) station, the A4, M4 and Heathrow airport.



What's better:

A rare one-bedroom split-level flat located within the popular Mill Hill Conservation area in Acton.

