



New Cross Road, SE14

£400,000

Located in the heart of vibrant New Cross, this beautifully presented two-bedroom upper-floor flat sits within an attractive Victorian conversion.

Inside, you'll find a bright and spacious open-plan L-shaped lounge and kitchen, featuring an exposed brick feature wall that adds character and warmth to the space.

The property offers two well-proportioned bedrooms, perfect for sharers, a couple, or a professional needing a stylish home office. A real highlight is the impressive city views, adding a unique sense of space and character to this charming home.

Perfectly located on New Cross Road, this home is moments from New Cross and Deptford High Street, with pubs, restaurants and cafés including Urban Barista, The Rose and The New Cross House.

Green spaces include Telegraph Hill, Fordham Park and the Thames via Deptford and Twinkle Park (20 minutes), with Blackheath and Greenwich Park around 35 minutes away. London Bridge is about 5 minutes by train, and Shoreditch around 15 minutes.

Features

- Victorian Conversion
- Two Double Bedrooms
- City Views
- Right To Manage
- 381ft From New Cross Station
- Period Features

New Cross Road, London, SE14

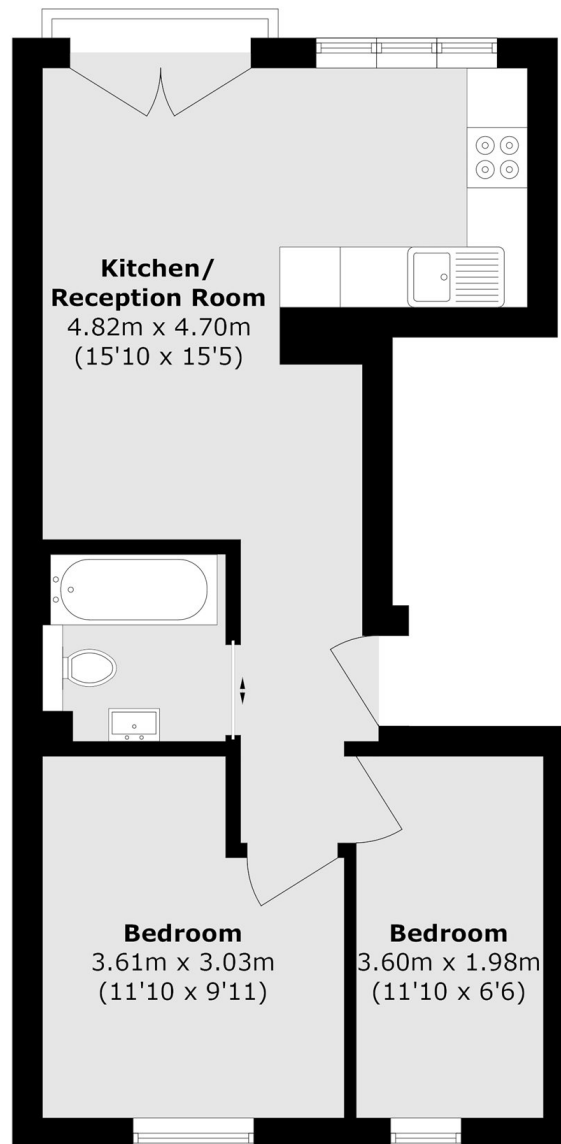

Total area (approx.): 44.1 sq. m (474.6 sq.ft)