

CHESTERTON ROAD





Chesterton Road, W10

A beautifully presented raised ground floor period conversion, meticulously renovated to create a warm and elegant home. The apartment features high ceilings, excellent storage and high quality finishes throughout.

The front facing open plan living space benefits from a large bay window, filling the room with natural light. There is a generous double bedroom with bespoke fitted wardrobes, along with a luxurious shower room featuring a spacious walk in enclosure. Additional storage is thoughtfully integrated within the hallway.

Ideally located on the doorstep of Golborne Road in North Kensington and Notting Hill, with an excellent selection of shops and restaurants including Strakers, Golborne Deli and Arte House. Portobello Road is moments away, along with the wider amenities of Notting Hill and Ladbroke Grove.





Approx. Gross Internal Area
= 48.1sq m / 518 sq ft

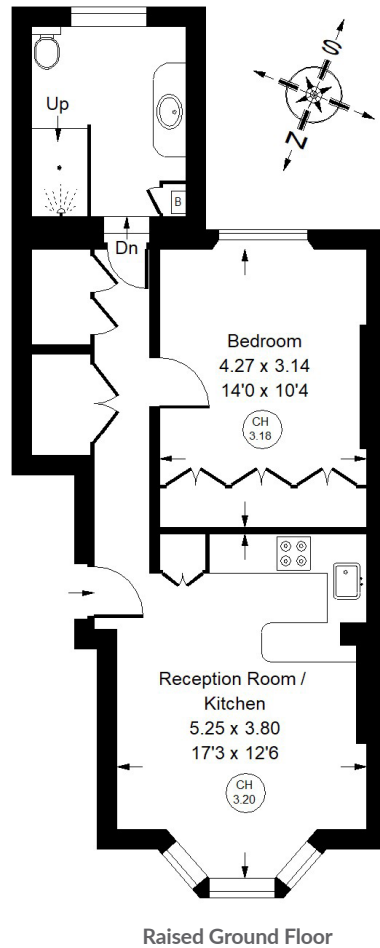

Chesterton Road, W10 - Leasehold

Local Authority - **Royal Borough of Kensington & Chelsea**

- One bedroom
- Meticulously renovated
- Period conversion
- EPC rating: E
- Council tax band: C



Whilst every attempt has been made to ensure the accuracy of the floor plan, measurements are approximate and not to scale. No guarantee is given on the total square footage of the property quoted on the plan. Figures given are for guidance. Plan is for illustration purposes only, not to be used for valuations.