



Ormonds Close  
Bristol BS32 0DY

**Price:**  
**£1,200 PCM**

## Property Features

- End of Terrace House
- One Bedroom
- Private Rear Garden
- Off Street Parking
- Available Immediately
- Recently Refurbished
- Unfurnished
- Must Be Viewed

## Full Description

**LOUNGE**  
13'5" x 11'7"

**KITCHEN**  
11'7" x 7'2"

**LANDING**

**BEDROOM**  
13'5" x 11'7"

**BATHROOM**

**PRIVATE REAR GARDEN**

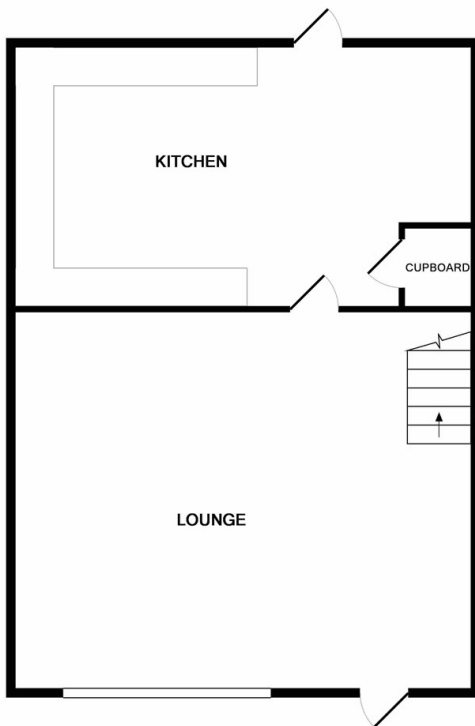

GROUND FLOOR

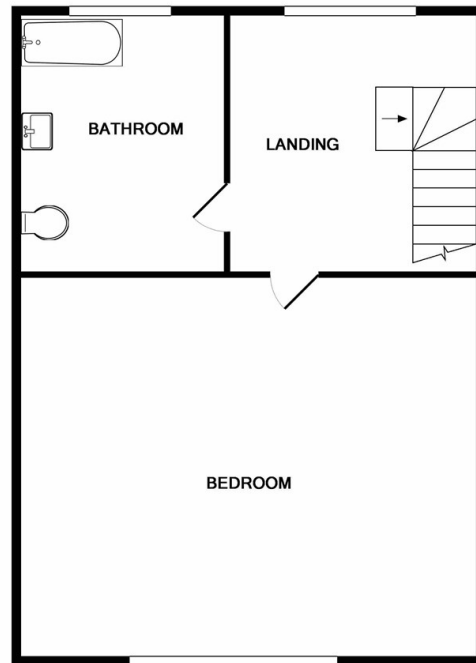

1ST FLOOR

Measurements are approximate. Not to scale. Illustrative purposes only  
Made with Metropix ©2017

4 Flaxpits Lane  
Winterbourne  
Bristol  
BS36 1JX

[www.aj-homes.co.uk](http://www.aj-homes.co.uk)  
[info@aj-homes.co.uk](mailto:info@aj-homes.co.uk)  
01454 252140

Agents Note: Whilst every care has been taken to prepare these sales particulars, they are for guidance purposes only. All measurements are approximate are for general guidance purposes only and whilst every care has been taken to ensure their accuracy, they should not be relied upon and potential buyers are advised to recheck the measurements