

Hospital Road, Arlesey, SG15 6RL

Offers Over £260,000

🛏 2 🚗 1 🚲 2



A spacious two bedroom character cottage with off road parking, a newly paved south facing garden, and excellent room sizes throughout. Beautifully maintained and freshly refreshed, this warm and inviting home is now available chain free as the owner is relocating.

Key Features

- Off road parking to front
- Generous 19' x 12' living dining room
- Smart modern bathroom
- New front windows and Sharps fitted wardrobes to main bedroom
- South facing rear garden
- Kitchen overlooking the garden
- Two excellent double bedrooms
- Walk through video tour

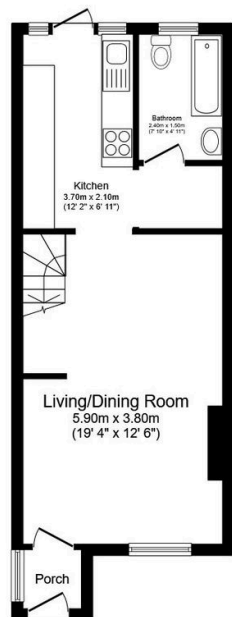

Ground Floor
Floor area 38.2 sq.m. (412 sq.ft.)

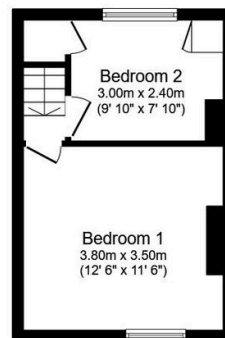

First Floor
Floor area 22.4 sq.m. (241 sq.ft.)

Total floor area: 60.7 sq.m. (653 sq.ft.)

This floor plan is for illustrative purposes only. It is not drawn to scale. Any measurements, floor areas (including any total floor area), openings and orientations are approximate. No details are guaranteed, they cannot be relied upon for any purpose and do not form any part of any agreement. No liability is taken for any error, omission or misstatement. A party must rely upon its own inspection(s). Powered by www.Propertybox.io