



Guide Price
£310,000

Freehold

2x  1x  1x 

**Maidstone Road,
Paddock Wood, Kent,
TN12**

OVER 60?

Secure this property
for up to **59% less!**

Wards
Helping you move forwards



Main features

- Chain free terraced home in the heart of Paddock Wood
- Off street parking and a garage
- Perfect starter house for a first time buyer or Investor
- Close to local amenities & shops
- Walking distance to mainline train station

Accommodation

GROUND FLOOR

Lounge: 18'3 x 12'7 (5.57m x 3.84m)

Kitchen: 12'5 x 6'1 (3.79m x 1.86m)

FIRST FLOOR

Landing

Bedroom 1: 12'5 x 9'8 (3.79m x 2.95m)

Bedroom 2: 12'6 x 6'4 (3.81m x 1.93m)

Bathroom: 9'3 x 6'2 (2.82m x 1.88m)

OUTSIDE

Garage
Rear Garden

Ground Floor

Approx. 30.4 sq. metres (327.6 sq. feet)

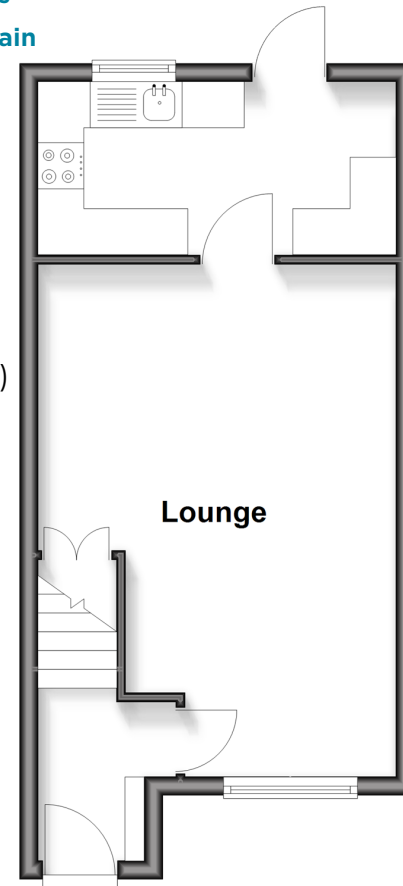

First Floor

Approx. 30.1 sq. metres (323.5 sq. feet)

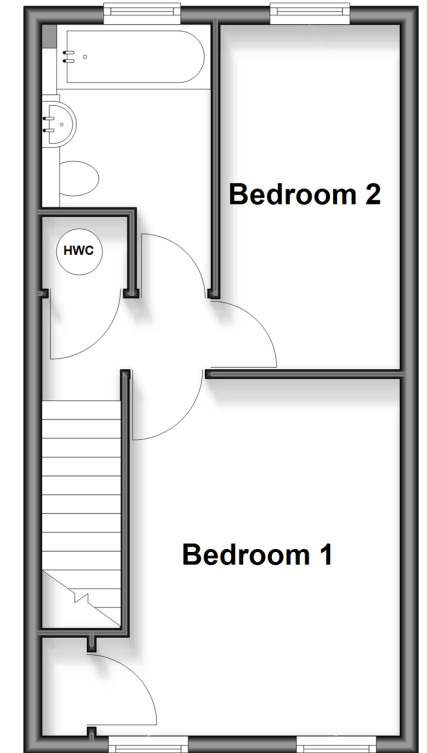

Call Paddock Wood - 01892 836877 ■ wardsokent.co.uk

- Legal advice should be taken to verify fixtures/fittings, planning, alterations and/or lease details
- Appliances & services are untested, dimensions are approximate and floor plans are not to scale
- Through a Homewise Home For Life Plan people aged 60+ can secure this property for up to 59% less, by purchasing a Lifetime Lease



13627533/20260225/LF/ER