



Warren Court Ditton Street

Ilminster, TA19 0FA

£750 Per Month

**MAYFAIR**  
TOWN & COUNTRY

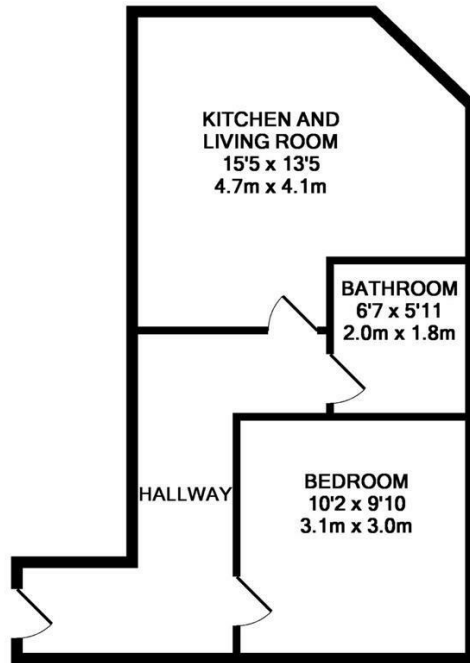

FLAT 10 WARREN COURT DITTON STREET ILMINSTER TA19 0BQ  
TOTAL APPROX. FLOOR AREA 401 SQ.FT. (37.3 SQ.M.)

Whilst every attempt has been made to ensure the accuracy of the floor plan contained here, measurements of doors, windows, rooms and any other items are approximate and no responsibility is taken for any error, omission, or mis-statement. This plan is for illustrative purposes only and should be used as such by any prospective purchaser. The services, systems and appliances shown have not been tested and no guarantee as to their operability or efficiency can be given  
Made with Metropix ©2016

## PROPERTY DESCRIPTION

Very well presented first floor flat situated in a highly convenient location. Accommodation comprises: Open plan kitchen/living room, bathroom with bath and shower over, double bedroom and good size hall with space for a desk. Please check with Ofcom for Broadband and mobile coverage as will depend on package and provider. No pets due to overall head lease.

- Spacious first floor flat
- Open plan kitchen/living room
- Council Tax band A
- Convenient location
- Large hall
- Deposit £865.00

Deposit: £865  
Furnishing: Unfurnished

### Local Authority

South Somerset Council Tax Band: A

Tenure:

EPC Rating: C

Energy Efficiency Rating		Current	Potential
Very energy efficient - lower running costs			
(92 plus) <b>A</b>			
(81-91) <b>B</b>			
(69-80) <b>C</b>		77	78
(55-68) <b>D</b>			
(39-54) <b>E</b>			
(21-38) <b>F</b>			
(1-20) <b>G</b>			
Not energy efficient - higher running costs			
England & Wales		EU Directive 2002/91/EC	



TO ARRANGE A VIEWING OR FOR FURTHER INFORMATION ON THIS PROPERTY PLEASE CONTACT OUR SALES TEAM

**01460 74200**

crewkerne@mayfairproperties.net



We would like to inform prospective purchasers that these sales particulars have been prepared as a general guide only. If there are any important matters likely to affect your decision to buy, please contact us before viewing the property.

1. Survey - A detailed survey has not been carried out, nor the services, appliances and fittings tested.
2. Floorplans All measurements walls, doors, windows, fittings and appliances, their sizes and locations are shown conventionally and are approximate and cannot be regarded as being representative either by the seller or his agent. Room sizes should not be relied upon for furnishing purposes and are approximate.
3. Mayfair Town & Country may make the following referrals and in exchange receive an introduction fee: Star Legal up to £120 inc VAT, Simply Conveyancing up to £240 inc VAT, HD Financial Ltd - introduction fee of up to £240 inc VAT

