

Approx Gross Internal Area
104 sq m / 1121 sq ft

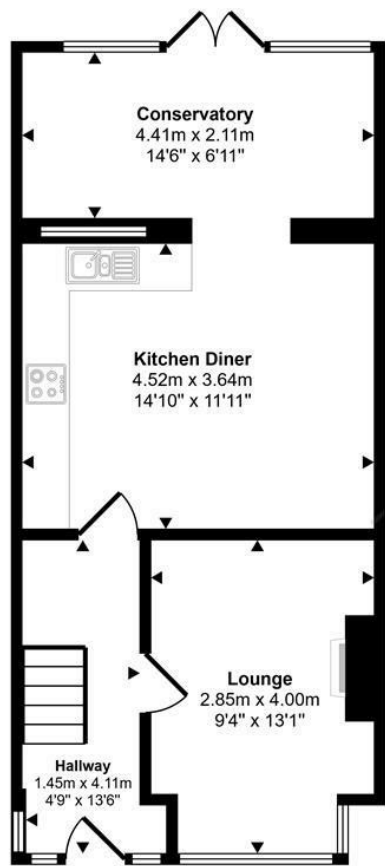

Ground Floor
Approx 45 sq m / 486 sq ft

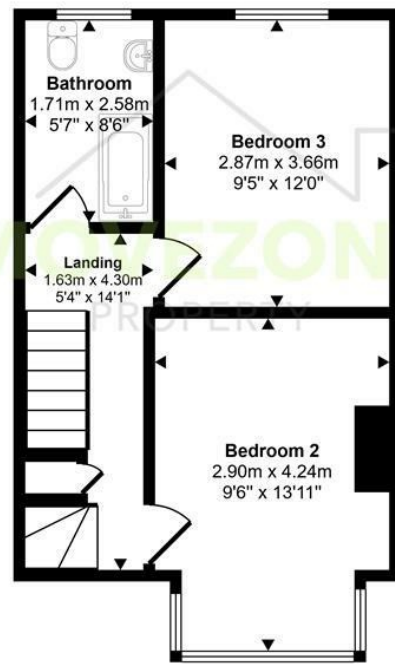

First Floor
Approx 35 sq m / 376 sq ft

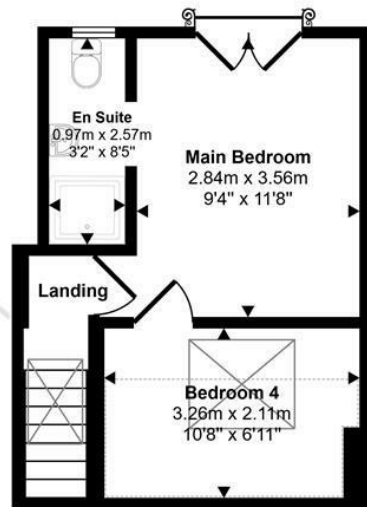

Second Floor
Approx 24 sq m / 259 sq ft

Denotes head height below 1.5m

This floorplan is only for illustrative purposes and is not to scale. Measurements of rooms, doors, windows, and any items are approximate and no responsibility is taken for any error, omission or mis-statement. Icons of items such as bathroom suites are representations only and may not look like the real items. Made with Made Snappy 360.



Directions

Contact

223 Southborough Lane
Bromley
Kent
BR2 8AT

E: info@movezone.co.uk

T: 0208 3139075

<https://www.movezone.co.uk>



3 Bed
House
located in Bromley



24 Haywood
Road
Bromley
Kent
BR2 0DQ

£2,250 PCM



An excellent opportunity to rent this stunning three double bedroom unfurnished house. Ideally located close to Bickley and Bromley South stations, as well as local amenities, this exceptional home is sure to let quickly, early viewing is highly recommended.

The ground floor welcomes you with a well presented lounge, leading through to an open-plan dining area and a modern fitted kitchen, creating a bright and sociable living space. This flows into a conservatory with doors opening out to a private rear garden, featuring both patio and lawn areas.

The first floor comprises two generously sized double bedrooms and a modern family bathroom with bath and shower attachment. The top floor is dedicated to a master bedroom, complete with an en-suite shower room, separate dressing area, and a faux balcony. Further benefits include gas central heating and double glazing throughout.

Situated in a highly sought-after location in Chatterton Village, the property is within easy reach of Bromley town centre, offering a wide range of shops, restaurants, cafés and leisure facilities. Bickley and Bromley South stations provide excellent transport links into Central London, making this an ideal home for commuters and families alike.

