



**24 Lutterburn Street  
Ugborough  
Ivybridge  
PL21 0NG  
Guide Price £325,000**

  
MILLINGTON TUNNICLIFF

24 Lutterburn Street  
Ugborough  
Ivybridge  
PL21 0NG



FLOORPLAN

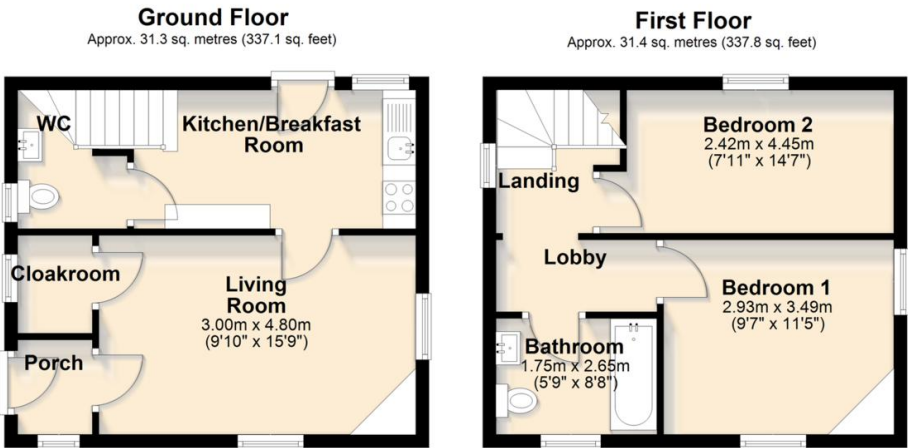

Total area: approx. 62.7 sq. metres (674.9 sq. feet)

Guide Price £325,000

SUMMARY

A charming 2 double bedroom detached cottage set within this hugely popular South Hams village. The house has an entrance porch, living room, cloakroom, kitchen/breakfast room and separate WC on the ground floor, together with the 2 double bedrooms and bathroom/WC on the upper floor. The house has gas central heating. Externally there is a super southerly facing mainly level lawned garden and pedestrian door to the single garage. The house does require some modernisation and is being sold with no chain. EPC E 52.

2 Double Bedroom Detached Cottage | EPC E 52 | First Floor Bathroom/WC | Popular South Hams Village Location | Gas Central Heating | Single Garage | Super Southerly Facing Rear Garden | Cloakroom | Spacious Living Room | No Chain

CONTACT  
19 Fore Street, Ivybridge,  
Devon, PL21 9AB

EMAIL  
info@millingtontunnicliff.co.uk

TEL  
01752 896020

www.millingtontunnicliff.co.uk