



Milden Road, Ipswich, IP2 0LB

welcome to

Milden Road, Ipswich

This semi-detached home is in need of light refurbishment and benefits from three good-size bedrooms, a spacious lounge/diner, a ground floor cloakroom, a 1st floor bathroom, a sunny, South-West facing rear garden and off street parking. NO ONWARD CHAIN!!

Entrance Hall

Parquet effect flooring and doors to the cloakroom and lounge.

Cloakroom

Low level WC, wash hand basin, one radiator, Parquet effect flooring and window to the side.

Lounge/Diner

Spacious, open plan room with a large window to the front, carpet flooring, two radiators, TV point and a staircase to the first floor.

Kitchen/Breakfast Room

Open plan room with window to the rear, patio doors to the garden, tiled flooring, an understairs storage cupboard, eye and base level units in white with marble effect worktop surfaces, a white sink plus drainer and chrome mixer tap, an integrated oven with electric hob and extractor hood, tiled splashback, a wall mounted, gas fired boiler and space for a washing machine and fridge/freezer.

First Floor Landing

Loft hatch, an airing cupboard and carpet flooring.

Master Bedroom

Window to the front, carpet flooring and one radiator.

Bedroom Two

Window to the rear, carpet flooring, one radiator and wall papered walls.

Bedroom Three

Window to the rear, carpet flooring and one radiator.

Bathroom

Window to the rear, low level WC, pedestal wash hand basin, double shower with glass enclosure, part tiled walls, white heated towel rail and shaver point.

Outside: Front Garden

A small grassed area, shrubs, a patio, a hard standing driveway and a side gate leading to the rear garden.

Rear Garden

South-West facing, completely private, fully enclosed rear garden, with a rear gate to the park and woodland, a side access gate, a door to the garage, a patio seating area, a path leading to the rear of the garden, an additional patio seating area, hedging and a grassed area.

Garage

An up and over door, a door to the garden, power, light and storage in the rafters.

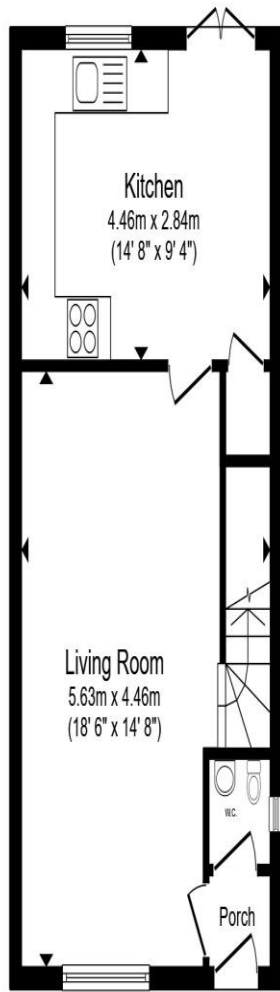

Ground Floor

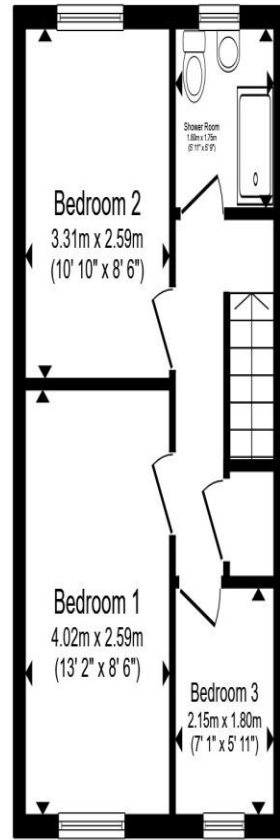

First Floor

Total floor area 70.6 m² (760 sq.ft.) approx

This floor plan is for illustrative purposes only. It is not drawn to scale. Any measurements, floor areas (including any total floor area), openings and orientation are approximate. No details are guaranteed, they cannot be relied upon for any purpose and they do not form part of any agreement. No liability is taken for any error, omission or misstatement. A party must rely upon its own inspection(s). Powered by www.propertybox.io



welcome to
Milden Road,
Ipswich

- No onward chain
- Light refurbishment project
- Three good-size bedrooms
- Ground floor cloakroom & 1st floor bathroom
- South-West facing rear garden

Tenure: Freehold EPC Rating: D
Council Tax Band: B

£225,000



view this property online williamhbrown.co.uk/Property/IPS121647



Property Ref:
IPS121647 - 0002

1. MONEY LAUNDERING REGULATIONS Intending purchasers will be asked to produce identification documentation at a later stage and we would ask for your co-operation in order that there is no delay in agreeing the sale. 2. These particulars do not constitute part or all of an offer or contract. 3. The measurements indicated are supplied for guidance only and as such must be considered incorrect. Potential buyers are advised to recheck measurements before committing to any expense. 4. We have not tested any apparatus, equipment, fixtures or services and it is in the buyers interest to check the working condition of any appliances. 5. Where an EPC, or a Home Report (Scotland only) is held for this property, it is available for inspection at the branch by appointment. If you require a printed version of a Home Report, you will need to pay a reasonable production charge reflecting printing and other costs. 6. We are not able to offer an opinion either written or verbal on the content of these reports and this must be obtained from your legal representative. 7. Whilst we take care in preparing these reports, a buyer should ensure that his/her legal representative confirms as soon as possible all matters relating to title including the extent and boundaries of the property and other important matters before exchange of contracts.

William H Brown is a trading name of Sequence (UK) Limited which is registered in England and Wales under company number 4268443, Registered Office is Cumbria House, 16-20 Hockliffe Street, Leighton Buzzard, Bedfordshire, LU7 1GN. VAT Registration Number is 500 2481 05.



william h brown



01473 226101



ipswich@williamhbrown.co.uk



16-18 Wolsey House, Princes Street, IPSWICH,
Suffolk, IP1 1QT



williamhbrown.co.uk