

Estate Agents



Auctioneers



Foxholes Road, Southbourne, Bournemouth, BH6 3AT Guide Price £120,000 - Share of Freehold

Studio Apartment | Second/Top Floor | Hallway | 12' x 22' Studio Room | Bathroom
Large Storage Room | Off Road Parking | No Onward Chain

Foxholes Road, Southbourne, Bournemouth, BH6 3AT

Guide Price £120,000 - Share of Freehold

A well-presented second-floor studio apartment, ideally located in the popular area of Southbourne, within a short walk of Southbourne Beach. The property is perfectly positioned between Southbourne and Christchurch, with a range of local shops, cafés and restaurants at Southbourne Crossroads and Tuckton nearby.

The accommodation comprises a communal entrance with stairs leading to the second floor. A private hallway provides access to a bright and spacious 22' x 12' studio room with fitted kitchen and attractive far-reaching views towards St Catherine's Hill. There is also the added benefit of a large storage room. The bathroom is accessed via the hallway and features a bath with shower over, wash hand basin and WC, finished with modern tiling.

Externally, the property is set within well-maintained communal grounds and benefits from one allocated off-road parking space.

No Onward Chain!

Tenure: Share of Freehold – 974 years remaining

Service Charge: £1,842 per annum

Council Tax Banding: A

EPC Rating: 47 | E

SECOND FLOOR

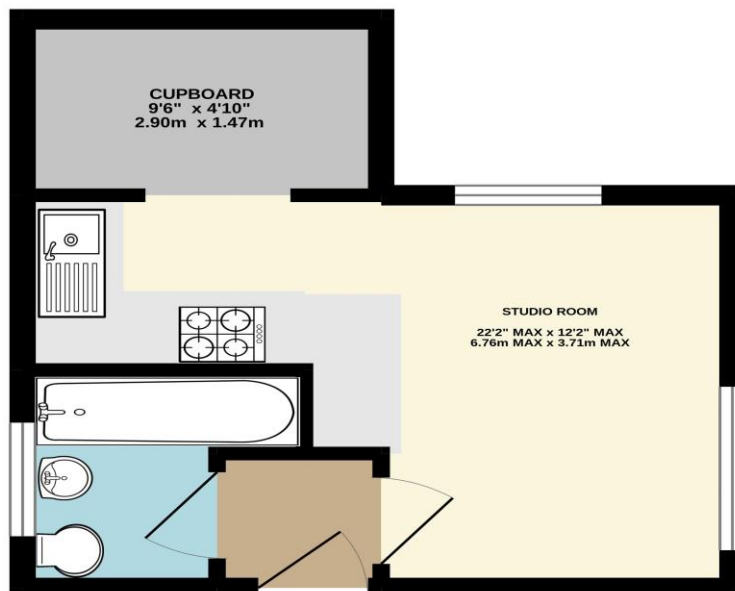

Whilst every attempt has been made to ensure the accuracy of the floorplan contained here, measurements of doors, windows, rooms and any other items are approximate and no responsibility is taken for any error, omission or mis-statement. This plan is for illustrative purposes only and should be used as such by any prospective purchaser. The services, systems and appliances shown have not been tested and no guarantee as to their operability or efficiency can be given.
Made with Metropix ©2022

See all our properties at
OnTheMarket.com

These particulars, whilst believed to be accurate are set out as a general outline only for guidance and do not constitute any part of an offer or contract. Intending purchasers should not rely on them as statements of representation of fact, but must satisfy themselves by inspection or otherwise as to their accuracy. We have not carried out a detailed survey nor tested the services, appliances and specific fittings. Room sizes should not be relied upon for carpets and furnishings. The measurements given are approximate. No person in this firm's employment has the authority to make or give any representation or warranty in respect of the property.