



Trafalgar Street

Gillingham | ME7 4RH



REAL ESTATE

ESTATE AGENCY · REDEFINED

Trafalgar Street , Gillingham, ME7 4RH

Situated within a secure gated development, this well-presented one-bedroom bungalow is conveniently located close to Gillingham town centre and Medway Hospital. Offered with no onward chain, the property is an ideal purchase for first-time buyers, downsizers, or investors.

The accommodation comprises a bright living room with a modern fitted kitchen, a spacious double bedroom, and a separate shower room. Externally, the property benefits from a low-maintenance front garden and an allocated parking space for one vehicle.

Early viewing is highly recommended to appreciate the convenience and appeal of this charming bungalow.

Offers Over £220,000

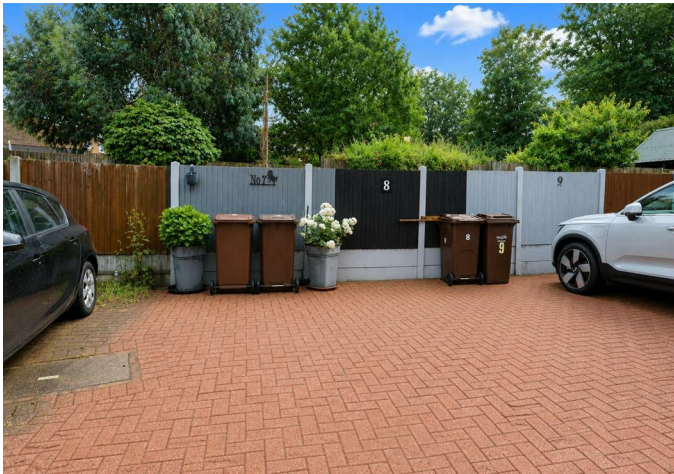

Entrance Hall

Living Room

13'3 x 9'8 (4.04m x 2.95m)

Kitchen

7'11 x 5'10 (2.41m x 1.78m)

Shower Room

6'6 x 6'2 (1.98m x 1.88m)

Bedroom

13'3 x 9'0 (4.04m x 2.74m)



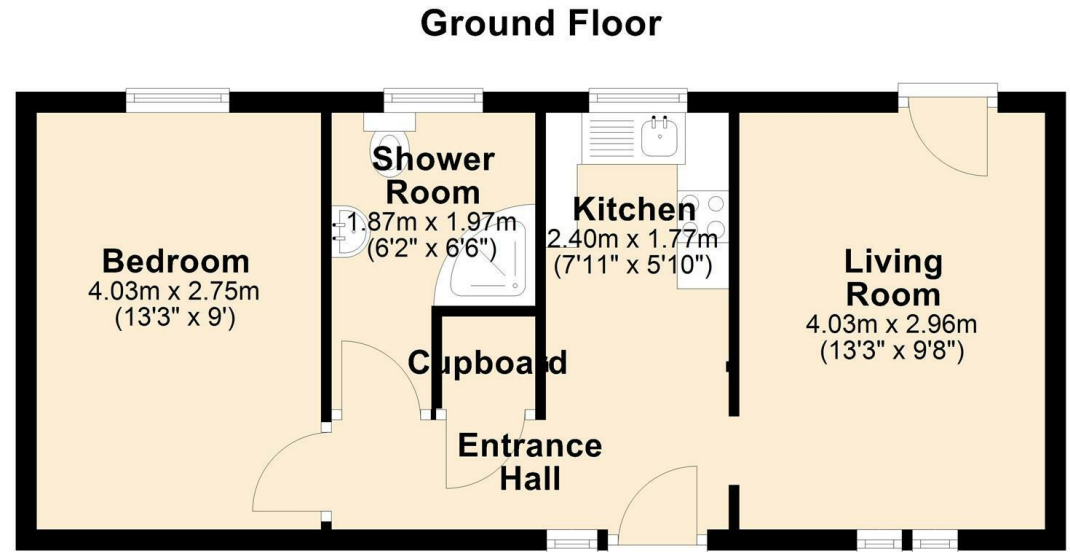
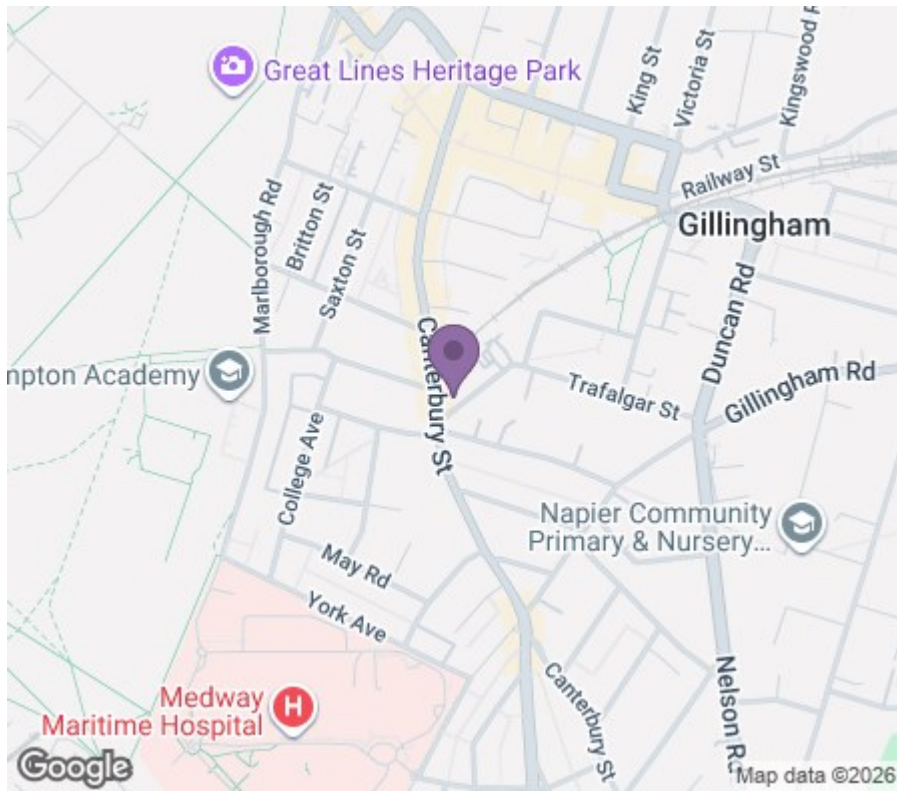

18 - 20 High Street
 Gillingham
 Kent
 ME7 1BB
01634 570057

www.crr realestate.co.uk
twitter.com/CRRealEstateUK
facebook.com/CRRealEstateUK



Energy Efficiency Rating		Current	Potential
Very energy efficient - lower running costs			
(92 plus) A			
(81-91) B			
(69-80) C			
(55-68) D		60	69
(39-54) E			
(21-38) F			
(1-20) G			
Not energy efficient - higher running costs			
England & Wales		EU Directive 2002/91/EC	

Environmental Impact (CO ₂) Rating		Current	Potential
Very environmentally friendly - lower CO ₂ emissions			
(92 plus) A			
(81-91) B			
(69-80) C			
(55-68) D			
(39-54) E			
(21-38) F			
(1-20) G			
Not environmentally friendly - higher CO ₂ emissions			
England & Wales		EU Directive 2002/91/EC	

CR Real Estate endeavour to maintain accurate depictions of properties in Virtual Tours, Floor Plans and descriptions, however, these are intended only as a guide and purchasers must satisfy themselves by personal inspection.