

*To arrange a viewing contact us  
today on 01268 777400*

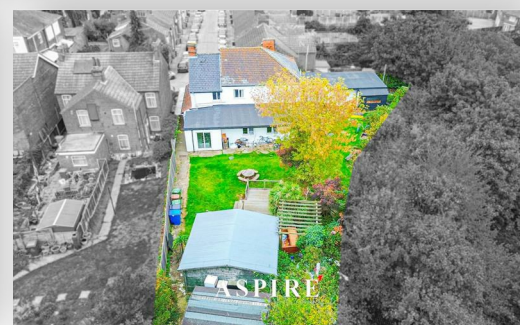
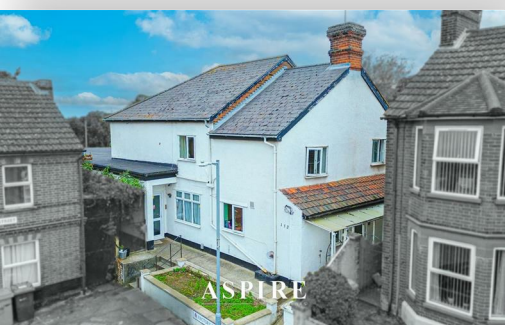
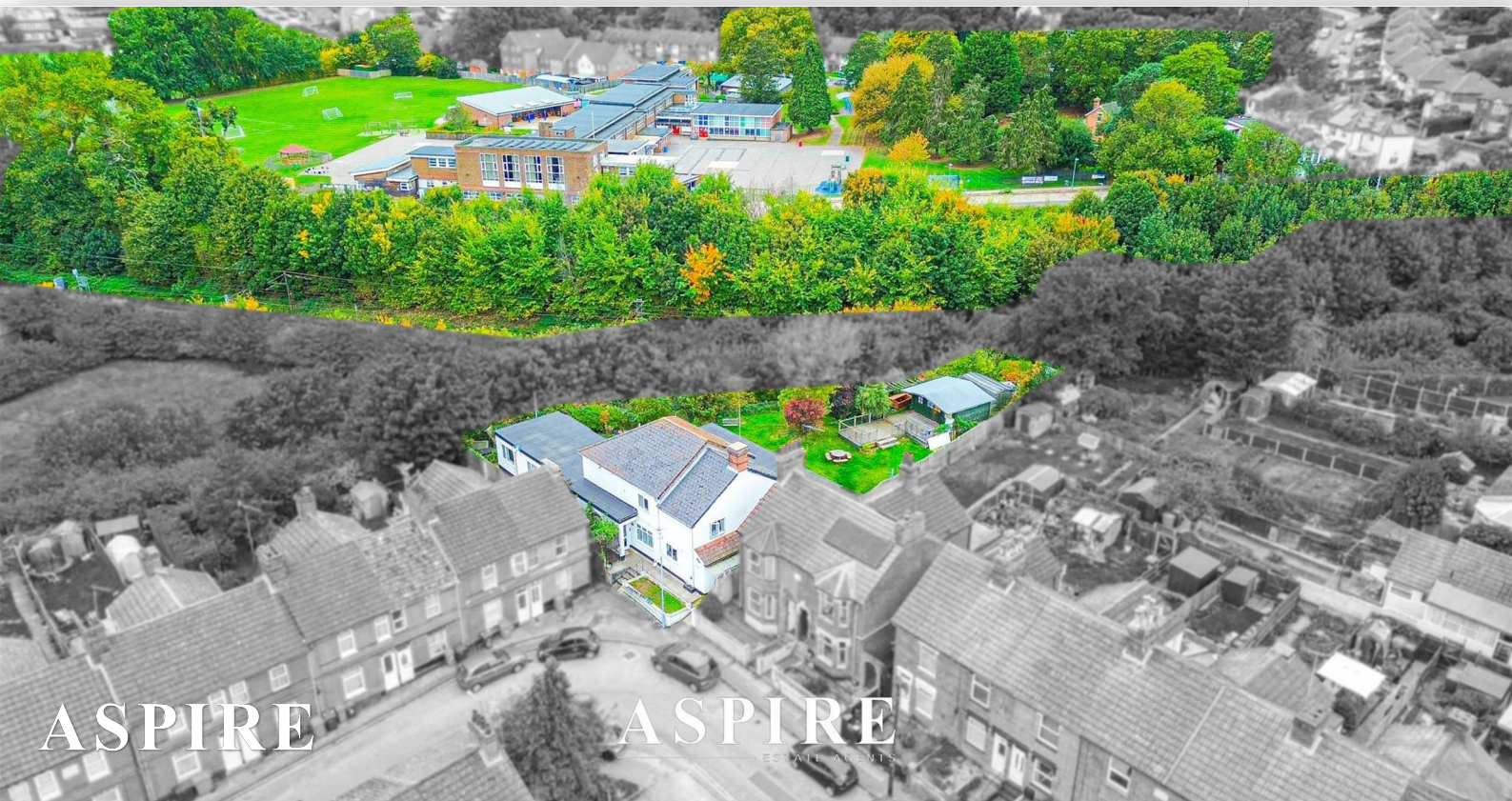

## **Rectory Road, Ipswich Guide price £750,000**

Aspire Estate Agents are delighted to present this outstanding high-yield investment property. Formerly operating as the Beautiful White House Hotel, this fully licensed 10-bedroom HMO currently generates £7,200 per month. Included in the sale is a separately accessed 2-bedroom flat, perfect for additional rental income or on-site management.

Current Rental Income: £7,200 per month  
Potential Rental Income: Up to £12,000 per month

Investment Potential:

Current rental income: £7,200/month

Projected income after potential extension:  
£12,000+/month

Turnkey investment opportunity with strong future  
capital growth potential

The vendor is relocating overseas and is highly  
motivated to secure a serious buyer. All reasonable  
offers will be considered for a fast and smooth  
transaction.

Contact Aspire Estate Agents today to arrange a viewing  
and explore this exceptional investment opportunity.



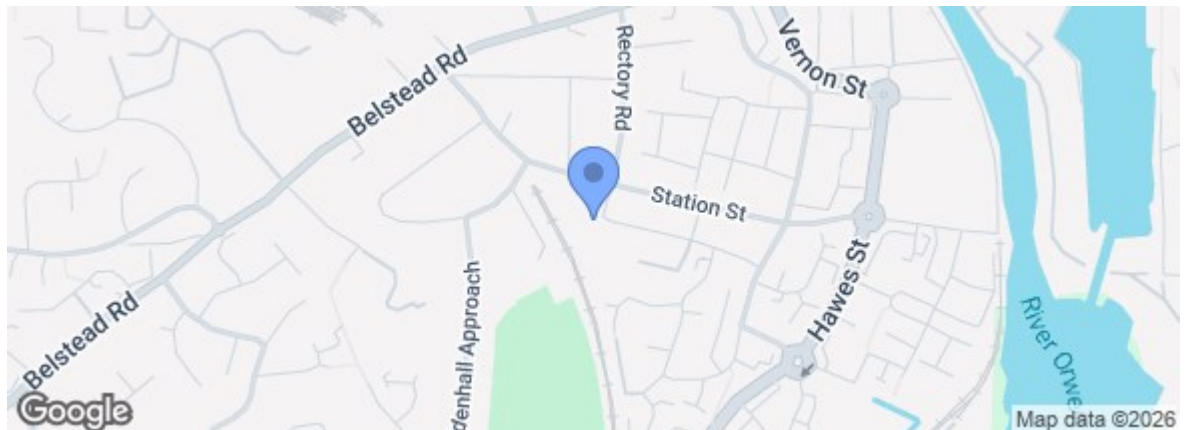
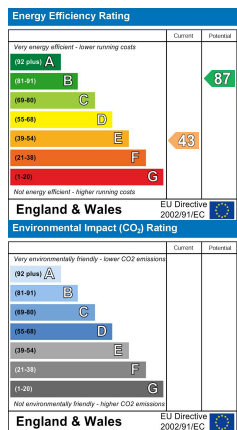
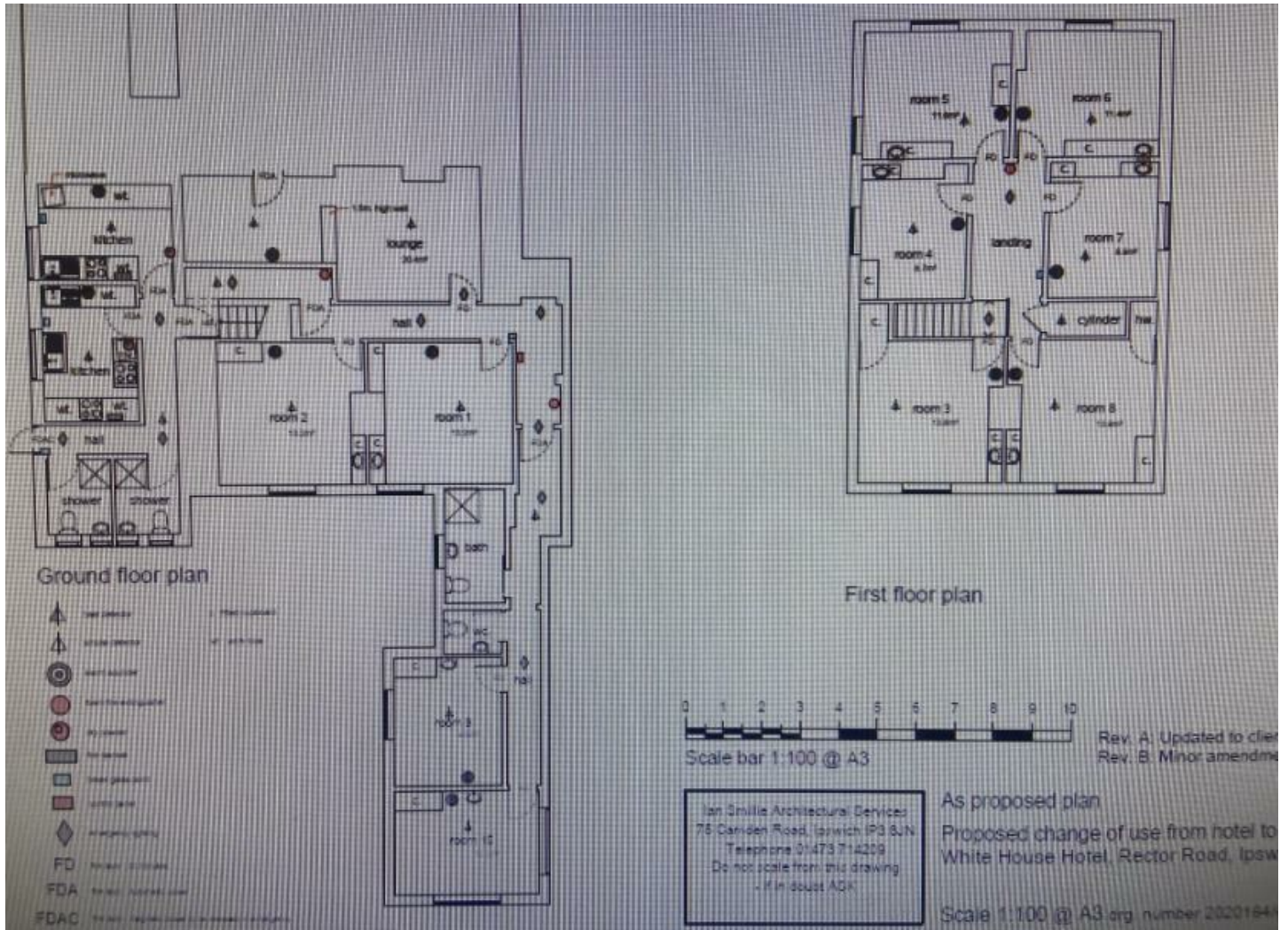

**rightmove.co.uk**  
The UK's number one property website

**Zoopla.co.uk**

Under the Property Misdescriptions Act 1991 we make every effort to ensure our sales details are accurate but they are a general outline and do not constitute any part of an offer or contract. Any services, equipment and fittings have not been tested and no warranty can be given as to their condition. We strongly recommend that all the information provided be verified by your advisors and in particular, measurements required for a specific purpose such as fitted furniture or carpets. Please tell us if you have any problems and members of our branches will help either over the phone or in person. A copy of our complaints procedure is available on request. The details are issued on the strict understanding that any negotiations in respect of the property named herein are conducted through Aspire Estate Agents.