

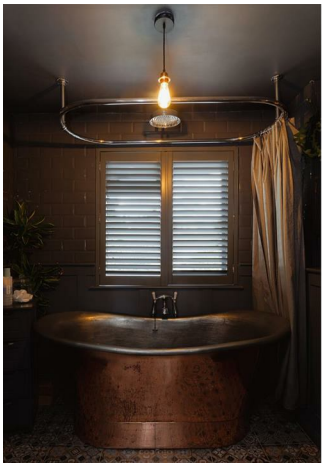

Castle Drive, Reigate

Guide Price £450,000 - £475,000





Finished with real attention to detail, this home offers a fresh, modern feel with a layout that works beautifully for everyday living and entertaining alike





Guide Price £450,000 - £475,000

This beautifully refurbished three-bedroom family home has been carefully upgraded throughout, offering a taste of sleek, modern finishes, ready for its new owners to move straight into.

The entrance opens into a light and inviting sitting room, where a Crittall style window forms an eye-catching focal point while drawing in plenty of natural light. To the rear, the kitchen and dining space has been well planned, centred around a sociable island with warm wooden worktops, paired with stylish cabinetry, integrated appliances and feature lighting. The open plan layout makes it an ideal setting for everyday family life as well as entertaining.

Upstairs, there are three well-proportioned bedrooms, including two doubles and a single that works equally well as a bedroom or a dedicated home office. The main bedroom includes fitted wardrobes, while the additional rooms provide flexibility for family or guests. The bathroom stands out as a carefully curated space, with a freestanding copper bath at its centre, traditional style fittings and a rich colour scheme that creates a sumptuous atmosphere.

Outside, the garden has been arranged to offer a variety of areas to enjoy. Bifolding doors open onto a patio and decked seating area, ideal for outdoor dining and relaxing. A bespoke garden cabin adds further appeal and is currently used as a gym along with a separate workspace.

This home also benefits from solar panels, offering energy efficiency and lower running costs.



Need to know

- Beautifully presented three bedroom end of terrace home
- Bright and spacious living room featuring paneling and a Crittall style window
- Open plan kitchen diner with bifolding doors to the garden
- Stylish family bathroom with a copper roll top bath and downstairs wc
- Three well-sized bedrooms with fitted wardrobes in the main bedroom
- Landscaped rear garden with raised deck, patio and set up for a Jacuzzi
- Bespoke garden cabin hosting a gym and home office
- Solar panels with battery storage system
- Close to local shops and Reigate School
- EPC rating - B

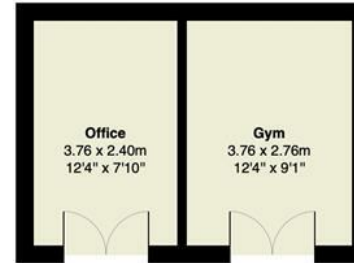

Ground Floor

First Floor

Castle Drive, Reigate

Total Area: 84.3 m² ... 908 ft² (excluding gym, office)

FOR ILLUSTRATIVE PURPOSES ONLY.

Whilst every attempt has been made to ensure the accuracy of the floor plan shown, all measurements, positioning, fixtures, features, fittings and any other data shown are an approximate interpretation for illustrative purposes only and are not to scale.

No responsibility is taken for any error, omission, miss-statement or use of data shown.

The above statement applies to both 'Still Moving London LTD' and the Company or individual displaying this floor plan.

Unauthorised reproduction prohibited.

Â© Still Moving London LTD (www.stillmoving.london)



Interested?

reigate@ralphjames.co.uk
01737 333677

ralphjames.co.uk