



Property Description

A well-presented two-bedroom ground floor maisonette located on Desborough Avenue in High Wycombe, offering modern living throughout and ideal for tenants seeking comfort and convenience.

The property comprises two generously sized double bedrooms, a bright and spacious living area, and a modern fitted kitchen. The bathroom is finished to a good standard, and the home further benefits from gas central heating, ensuring warmth and efficiency all year round.

Externally, the property offers access to a shared driveway providing off-road parking, along with a shared garden, perfect for enjoying outdoor space.

Desborough Avenue is conveniently positioned within easy reach of High Wycombe town centre, which offers a wide range of shops, restaurants, and leisure facilities. The area is also well-connected, with High Wycombe train station providing direct services to London Marylebone, making it ideal for commuters. Local schools, parks, and everyday amenities are all close by, adding to the property's appeal.

COUNCIL TAX B

EPC RATING C

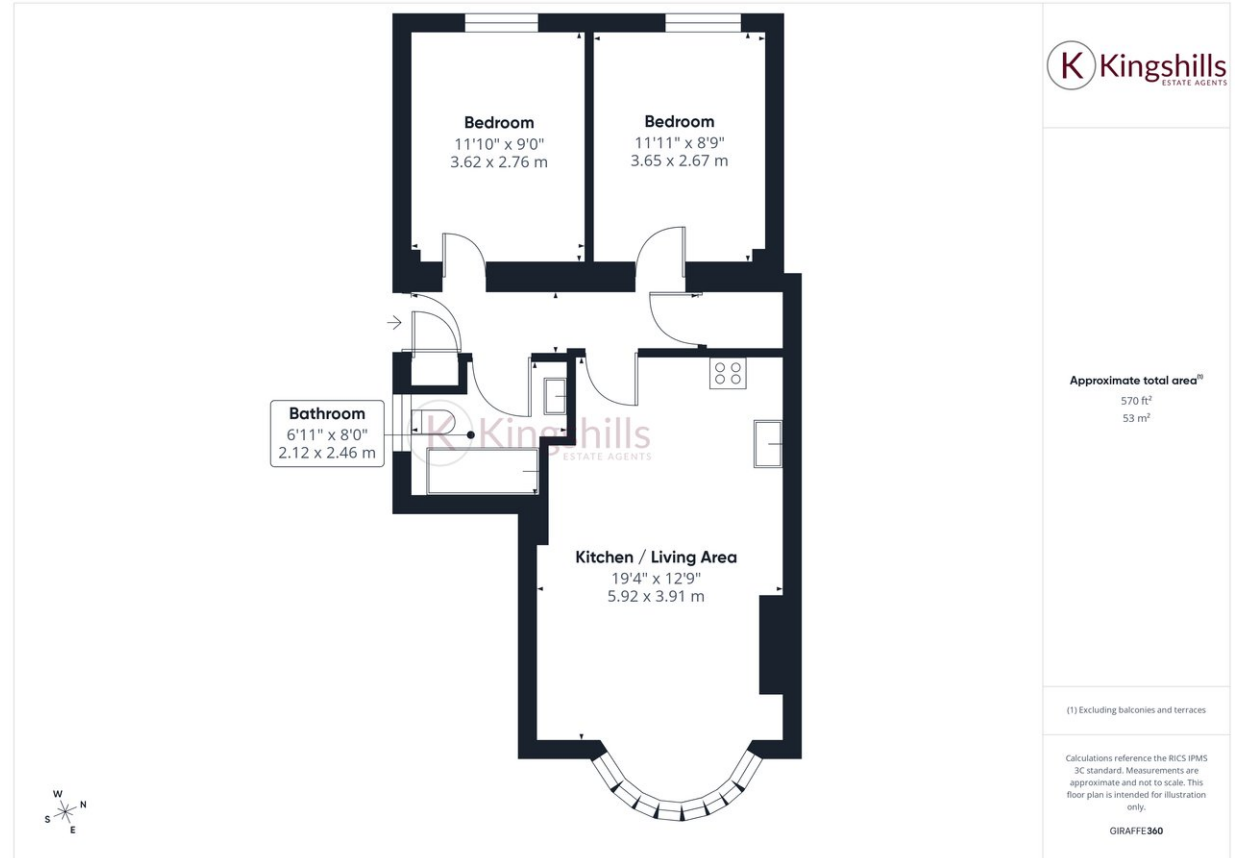

Kingshills Estate Agents
C1C Comet Studios
Amersham
Buckinghamshire
HP7 0PX

01494 939868
hello@kingshills.co.uk
kingshills.co.uk

Agents Note: Whilst every care has been taken to prepare these particulars, they are for guidance purposes only. All measurements are for general guidance purposes only and whilst every care has been taken to ensure accuracy, they should not be relied upon and potential buyers/tenants are advised to recheck the measurements