



Wharncliffe Mews, SW4

£2,250 Per week

A ground floor apartment with large south west facing garden. Accommodation includes a spacious open plan reception room, integrated modern kitchen, double bedroom with storage space and a contemporary bathroom.

Wharncliffe Mews is located just off Clarence Avenue, less than half a mile from the popular Abbeville Road with its many restaurants, shops and bars as well as a mile away from Clapham South underground station.

Features

- Modern Apartment
- Open Plan Reception
- Double Bedroom
- South West Garden
- Wooden Floors
- Local Amenities

Wharncliffe Mews, London, SW4

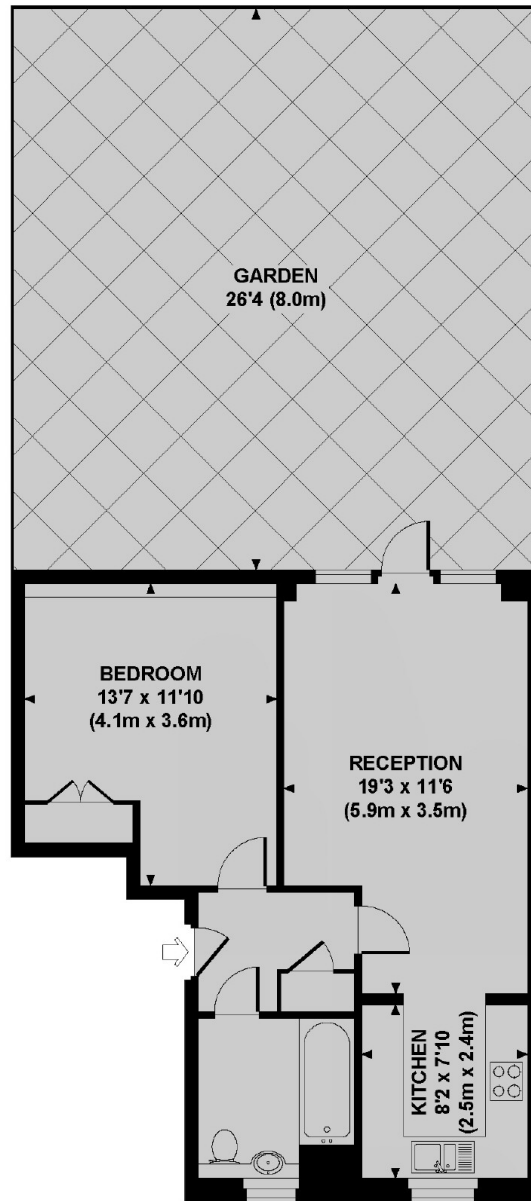

GROUND FLOOR

WHARNCLIFFE MEWS, SW12

Approx. gross internal area
533 Sq Ft. / 49.6 Sq M.