



Drayton Park, N5

£375,000

A well-presented one bedroom top floor flat ideally located close to Highbury Corner and Highbury Fields. The flat benefits from one double bedroom, a bright and spacious open-plan kitchen/ reception room and a three piece bathroom.

Located with convenient transport links, Arsenal (Piccadilly line), Holloway Road (Piccadilly line) and Drayton Park (into Moorgate). Highbury and Islington Station (Victoria Line and Overground) and the high street shops and restaurants on Upper Street are located just across the green open space of Highbury Fields.

Features

- Top Floor
- Period Conversion
- One Bedroom
- Open Plan
- Chain Free

Drayton Park, London, N5

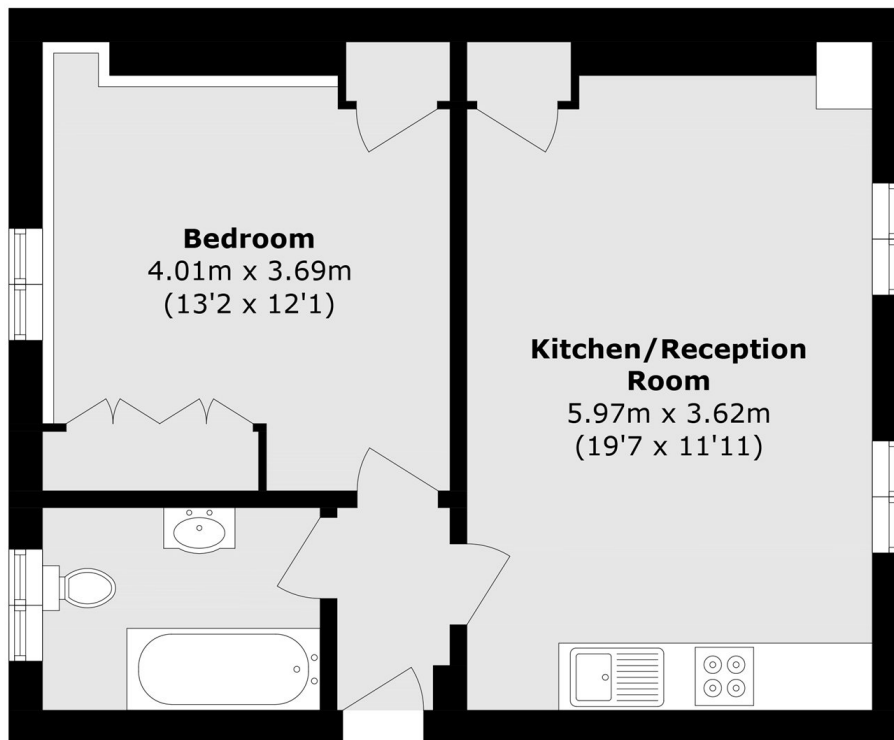

Total area (approx.): 44.2 sq. m (475.7 sq. ft)