

Location

Location Map

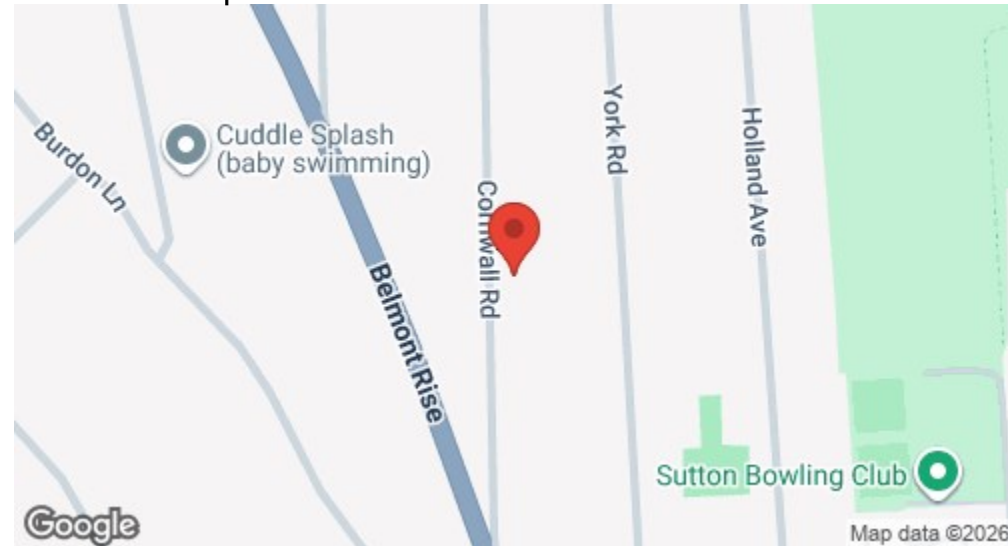

EPC Graph

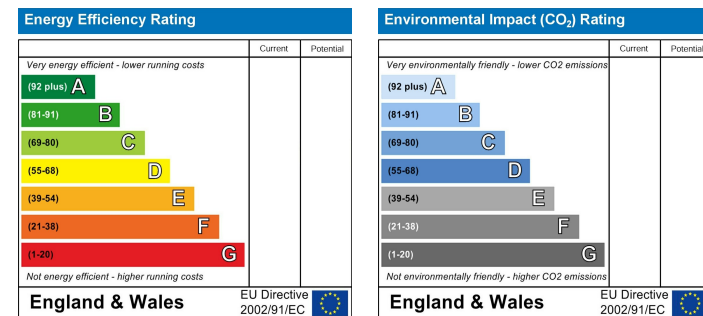

Important Note

Centro Residential Sales and Lettings limited have not tested any services, heating system, electrical system, appliances, fixtures and fittings, that may be included in this property and would advise interested parties to satisfy themselves as to their condition or investigating the presence of any deleterious materials.

Viewing: Strictly by appointment through:

CENTRO RESIDENTIAL SALES AND LETTINGS LIMITED

Tel: 020 8401 5000

E-mail: residential@centro.plc.uk

See a selection of our properties at www.centro.plc.uk

£1,250 Per Month - 20th June 2026

Cornwall Road, Sutton, SM2 6DU



Description

- One bedroom Annex
- Private side entrance
- Modern kitchen with built-in appliances
- Separate shower room
- Separate lounge
- Free on-street parking
- Suitable for a single occupant or couple.
- EPC Rating TBC
- Council Tax - £75 per month

Features

- Gas Central Heating
- Double Glazing
- Storage

What you need to know

- Term: 12 months
- Rent: £1250pcm exclusive of bills
- Security deposit: £1442
- Council Tax Band - £75pcm
- Energy Rating: TBC

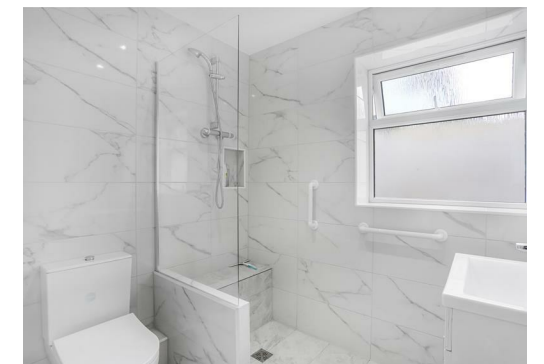

Floor Plan

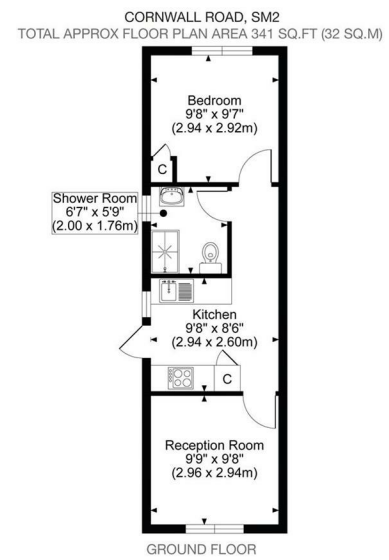

All measurements, walls, doors, windows, fittings and their appliances, their size and locations are shown conventionally and are approximate only and cannot be regarded as being a representation either by the seller or his agent.

optic
MEDIA
optimedia.co.uk

For illustration purposes only



All dimensions and measurements are approximate and for guidance only.

Just Centro's Opinion...

A well-presented self-contained annex situated on the sought-after Cornwall Road in Sutton, offering comfortable and private accommodation ideal for a single professional or a couple.

The property benefits from its own private side entrance and comprises a modern fitted kitchen with built-in appliances and a gas hob, a separate shower room, a spacious double bedroom, and a separate lounge, providing excellent living space and flexibility.

Located on a quiet and popular residential road, the property also benefits from free on-street parking. Sutton and Cheam stations are both within walking distance, offering excellent transport links, while a range of local shops, restaurants, and amenities are easily accessible nearby.

This attractive annex is suitable for either a single occupant or a couple and is available to view immediately. Early viewing is highly recommended.

Additional Photos

