



94 Powerscourt Road

, Portsmouth, PO2 7JW

Offers over £250,000



SPACIOUS END TERRACED HOUSE ** THREE DOUBLE BEDROOMS ** NEWLY FITTED MODERN BATHROOM ** OPEN PLAN LOUNGE / DINER ** SOUTH FACING GARDEN ** EXTRA RECEPTION / HOME OFFICE AREA ** PERFECT FIRST TIME PURCHASE / FAMILY HOME



Welcome to Powerscourt Road...

Located in a well connected and sought after area, this beautifully presented three bedroom end of terrace house on Powerscourt Road offers generous and versatile living space, making it an ideal home for families and first time buyers looking for something move in ready. Thoughtfully updated and extended, the property combines modern comforts with practical design throughout.

Upon entering, you are welcomed into a bright and spacious open plan lounge and dining area, with ample space for a family dining table, multiple sofas and other furnishings.

The kitchen is of a good size and well appointed, providing plenty of workspace and storage, with an oven with hob and extractor fan, butler sink and plumbing for washing facilities.

To the rear of the property, a well-executed extension provides an additional room that can be used as a family room, playroom, or home office, offering flexibility to suit. Double doors open out onto the garden, allowing natural light to fill the room.

Upstairs, the property boasts three well proportioned double bedrooms, each offering comfortable accommodation and ample space for double beds and other furnishings.

The home also benefits from a newly fitted bathroom, completed this year, finished to a modern standard with a bath and overhead shower, toilet, sink with storage unit, electric point with LED mirror, a port for toothbrush/shaver, built in speaker and towel radiator.

Externally, the property continues to impress with a south-facing garden, perfect for enjoying sunlight throughout the day. Mainly laid with artificial turf and a lovely decking area sits at the back offering an excellent space for garden furniture.

This property has undergone significant improvements in recent years, ensuring peace of mind for prospective buyers. All windows, including the rear sliding door, were replaced within the last five years, the pitched roof has also been redone, and the flat roof also in the last two years, along with new fascias and guttering at the rear of the house, further enhancing durability and reducing future maintenance concerns.

Situated in Powerscourt Road you are within close proximity to a range of local amenities including shops, good schools and excellent transport links.

Overall, this is a well maintained and substantially improved home that is ready to move into. With its spacious layout, modern upgrades, and convenient location, this end of terrace property on Powerscourt Road represents an excellent opportunity for buyers seeking a comfortable and stylish home in Portsmouth.

Viewings are advised, please contact us to arrange your appointment.

Area Map

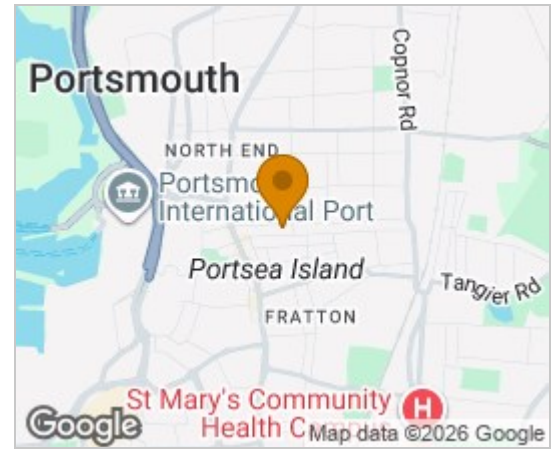

Floor Plans

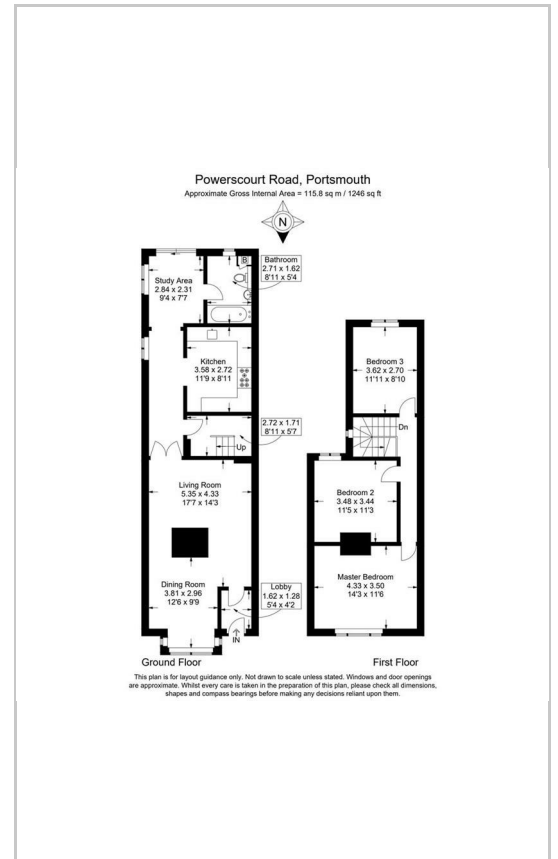

Energy Efficiency Graph

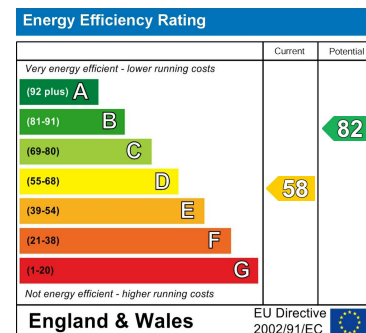

These particulars, whilst believed to be accurate are set out as a general outline only for guidance and do not constitute any part of an offer or contract. Intending purchasers should not rely on them as statements of representation of fact, but must satisfy themselves by inspection or otherwise as to their accuracy. No person in this firm's employment has the authority to make or give any representation or warranty in respect of the property.