



CAVACRE TERRACE



**POOLE
TOWNSEND**

2 Gatacre Terrace, Walney

£125,000

🛏️ 2 🚿 1 🚗 1



Situated in the popular Vickerstown area of Walney, this terraced home is presented in turn-key condition and is offered for sale with no onward chain. The ground floor accommodation comprises a bright and cosy lounge, a separate dining room with access to a useful under-stairs storage cupboard, and a modern kitchen fitted with integrated appliances. To the first floor, the landing provides access to two bedrooms, including a double room at the front of the property and a single bedroom to the rear, alongside a contemporary family bathroom. Further benefits include gas-fired central heating, double glazing throughout, and an enclosed rear yard.

Location

What3Words///estate.lands.talked

Description

Located in a desirable part of Walney, this traditional mid-terrace home offers a comfortable and practical living environment, well suited to first-time buyers, couples, or investors looking for a well-presented home in a convenient location.

The property opens directly into a welcoming lounge, creating an immediate sense of warmth and relaxation, with a built-in storage cupboard and access to the central staircase. This is a space that works well for everyday living and unwinding in the evenings.

To the rear, a separate dining room provides a natural setting for meals and entertaining, with useful under-stairs storage and a glazed door that leads through to the modern kitchen. The kitchen is thoughtfully designed with white gloss cabinetry, integrated appliances, and a practical layout that makes good use of the space, while a rear door opens out onto the enclosed yard—ideal for fresh air, outdoor seating, or low-maintenance living.

Upstairs, the landing leads to two well-proportioned bedrooms, including a comfortable double room at the front with built-in storage, and a single bedroom to the rear. The contemporary bathroom is positioned nearby and features a modern three-piece suite.



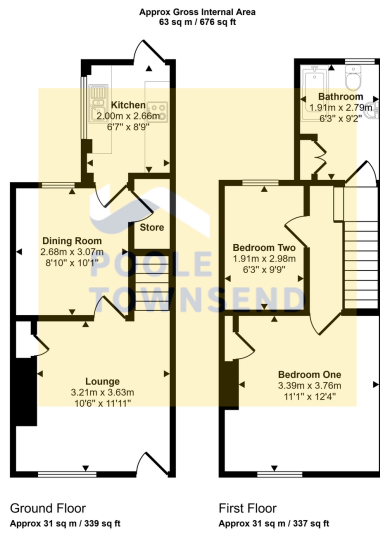

This floorplan is only for illustrative purposes and is not to scale. Measurements of rooms, doors, windows, and any items are approximate and no responsibility is taken for any error, omission or mis-statement. Icons of items such as bathroom suites are representations only and may not look like the real items. Made with Made Snappy 360.

- NO UPPER CHAIN
- Well Presented Property
- Two Bedrooms
- Gas Central Heating
- Situated In The Popular Area of Vickerstown
- Terraced Property
- Lounge And Seperate Dining Room
- Contemporary Family Bathroom
- Double Glazing Throughout

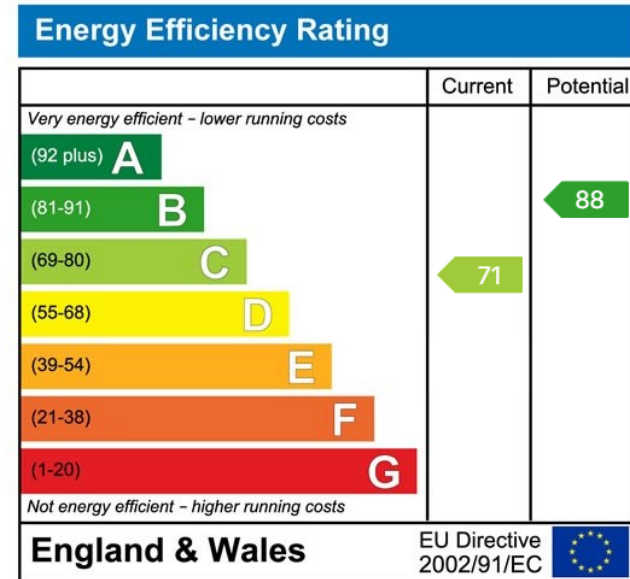

Visit us at
www.pooletownsend.co.uk
enquiries@pooletownsend.co.uk

We are open
 Monday – Friday 9.00 – 5.00
 Saturday 9.00 – 1.00

Barrow 01229 811811
 Ulverston 01229 588111
 Grange 015395 33316
 Kendal 01539 734455
 Milnthorpe 015395 62044