



2 Sussex Lodge, Courtlands, Maidenhead SL6 2PS

welcome to

2 Sussex Lodge, Courtlands, Maidenhead

Sussex Lodge is a well-presented ground floor two-bedroom apartment ideally located in the heart of Maidenhead, just moments from the mainline station and the Elizabeth Line, offering excellent connections into London and beyond.



Sussex Lodge, Courtlands, Maidenhead, SL6

Approximate Area = 625 sq ft / 58.1 sq m

For identification only - Not to scale

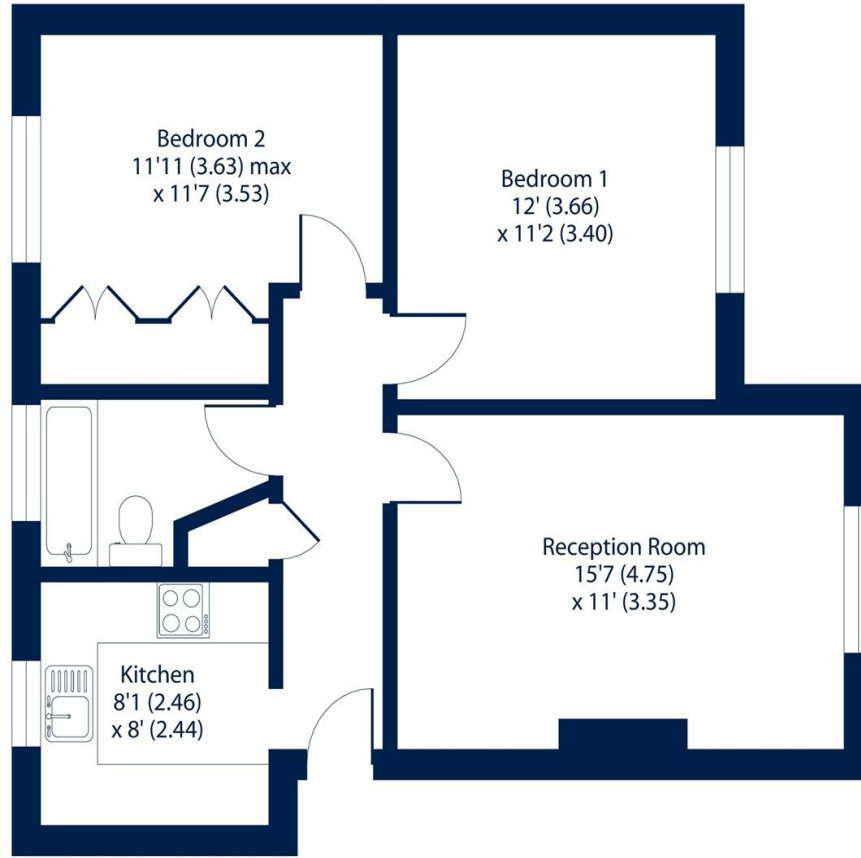

GROUND FLOOR

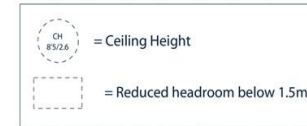

The property features a bright and spacious living area, a fitted kitchen, two well-proportioned bedrooms, and a modern bathroom, making it an ideal purchase for first-time buyers, commuters, downsizers, or investors alike. Being situated on the ground floor provides easy access and added convenience.

Positioned within walking distance of Maidenhead town centre, residents can enjoy a wide range of shops, restaurants, cafés, and local amenities, while nearby parks and riverside walks offer plenty of outdoor leisure opportunities.

With its superb location less than 200 metres from the station, practical layout, and strong transport links, this attractive apartment presents an excellent opportunity to acquire a comfortable and conveniently located home in a highly sought-after area.



welcome to

2 Sussex Lodge, Courtlands, Maidenhead

- MOMENTS FROM THE TRAIN STATION & THE ELIZABETH LINE
- WELL PRESENTED GROUND FLOOR APARTMENT
- BRIGHT & SPACIOUS LIVING AREA
- FITTED KITCHEN
- TWO WELL PROPORTIONED BEDROOMS
- MODERN BATHROOM

Tenure: Leasehold EPC Rating: C

Council Tax Band: C Service Charge: 1868.32

Ground Rent: 75.00

This is a Leasehold property with details as follows; Term of Lease 125 years from 24 Jun 1999. Should you require further information please contact the branch. Please Note additional fees could be incurred for items such as Leasehold packs.

guide price

£240,000



check out more properties at rogerplatt.co.uk



Property Ref:
MHD123892 - 0001

1. MONEY LAUNDERING REGULATIONS Intending purchasers will be asked to produce identification documentation at a later stage and we would ask for your co-operation in order that there is no delay in agreeing the sale. 2. These particulars do not constitute part or all of an offer or contract. 3. The measurements indicated are supplied for guidance only and as such must be considered incorrect. Potential buyers are advised to recheck measurements before committing to any expense. 4. We have not tested any apparatus, equipment, fixtures or services and it is in the buyers interest to check the working condition of any appliances. 5. Where an EPC, or a Home Report (Scotland only) is held for this property, it is available for inspection at the branch by appointment. If you require a printed version of a Home Report, you will need to pay a reasonable production charge reflecting printing and other costs. 6. We are not able to offer an opinion either written or verbal on the content of these reports and this must be obtained from your legal representative. 7. Whilst we take care in preparing these reports, a buyer should ensure that his/her legal representative confirms as soon as possible all matters relating to title including the extent and boundaries of the property and other important matters before exchange of contracts.

Roger Platt is a trading name of Sequence (UK) Limited which is registered in England and Wales under company number 4268443, Registered Office is Cumbria House, 16-20 Hockliffe Street, Leighton Buzzard, Bedfordshire, LU7 1GN. VAT Registration Number is 500 2481 05.

roger platt



01628 773333



Maidenhead@rogerplatt.co.uk



25-29 Queen Street, MAIDENHEAD, Berkshire,
SL6 1NB



rogerplatt.co.uk

Please note the marker reflects the
postcode not the actual property