

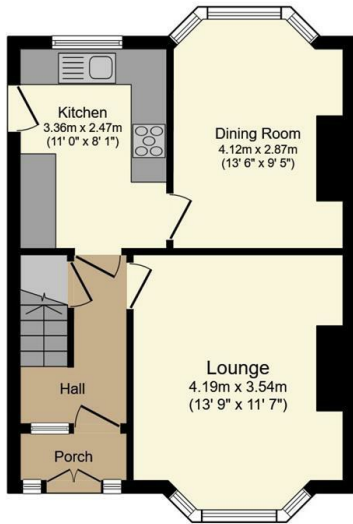

182 Tipton Hill Road, Sheffield, S10 5GF

Offers Over £350,000

- No onward chain
- Two reception rooms
- Private and enclosed rear garden
- Within the catchment area for popular schools
- Semi detached home
- Well-laid-out kitchen
- Great storage in the attic
- Off street parking
- Two double bedrooms and one single bedroom
- Freehold



Ground Floor

Floor area 41.4 sq.m. (446 sq.ft.)

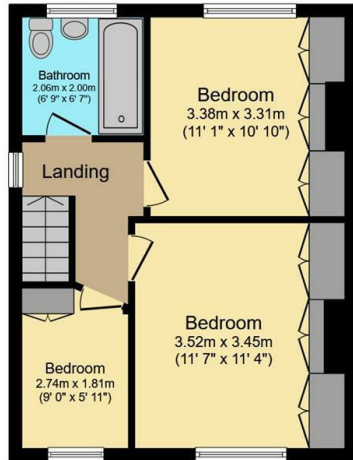

First Floor

Floor area 39.5 sq.m. (425 sq.ft.)

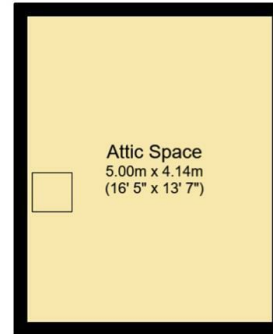

Second Floor

Floor area 21.4 sq.m. (230 sq.ft.)

Total floor area: 80.9 sq.m. (871 sq.ft.)

This floor plan is for illustrative purposes only. It is not drawn to scale. Any measurements, floor areas (including any total floor area), openings and orientations are approximate. No details are guaranteed, they cannot be relied upon for any purpose and do not form any part of any agreement. No liability is taken for any error, omission or misstatement. A party must rely upon its own inspection(s). Powered by www.Propertybox.io

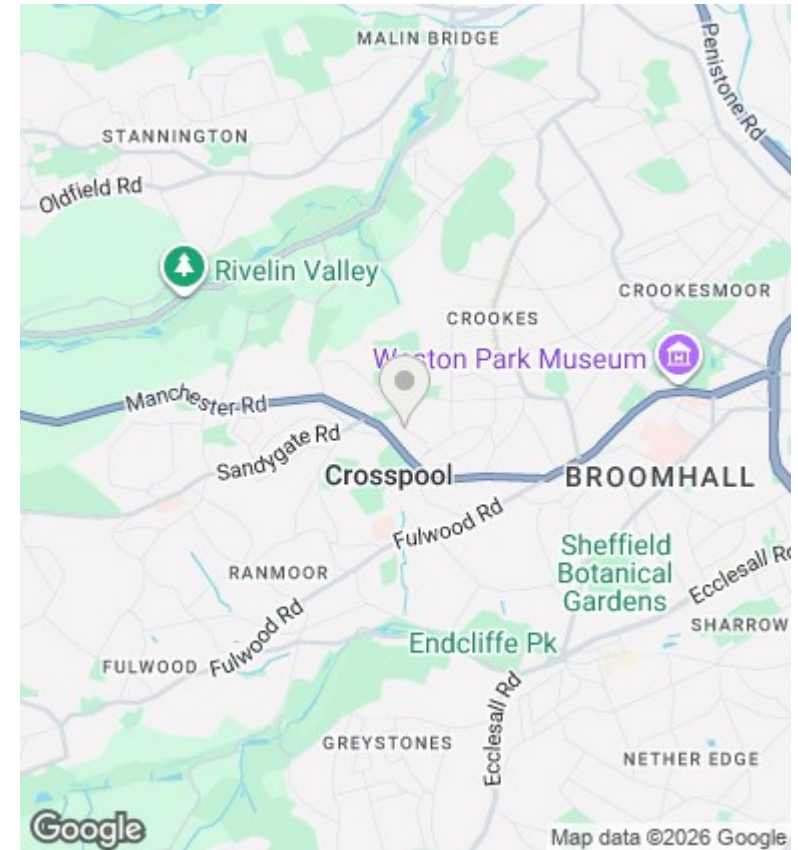

Directions

Viewings

Viewings by arrangement only. Call 01142 687777 to make an appointment.

Council Tax Band

B

EPC Rating:

C

Energy Efficiency Rating		
	Current	Potential
Very energy efficient - lower running costs		
(92 plus) A		
(81-91) B		83
(69-80) C	69	
(55-68) D		
(39-54) E		
(21-38) F		
(1-20) G		
Not energy efficient - higher running costs		
England & Wales	EU Directive 2002/91/EC	