



## Westbourne Villas

, Hove BN3 4GG

- AVAILABLE END OF MAY
- Two Double Bedrooms
  - Close to seafront
  - Fantastic Area
  - Great Size
- STUDENTS WELCOME!
  - Two Bathrooms
  - Separate Kitchen
  - Furniture Options
  - Local Transport Links

**£1,750 PCM**



Local Authority Brighton &  
Hove City Council  
Council Tax Band B  
EPC Rating D

FIRST FLOOR  
560 sq.ft. (52.0 sq.m.) approx.

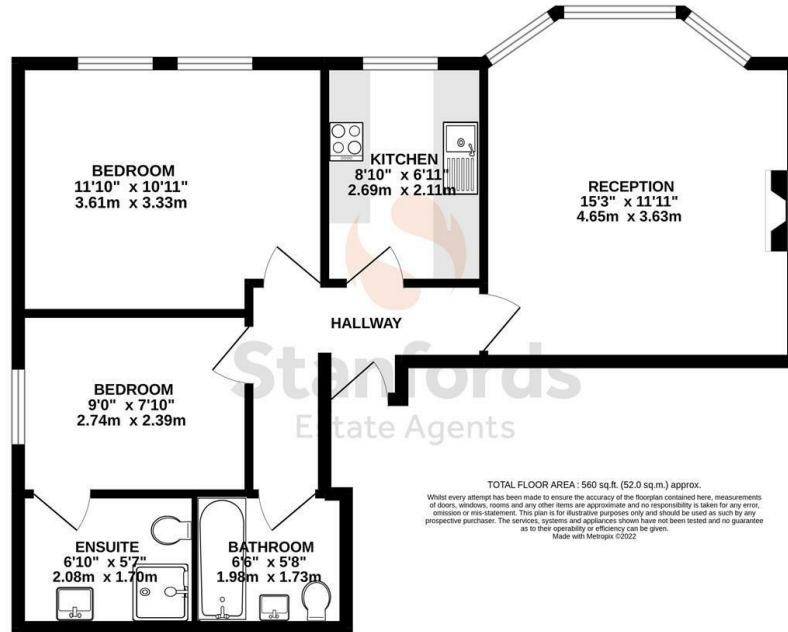

**Stanfords Lettings Office**  
30-31 North Street, Brighton,  
East Sussex, BN1 1EB

**Contact**  
01273 733334  
lettings@stanfords-  
estates.com  
www.stanfords-estates.com

Agents Note: Whilst every care has been taken to prepare these particulars, they are for guidance purposes only. All measurements are approximate and for general guidance purposes only and whilst every care has been taken to ensure accuracy, they should not be relied upon and potential buyers/tenants are advised to recheck the measurements.