

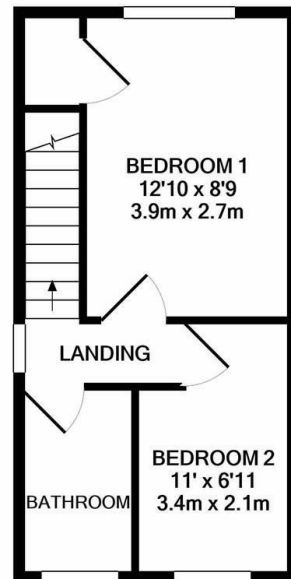

20 The Budding, Stroud, GL5 1XU

£1,050 PCM

- Enclosed garden to the rear
- Two allocated parking spaces
- Council tax band: B
- Double glazed throughout
- Popular location
- Available NOW
- Gas central heating
- EPC Rating: D

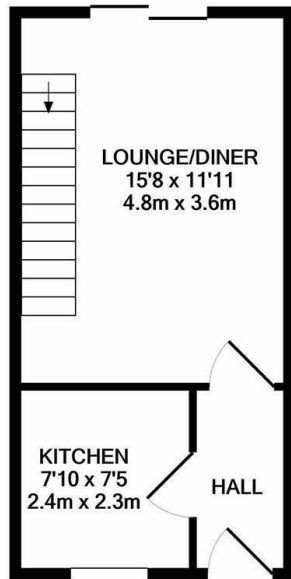

THE BUDDING
TOTAL APPROX. FLOOR AREA 533 SQ.FT. (49.5 SQ.M.)
Made with Metropix ©2020

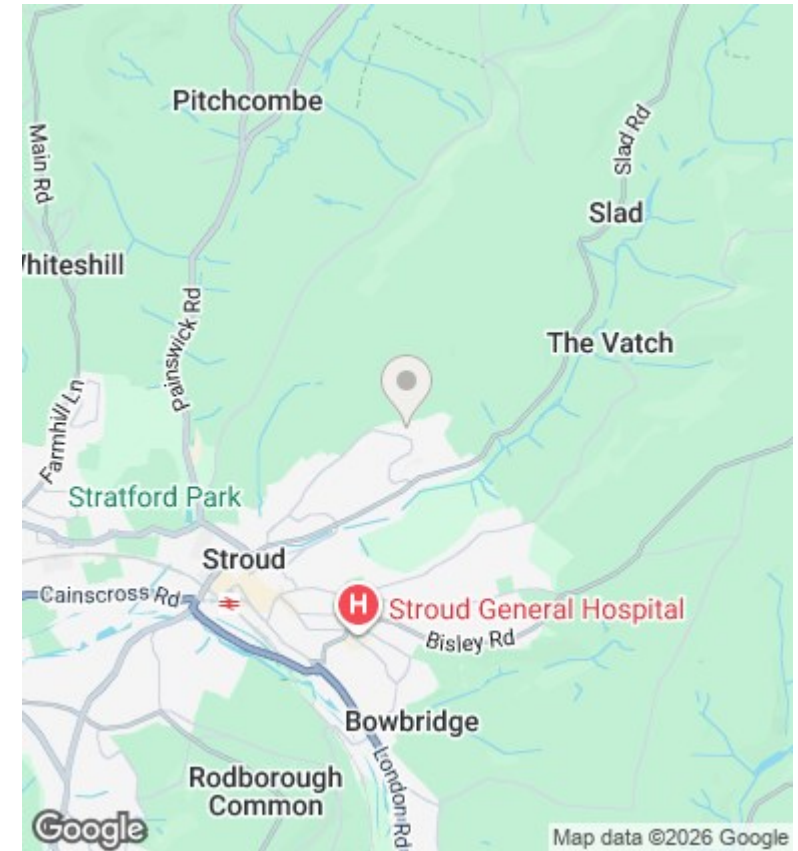

Directions

Viewings

Viewings by arrangement only. Call 01453 833847 to make an appointment.

Council Tax Band

B

EPC Rating:

D

Energy Efficiency Rating		Current	Potential
Very energy efficient - lower running costs			
(92 plus) A			
(81-91) B			87
(69-80) C			
(55-68) D		68	
(39-54) E			
(21-38) F			
(1-20) G			
Not energy efficient - higher running costs			
England & Wales		EU Directive 2002/91/EC	