



Bellevue Road, N11

£500,000

A beautifully presented two bedroom garden flat set within a quiet road in New Southgate. This property benefits from two bathrooms, an open plan kitchen/ living room, a large private garden and the property is being sold chain free.

Bellevue Road is located in New Southgate, just a short walk from Southgate Overground Station, offering frequent connections into the city and reaching Kings Cross in under 25 minutes. Whetstone High street is close by, along with several public green spaces.

Features

- Two Double Bedrooms
- Two Bathrooms
- Off-street Parking
- Private Garden
- Excellent Condition
- Chain Free

Bellevue Road, London, N11

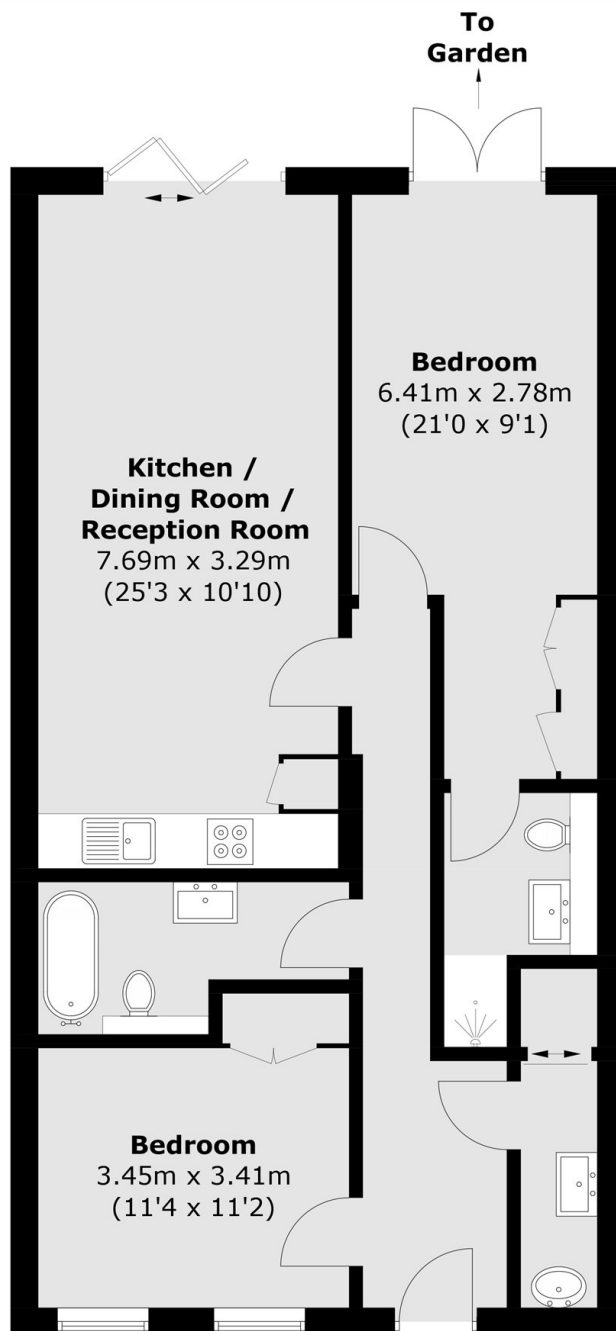

Total area (approx.): 75.5 sq. m (812.7 sq. ft)

Dexters

Finchley
126 Ballards Lane
Finchley
London
Sales
020 8742 4180

Energy Rating: C. We aim to make our particulars both accurate and reliable. However they are not guaranteed; nor do they form part of an offer or contract. If you require clarification on any points then please contact us, especially if you're traveling some distance to view. Please note that appliances and heating systems have not been tested and therefore no warranties can be given as to their good working order.

 **RICS** | Regulated
Estate Agent
and Letting Agent

dexters.co.uk