



## 35 Kestrel Avenue

Thorpe Hesley, Rotherham, S61 2TT

£340,000



Four-Bedroom Detached Family Home in Thorpe Hesley

Discover this four-bedroom detached property, perfectly positioned on a corner plot in the highly sought-after village of Thorpe Hesley. Offering spacious and versatile accommodation throughout, this home blends comfort with the peace and charm of countryside living.

The property boasts generous living spaces, garden, and a private driveway providing ample parking.

Set within a desirable residential area, this home is conveniently located close to local amenities, reputable schools, and excellent transport links—making it the perfect choice for families seeking a balance of comfort, convenience, and village charm.





GROUND FLOOR

ENTRANCE HALL

A spacious entrance hall welcomes you into the home, featuring a front door with a side window, useful under stairs storage, and a staircase rising to the first floor.

LOUNGE

A well-proportioned lounge featuring a front-facing bay-style double-glazed window that fills the room with natural light. The space also includes a modern wall-mounted electric fire, central heating radiator, and glass sliding doors leading through to the dining room, creating a bright and open flow between living areas.

DINING AREA

Open-plan and accessible via sliding doors from the lounge, this generously sized reception room offers flexible living space. It features a door leading to the kitchen, a double-glazed window overlooking the conservatory, and a central heating radiator.

KITCHEN

A modern kitchen featuring a range of wall and base units with worktop surfaces incorporating a sink unit with mixer tap. Integrated appliances include a fridge-freezer, oven, hob with extractor hood, and washing machine. The kitchen is finished with tiled flooring and benefits from a rear-facing double-glazed window, as well as a door leading to the conservatory, providing a bright and practical space for cooking and dining.

CONSERVATORY

A good-sized conservatory that overlooks the rear garden, providing a bright and versatile space for relaxation or entertaining.

FIRST FLOOR

BEDROOM ONE

A double bedroom featuring a front-facing double-glazed window and a central heating radiator, offering a bright and comfortable space.

BEDROOM TWO

A further double bedroom featuring fitted furniture and a rear-facing window that overlooks the garden, providing a practical and bright living space.

BEDROOM THREE

A good sized third bedroom with fitted storage, radiator and double glazed window.

BEDROOM FOUR

A single bedroom offering ample space for a bed and wardrobes, making it a versatile room suitable for a child, guest, or home office.

SHOWER ROOM

A three-piece bathroom suite comprising a shower cubicle, WC, and wash hand basin, complete with a double-glazed obscure window and central heating radiator.

OUTSIDE

The property benefits from a driveway to the front and gardens to the side and rear, thoughtfully landscaped with mature shrubs and borders, creating an attractive and private outdoor space.

Area Map



Floor Plans

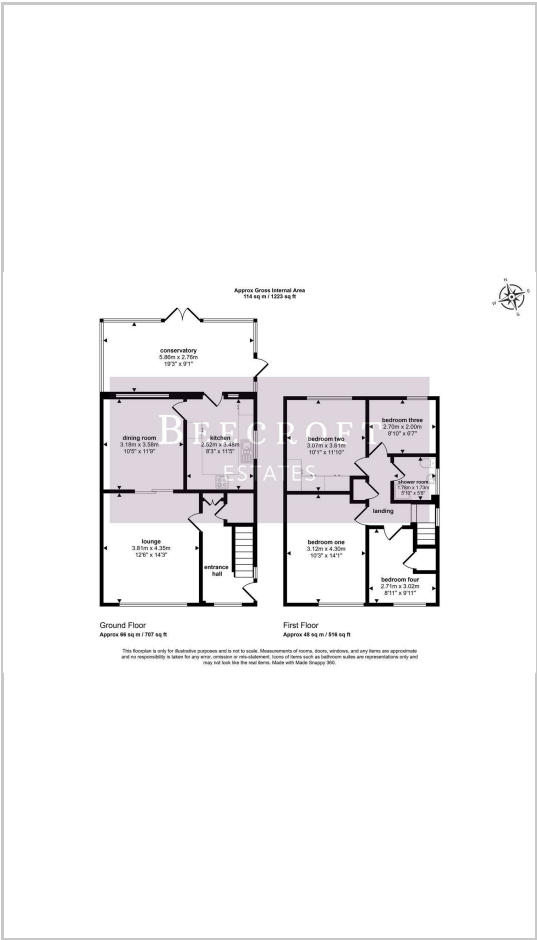

Energy Efficiency Graph

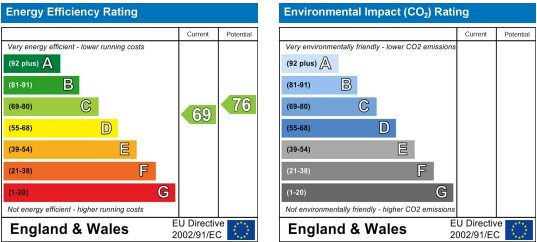

These particulars, whilst believed to be accurate are set out as a general outline only for guidance and do not constitute any part of an offer or contract. Intending purchasers should not rely on them as statements of representation of fact, but must satisfy themselves by inspection or otherwise as to their accuracy. No person in this firm's employment has the authority to make or give any representation or warranty in respect of the property.