



Banning Street, SE10

£525,000

A beautifully presented two-bedroom, two-bathroom apartment, uniquely positioned directly facing the river, offering uninterrupted views towards the iconic skylines of Canary Wharf and The City. This exceptional home features a private riverside terrace - the perfect setting for summer relaxation, al fresco drinks, or simply enjoying the tranquil waterfront outlook.

Residents benefit from a prestigious development offering a 24-hour concierge service and exclusive access to private leisure facilities, including a swimming pool, fully equipped gymnasium, tennis court, and beautifully maintained landscaped gardens set within the grounds. An outstanding riverside residence combining luxury living with spectacular London views.

Henry Hudson Apartments development is located on the banks of the Thames and has a fantastic community feel with the beautiful Greenwich Park, Thames Pathway, University of Greenwich, the Old Naval College, National Maritime Museum, Royal Observatory, listed buildings and pubs of Greenwich town, and Greenwich Market. Maze Hill rail station is a short walk away and allows for a 13-15 minute journey into London Bridge station, the Cutty Sark DLR provides a direct link to Canary Wharf (Jubilee and Elizabeth Line) and Bank, while the North Greenwich Jubilee line and O2 Arena are easily accessible.

Features

- Two Bedrooms
- Two Bathrooms
- Private Gym & Tennis Courts
- Residents Swimming Pool
- Amazing City & River Views
- Private Terrace

Banning Street,
London, SE10

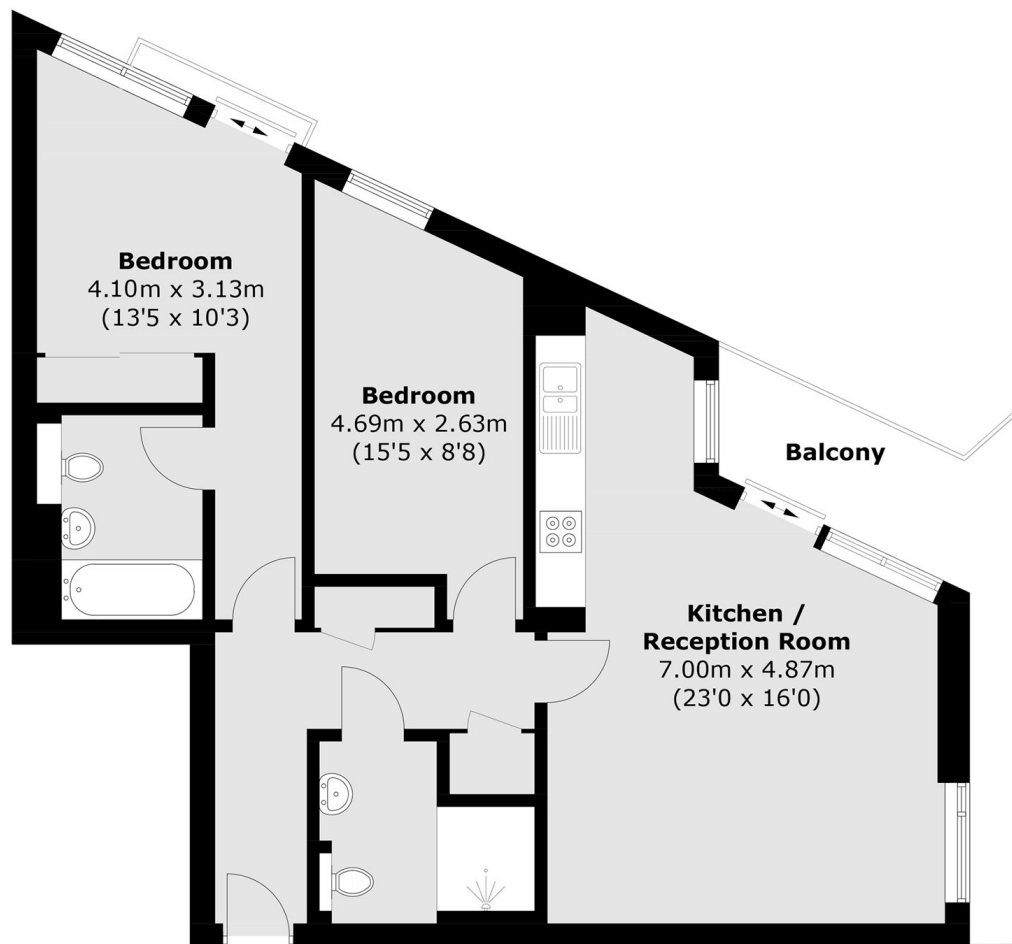

Total area (approx.): 75.2 sq. m (809.4 sq. ft)
Balcony: 7.0 sq. m (75.3sq. ft)