

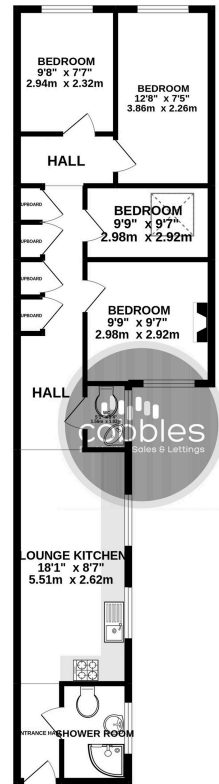

GROUND FLOOR
696 sq. ft. (64.7 sq.m.) approx.



Sydenham Road

Guildford, Guildford

Spacious, redecorated three-bedroom apartment in central Guildford. Features modern kitchen, bright lounge, shower room, separate WC, and is close to stations, university, and amenities.

Council Tax band: H

Tenure: Leasehold

EPC Energy Efficiency Rating: E

EPC Environmental Impact Rating: E

- Four Bedrooms
- Modern Finish
- Seperate WC
- Central Town Location
- Council Tax Band – B
- EPC Rating – E

TOTAL FLOOR AREA : 696 sq.ft. (64.7 sq.m.) approx.
Whilst every attempt has been made to ensure the accuracy of the floorplan contained here, measurements of doors, windows, rooms and any other items are approximate and no responsibility is taken for any error, omission or mis-statement. This plan is for illustrative purposes only and should be used as such by any prospective purchaser. The services, systems and appliances shown have not been tested and no guarantee as to their operability or efficiency can be given.
Made with Metropix ©2022

