



£290,000

Middlefield Road, Bromsgrove B60 2PW

GUEST
ESTATE AGENTS

Beautifully presented Victorian end terrace home
Highly sought after Aston Fields location
Spacious open plan lounge diner with bay window
Fully refurbished kitchen with quartz worktops
Separate utility area and downstairs WC
Two generous bedrooms & storage room
Refurbished family bathroom
Private south facing rear garden
Double glazing replaced in 2019
Sought after Aston Fields location

Located in the heart of the ever popular Aston Fields village and just a short walk from its vibrant cafés, restaurants and railway station, this beautifully presented two bedroom Victorian end terrace combines period charm with stylish modern upgrades. Dating back to around 1900, the home has been thoughtfully improved by the current owners, including a fully refurbished kitchen, updated bathroom and a bright open plan lounge diner that creates a wonderful sense of space. With a south facing garden and a location that consistently proves popular with buyers, this property offers an ideal blend of character, convenience and contemporary living.

The property sits attractively along Middlefield Road, set back from the road behind a low wall and gravelled frontage which enhances its kerb appeal while providing a practical low maintenance entrance. To the left of the house, a gated pathway leads conveniently through to the rear garden.

Entering the home via a porch, you are welcomed into a particularly impressive open plan lounge diner. Originally two separate rooms, the removal of the dividing wall has created a wonderfully spacious and light filled living area, while still retaining the character typical of Victorian homes. A bay window to the front fitted with shutters provides an attractive focal point, while a further window to the rear allows natural light to flow through the space. Natural wood LVT flooring adds warmth and continuity throughout the room.

The living space flows into the kitchen, creating an ideal layout for both everyday living and entertaining. The kitchen has been fully refurbished to a high standard and features striking deep green cabinetry complemented by contemporary gold fittings. Quartz worktops and matching splashbacks create a sleek and durable finish, while integrated appliances include a dishwasher, fridge freezer, oven, microwave oven and extractor. Two



windows allow excellent natural light into the space. Beyond the kitchen is a particularly useful utility area, offering additional space for appliances and storage. A door from here leads directly out to the garden and there is also a further window providing natural light. Off the utility area is a convenient downstairs WC.

Upstairs, the property continues to offer well proportioned accommodation with two generous bedrooms. Both rooms provide comfortable double accommodation, while the landing also benefits from a useful storage cupboard and an additional store room which provides excellent extra storage space rarely found in homes of this style. The family bathroom has been tastefully refurbished and features contemporary tiling along with a bath and shower over with a sleek glazed shower screen, creating a clean and modern finish.

The property has also benefitted from practical upgrades including replacement windows installed in 2019 and a combi boiler fitted in 2020.

Outside, the south facing rear garden provides a private and enclosed outdoor space. Established hedging along one side helps create a pleasant sense of privacy, while the garden itself offers a combination of lawn and a paved patio area, ideal for outdoor seating and entertaining during the warmer months.

Aston Fields has become one of the most desirable areas of Bromsgrove, known for its thriving village atmosphere and excellent commuter connections. The property is just a short walk from the centre of Aston Fields, where you will find a range of independent cafés, restaurants, bars and local shops that give the area its distinctive character. Bromsgrove railway station is also within easy reach, providing direct links to Birmingham and Worcester, making the location particularly appealing for commuters.

There are several well-regarded schools* nearby, along with local parks, green spaces and leisure facilities. Bromsgrove town centre is just a short distance away and offers a wider range of retail, supermarkets and everyday amenities.





Floorplan

Ground Floor

Approx. 45.2 sq. metres (486.7 sq. feet)

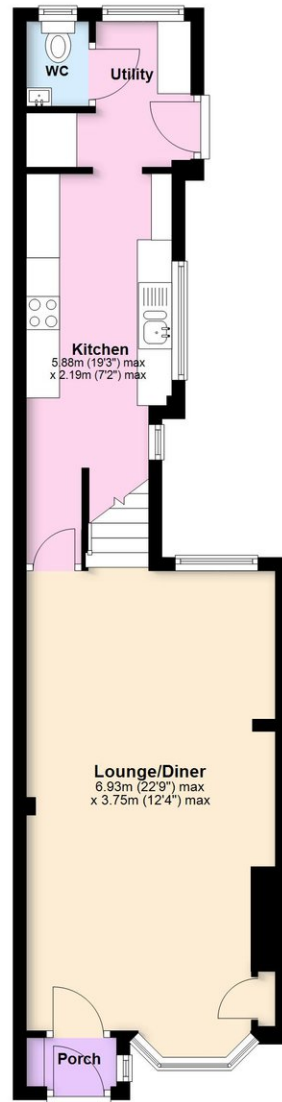

First Floor

Approx. 38.2 sq. metres (410.9 sq. feet)

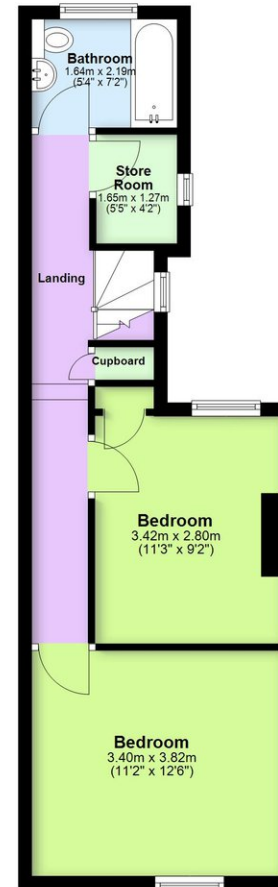

Total area: approx. 83.4 sq. metres (897.6 sq. feet)

Whilst every attempt has been made to ensure the accuracy of this floorplan, measurements of doors, windows, rooms and any other item are approximate, and no responsibility is taken for any error, omission, or mis-statement. This plan is for illustrative purposes only and should be used as such by any prospective purchaser.
Plan produced using PlanUp.

Want to view this property?

Call us on 01527 306420, or email hello@guestestateagents.com

Property to sell?

Guest Estate Agents can offer you an outstanding level of service, successfully selling property in and around Bromsgrove. For a free valuation, call us on 01527 306420, or email hello@guestestateagents.com

Independent mortgage advice

We recommend Guest Independent Mortgage Advice. Call 01527 306425, or email hello@guestindependent.com to arrange an initial chat with no pressure or obligation.

Solicitor / Conveyancer

Getting the right firm to do the legal work can make or break a sale. Just ask us for a recommendation / quote,

Lettings

For fully managed lets or just a tenant find, we recommend Douglas Lettings. More info at www.douglaslettings.co.uk

Everything else

For surveys, removals, EPCs, or any other property related needs, we can recommend someone reliable to help you.

Our contact details

Phone: 01527 306420

Email: hello@guestestateagents.com

Address: 1 St Godwald's Road, Aston Fields, Bromsgrove B60 3BN

Disclaimer

You should not rely on statements made by Guest Estate Agents in these details, or by word of mouth, or in writing, as being factually accurate about the property, its condition, or its value. The tenure needs to be verified via your solicitors. Areas, measurements and distances are approximate. Any reference to alterations or extensions, or use of, or any part of the property does not mean that the necessary planning, building regulations or any other consent has been obtained. A buyer must find out by inspection or other ways to verify that these matters have been dealt with and that the information is correct.

