



8 Ashbrooke Court

Hutton Henry, Hartlepool, TS27 4QY

Offers Over £340,000



Nestled in the charming village of Hutton Henry, Hartlepool, this stunning self-built detached house offers an exceptional living experience. With four spacious bedrooms, this property is perfect for families seeking comfort and style. The two well-appointed bathrooms (including master en-suite) ensure convenience for all residents.

As you enter, you are greeted by a modern kitchen that seamlessly blends functionality with contemporary design, making it an ideal space for culinary enthusiasts. The property boasts two generous reception rooms, providing ample space for relaxation and entertaining guests.

Outside, the generous-sized rear garden presents a delightful outdoor retreat, perfect for family gatherings or quiet evenings under the stars. The property also features a three-car driveway and a garage, offering parking for up to four vehicles, which is a rare find in such a picturesque setting.

Living in Ashbrooke Court means enjoying the tranquillity of village life while being conveniently located near local amenities. This home is not just a property; it is a lifestyle choice that combines modern living with the charm of a beautiful village location. Do not miss the opportunity to make this remarkable house your new home.



Area Map

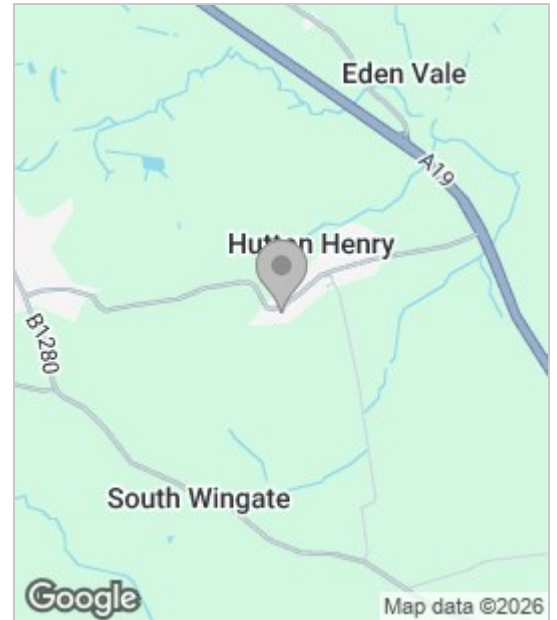

Floor Plan

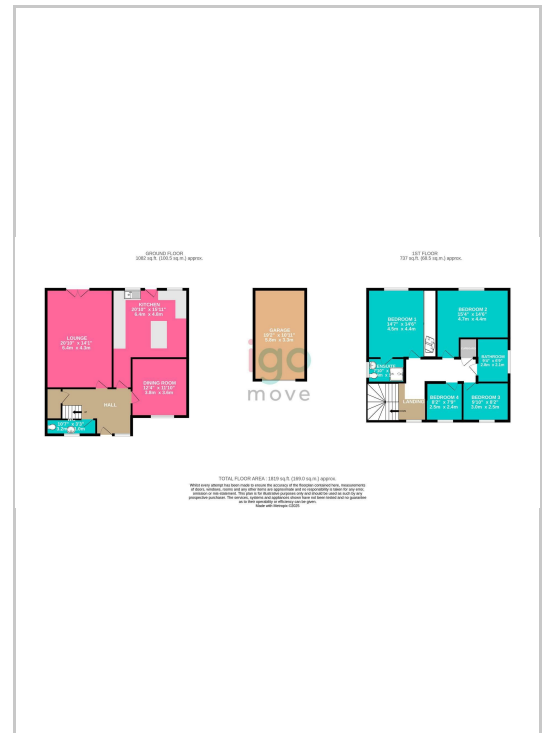

Energy Efficiency Graph

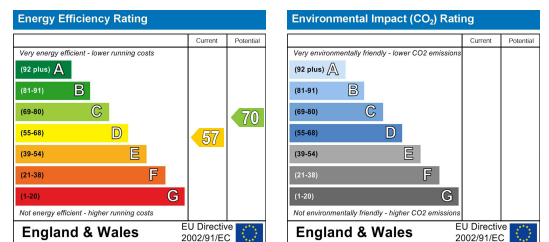

These particulars, whilst believed to be accurate are set out as a general outline only for guidance and do not constitute any part of an offer or contract. Intending purchasers should not rely on them as statements of representation of fact, but must satisfy themselves by inspection or otherwise as to their accuracy. No person in this firm's employment has the authority to make or give any representation or warranty in respect of the property.