



Cromwell Street, Walkley, S6 3RP

Offers In Region Of £190,000

 2  1  1



A Brilliant Opportunity to Make It Your Own: Cromwell Street, Walkley

Set in the heart of Walkley, this two bedroom end terrace home offers spacious living across two floors, a private rear garden, and plenty of potential. In need of some modernisation, this is the perfect opportunity to create a home that reflects your style, in one of Sheffield's most popular locations.

Why You'll Love It

The ground floor features a generous lounge to the front, full of natural light and character. At the rear, a well-sized kitchen offers fitted cabinetry, an integrated oven and hob, space to dine, and direct access to the private garden.

Upstairs, the main bedroom is a spacious double, while the second bedroom is a comfortable single, ideal as a nursery, study, or guest room. The standout feature is the impressive four piece bathroom suite, complete with separate bath and shower, offering plenty of space and flexibility.

With no onward chain and a layout full of potential, this is an excellent choice for first time buyers, down sizers or anyone looking to add value through modernisation.

Why We Love It

Cromwell Street is ideally positioned just off South Road in the heart of Walkley. Independent shops, pubs and cafés are a short stroll away, with the green open space of Bolehills Park also nearby. Excellent public transport and road links connect you easily to the city centre, universities and hospitals.



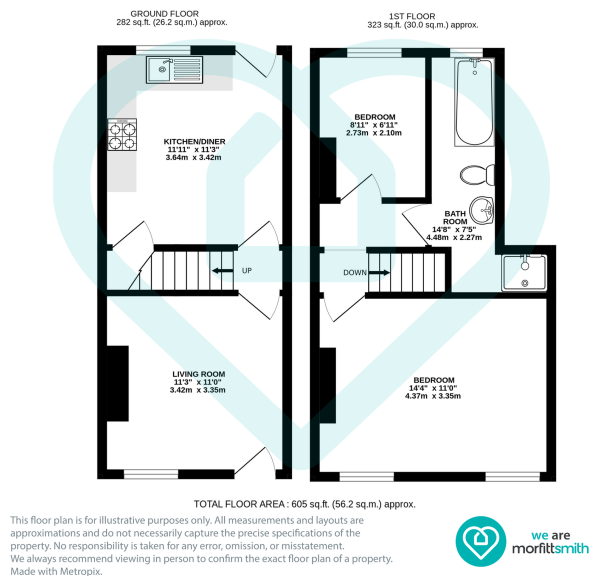

- No Onward Chain
- Spacious Lounge with Natural Light
- One Double Bedroom and One Single Bedroom
- Enclosed Private Rear Garden
- On Street Parking
- Two Bedroom End Terrace in Walkley
- Kitchen with Integrated Oven and Hob
- Generous Four Piece Bathroom Suite
- Excellent Location Close to Shops and Parks
- Ideal For Renovation

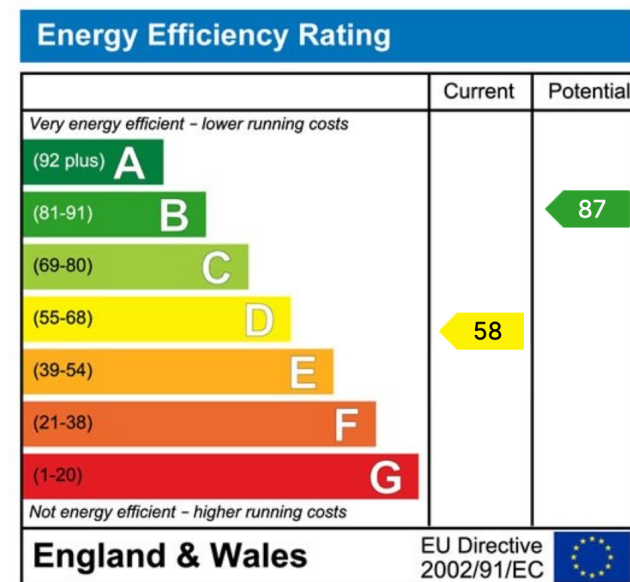

Sales | Lettings | New Homes

VAT Reg Number: 191 3588 84
Company Reg Number: 08610489
Company Reg Address: 67 Middlewood Road, Hillsborough, Sheffield, S6 4GX.

The MorfittSmith Building
67 Middlewood Road
Hillsborough
Sheffield
S6 4GX

Get in touch - arrange an appointment



0114 232 1764



sales@morfittsmith.co.uk
lettings@morfittsmith.co.uk
newhomes@morfittsmith.co.uk



www.morfittsmith.co.uk



@MorfittSmith



@MorfittSmith



MorfittSmith
Estate & Letting Agent