



Blenheim Way, Kettering **Freehold** £220,000 O.I.E.O.

**Pattison
Lane**

Key Features

 3  1  C  B

- Three Bedroom End of Terraced Family Home
- Spacious Living Room
- Kitchen and Separate Dining Room
- Conservatory
- Single Garage and Parking for Two Vehicles

Welcome to the market, this well presented three-bedroom end-of-terrace home, complete with a single garage, off-road parking for two cars, and a lovely enclosed rear garden!

Perfect for growing families or first-time buyers, this property offers a deceptively spacious layout designed for modern living.



Positioned at the front of the home, the bright and airy living room is bathed in natural light from a large front-facing window. The doorway from the living room into a dedicated dining room, creates an excellent flow for entertaining. Extending from the dining area is a sun-filled conservatory, offering a peaceful spot to relax with views over the garden.

Fitted with a generous range of wall and base units, the kitchen features an integrated oven, hob, and dishwasher. There is also ample plumbing and space for a washing machine, tumble dryer, and a freestanding fridge-freezer.

The First-Floor landing leads to three well-proportioned bedrooms, including two comfortable doubles. The excellent storage solutions are built-in, with handy cupboards located on both the landing and within the third bedroom.

A neat family bathroom suite completes the internal accommodation.

To the rear, the property boasts a fully enclosed, private garden, which is mainly laid to lawn-ideal for children, pets, or summer barbecues.

Off-road parking for two vehicles is located alongside a secure single garage.

Viewings are highly advised to appreciate all this home has to offer!



GROUND FLOOR

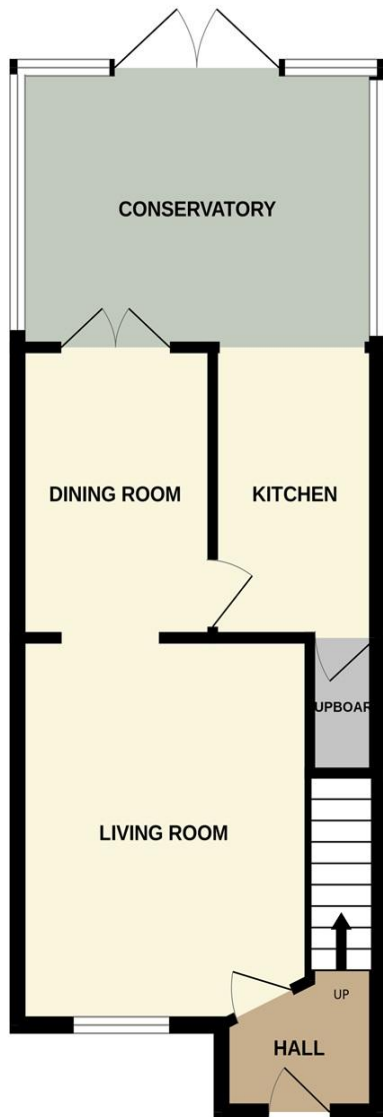

1ST FLOOR

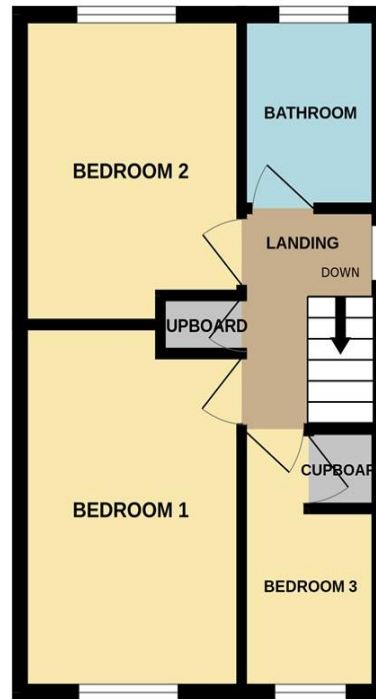

The accommodation comprises:

ENTRANCE HALL

LIVING ROOM 11'5 x 13'5 max (3.47m x 4.08m)

DINING ROOM 7'2 x 9'6 (2.18m x 2.89m)

KITCHEN 9'6 x 7' (2.89m x 2.13m)

CONSERVATORY 13'5 x 9'3 (4.08m x 2.81m)

FIRST FLOOR LANDING

BEDROOM ONE 12'3 x 8'3 max (3.73m x 2.51m)

BEDROOM TWO 10'9 x 8'3 max (3.27m x 2.51m)

BEDROOM THREE 6'1 max x 9'7 (1.85m x 2.92m)

OUTSIDE

FRONT GARDEN

REAR GARDEN

GARAGE & DRIVEWAY

To view this property call Pattison Lane on:
01536 524425

Selling your property?



SCAN ME

Contact us to arrange a **FREE** home valuation.

 01536 524425

 68-70 Gold Street, Kettering, Northamptonshire, NN16 8JB

 kettering@pattisonlane.co.uk

 www.pattisonlane.co.uk



SCAN ME



Sharman Quinney Holdings Limited is registered in England and Wales under company number 4174227, Registered Office is Cumbria House, 16-20 Hockliffe Street, Leighton Buzzard, Bedfordshire, LU7 1GN. VAT Registration Number is 500 2481 05.

1: These particulars do not constitute part or all of an offer or contract. 2: The measurements indicated are supplied for guidance only and as such must be considered incorrect. 3: Potential buyers are advised to recheck the measurements before committing to any expense. 4: Sharman Quinney has not tested any apparatus, equipment, fixtures, fittings or services and it is the buyers interests to check the working condition of any appliances. 5: Sharman Quinney has not sought to verify the legal title of the property and buyers must obtain verification from their legal representative. 6: Intending purchasers will be asked to produce identification documentation at a later stage and we would ask your co-operation in order that there will be no delay in agreeing the sale. Ref: KPL206961 - 0003

