



## **Cavalier Way** **, Wincanton BA9 9ED**

**\*\*\* MUST VIEW PROPERTY \*\*\*** Ideal Starter Home or Investment - A lovely flat in Wincanton with a generous reception room and two comfortable bedrooms. Perfect for relaxing, entertaining, or making your first step onto the property ladder.

**Offers over £100,000 Leasehold**



Local Authority  
Council Tax Band **A**  
EPC Rating **D**

## Ground Floor

Approx. 59.6 sq. metres (641.0 sq. feet)

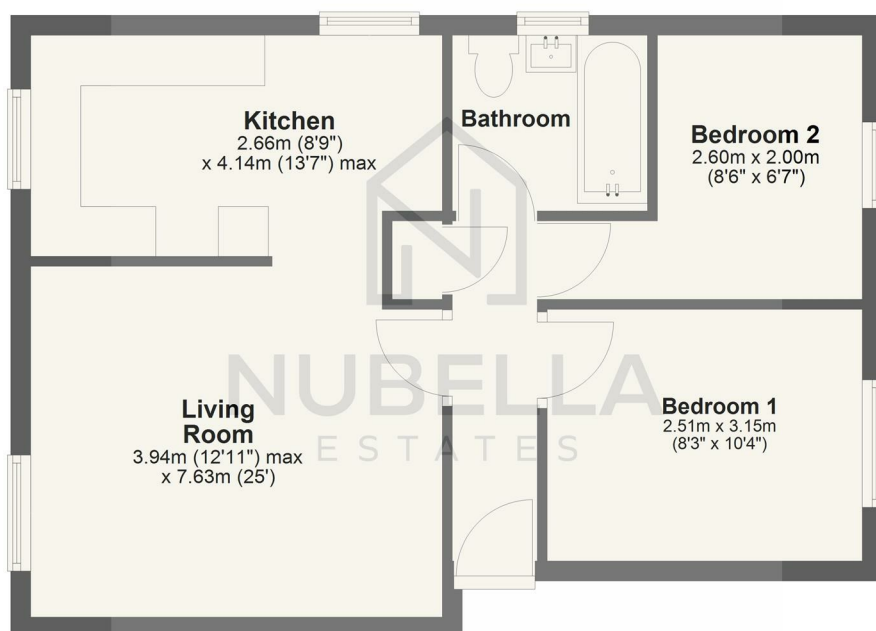

Total area: approx. 59.6 sq. metres (641.0 sq. feet)



**Gillingham Office**  
The Old School Room Newbury,  
Gillingham, SP8 4QJ

**Contact**  
01747 440880  
[sales@nubellaestates.com](mailto:sales@nubellaestates.com)  
[www.nubellaestates.com](http://www.nubellaestates.com)

Agents Note: Whilst every care has been taken to prepare these particulars, they are for guidance purposes only. All measurements are approximate and for general guidance purposes only and whilst every care has been taken to ensure accuracy, they should not be relied upon and potential buyers/tenants are advised to recheck the measurements.