



## Alexandra Grove, N12

£2,250 Per calendar month

A newly refurbished two double bedroom flat with sole use of a garden. This flat features a modern kitchen and bathroom.

Situated close to the local amenities, shops and restaurants of both Ballards Lane and North Finchley High Road, with West Finchley Underground Station just a short walk away.

### Features

Two Bedrooms  
One Reception  
One Bathroom  
Garden  
Modern  
Ground Floor

# Alexandra Grove, London, N12

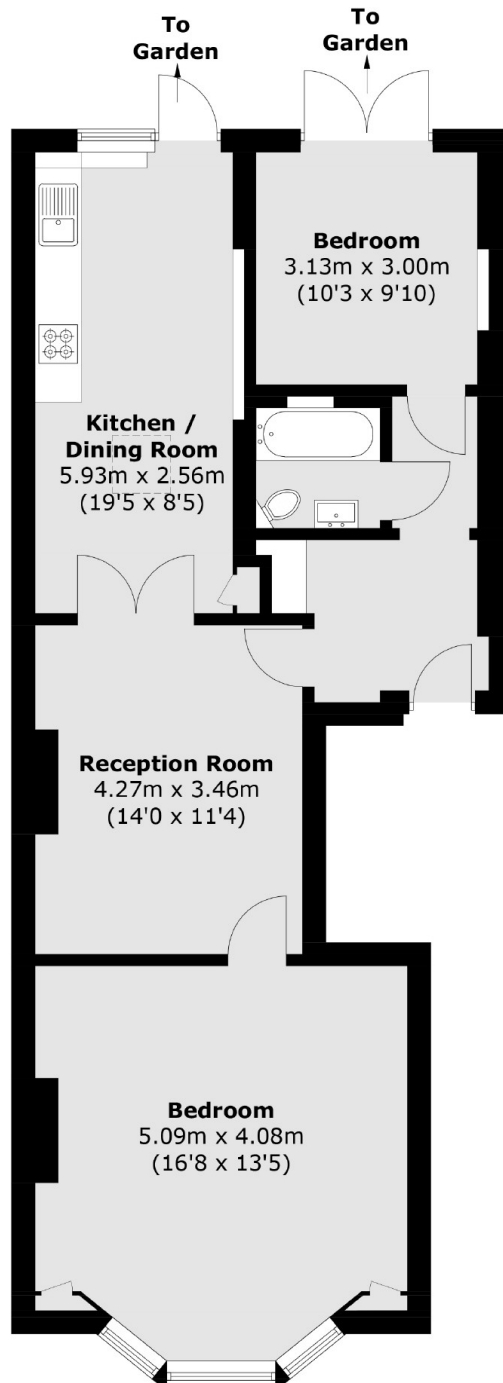

Total area (approx.): 75.4 sq. m (811.6 sq. ft)