



Spurstowe Terrace, E8

£399,000

A one bedroom apartment in a modern secure development, Portcullis House. Measuring over 570 sq ft, this larger than average one bedroom property benefits from an open plan kitchen living area with kitchen island, private balcony and a modern bathroom. There is underfloor heating, lift access, secure bike storage and no onward chain.

Just around the corner from both Hackney Central and Hackney Downs Overground stations offering direct access to the City. Set in the heart of Hackney, this property is a short walk from the many shops, bars, restaurants, cafés of Hackney Central and Broadway Market. The green spaces of London Fields and Hackney Downs Park are under half a mile away.

Features

- One Double Bedroom
- Private Balcony
- Lift Access
- Secure Bike Storage
- Close To Transport
- Chain Free

Spurstowe Terrace, London, E8

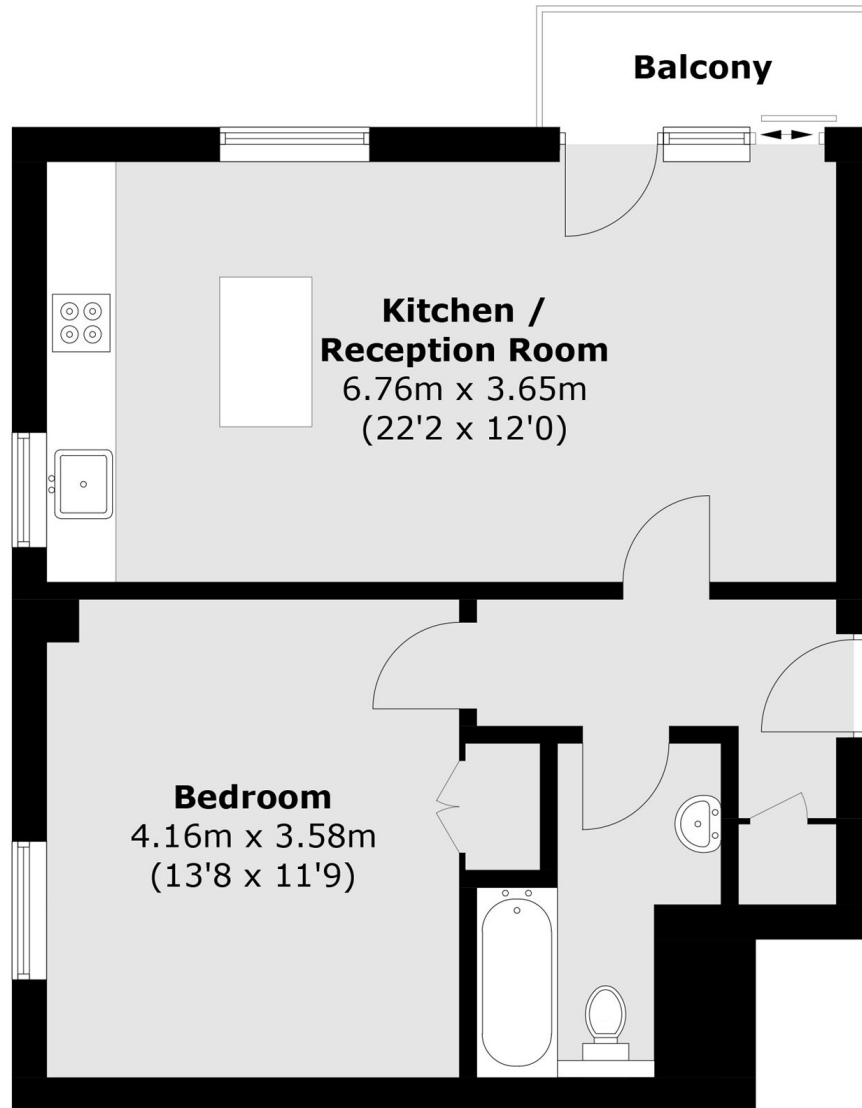

Total area (approx.): 53.3 sq. m (573.7 sq. ft)
Balcony: 2.8 sq. m (30.1 sq. ft)