



RESIDE

MANCHESTER



Middlewood Locks
Lockgate Square, Salford, M5 4YU

Asking Price £200,000



1



1



1

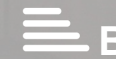

B

Middlewood Locks

1 Lockgate Square, Salford, M5 4YU

Middlewood Locks is an award-winning neighbourhood situated on the border of Manchester City Centre and Salford.

Set within a vibrant waterside development, it is home to some of Manchester's most popular independent businesses, including 92 Degrees Coffee.

This spacious one-bedroom apartment has been finished to a high standard throughout, offering a bright and airy open-plan layout ideal for modern living. The property also benefits from a generously sized balcony with impressive views, making it an excellent opportunity for both owner-occupiers and investors.

The Tour

The Area

Middlewood Locks is a vibrant, mixed-use, award-winning neighbourhood that seamlessly connects Manchester and Salford. Set alongside the canal and just a short walk from the sought-after areas of Castlefield and Spinningfields, the development offers an exceptional location for city living.

Whether you are exploring the independent bars and restaurants along Chapel Street or enjoying the shops, cafés, and amenities of Spinningfields, Middlewood Locks is perfectly positioned to place you within easy reach of some of Manchester's most popular and rapidly growing destinations.

Lease Information

Length of lease - 999 years from 2018

Service charge - £1954.76 pa including building insurance

Ground rent - £200pa. Reviewed with RPI every 10 years

EWS1 Form available - B1 Rated





- One Double Bedroom
- One Bathroom
- Top Floor
- Chain Free
- Walking Distance From City Centre
- EPC Rating B
- Multi Award Winning Development
- EWS1 Form Available

Floor Plan

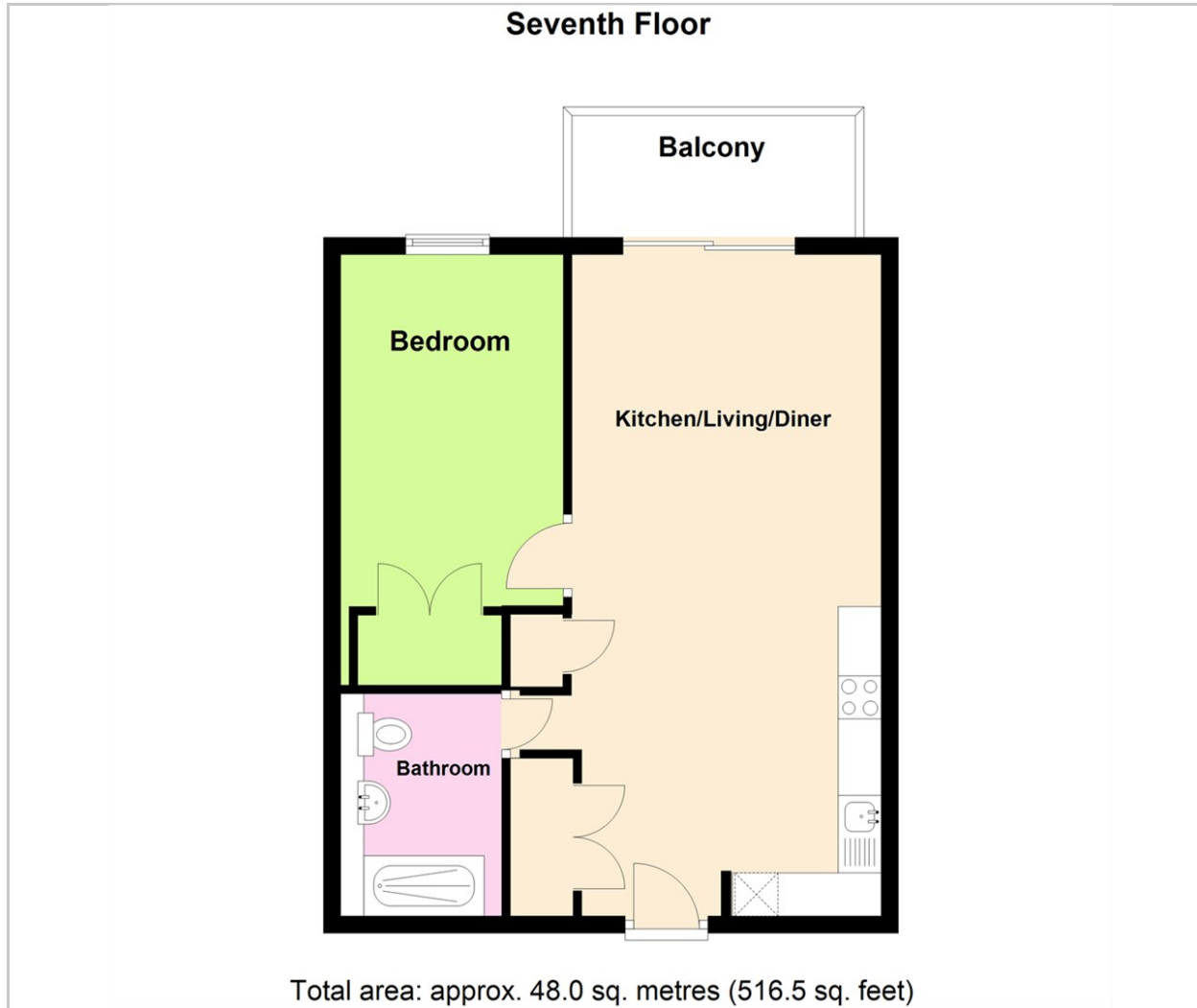

Viewing

Please contact our Reside Manchester Office on 0161 837 2840 if you wish to arrange a viewing appointment for this property or require further information.

These particulars, whilst believed to be accurate are set out as a general outline only for guidance and do not constitute any part of an offer or contract. Intending purchasers should not rely on them as statements of representation of fact, but must satisfy themselves by inspection or otherwise as to their accuracy. No person in this firm's employment has the authority to make or give any representation or warranty in respect of the property.

4 Jordan Street, Manchester, Greater Manchester, M15 4PY

Tel: 0161 837 2840 Email: info@residemanchester.com www.reside-property.com

Area Map

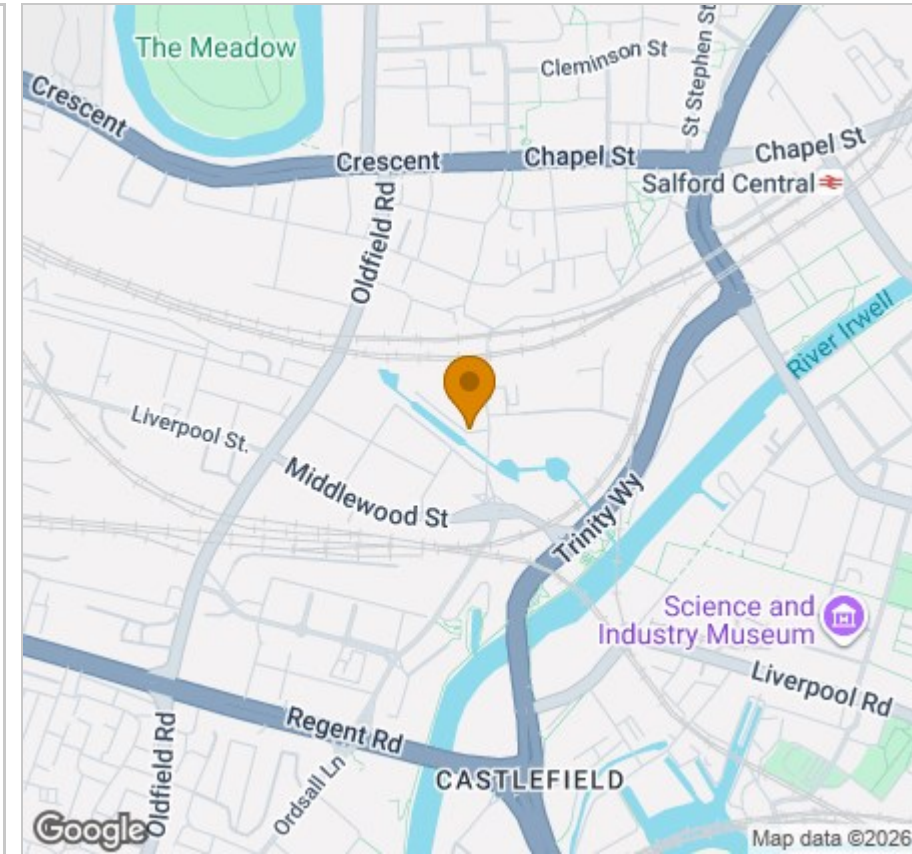

Energy Efficiency Graph

