



Apartment 75 Waterside Court, The Colonnade, Maidenhead SL6 1DL

welcome to

Apartment 75 Waterside Court, The Colonnade, Maidenhead

A lovely two bedroom, two bathroom upper floor apartment set within the highly regarded Waterside Court development, ideally positioned in the heart of the town centre.





Waterside Court, The Colonnade, Maidenhead, SL6

Approximate Area = 605 sq ft / 56.2 sq m

For identification only - Not to scale

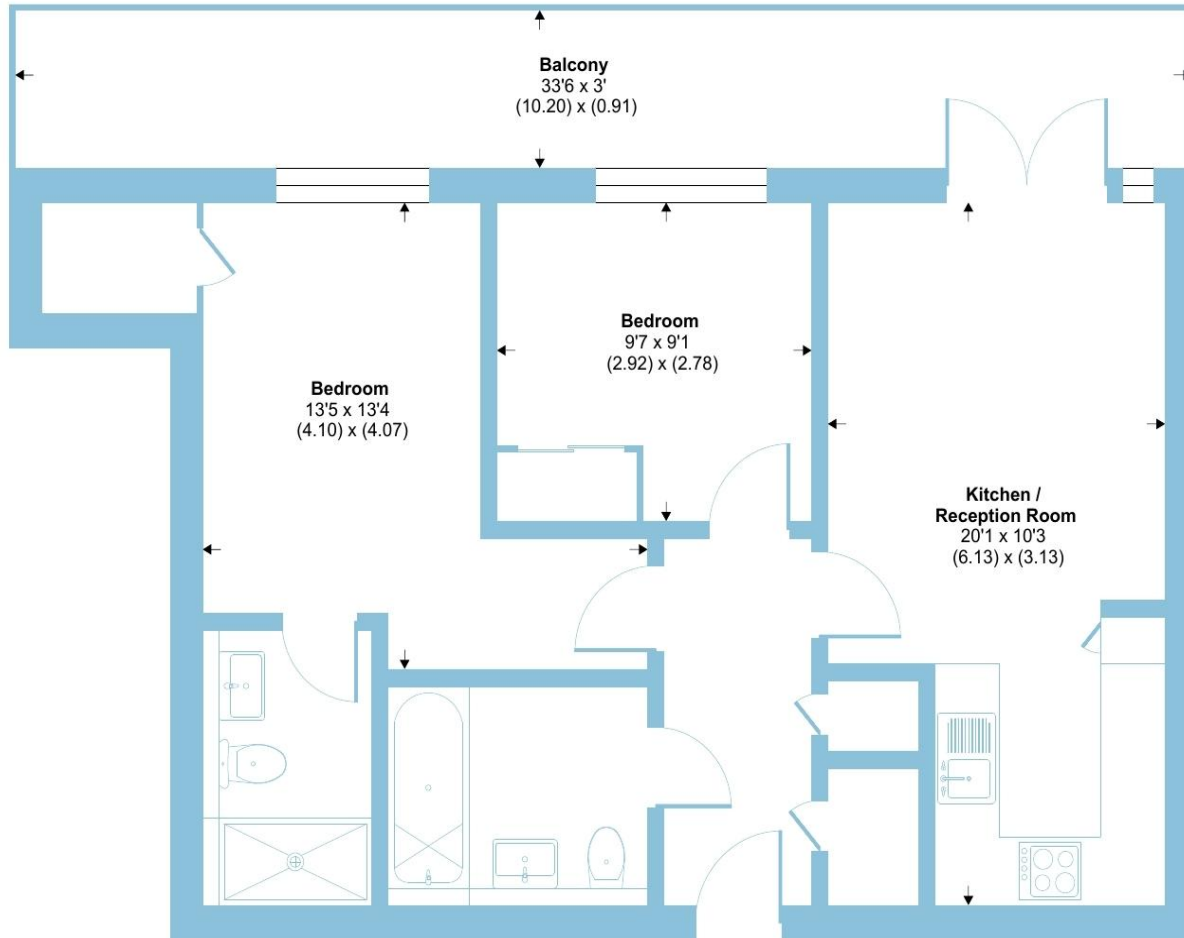

SIXTH FLOOR

 Floor plan produced in accordance with RICS Property Measurement 2nd Edition, Incorporating International Property Measurement Standards (IPMS2 Residential). © nichecom 2026. Produced for Barnard Marcus. REF: 1440764



A lovely two bedroom, two bathroom upper floor apartment set within the highly regarded Waterside Court development, ideally positioned in the heart of the town centre. The building is accessed via a secure entry system, with lift access to all upper floors for added convenience.

The apartment is presented in excellent condition throughout and benefits from an allocated parking space.

Accommodation is light and bright, featuring a spacious open-plan living area that combines a comfortable living room with a well-appointed kitchen, complete with a selection of integrated appliances. Doors from the living area lead out to a private balcony, ideal for relaxing or entertaining. The principal bedroom is a generous double and includes a stylish en-suite shower room, while the second double bedroom is served by a modern family bathroom.

This well-located apartment offers comfortable, contemporary living in a central setting.

welcome to

Apartment 75, Waterside Court

- LOVELY UPPER FLOOR MODERN APARTMENT
- TWO BEDROOMS
- TWO BATHROOMS
- BALCONY
- RESIDENTS PARKING
- TOWN CENTRE LOCATION
- EXCELLENT CONDITION THROUGHOUT
- NO ONWARD CHAIN

Tenure: Leasehold EPC Rating: B

Council Tax Band: C Service Charge: Ask Agent

Ground Rent: Ask Agent

This is a Leasehold property. We are awaiting further details about the Term of the lease. For further information please contact the branch. Please note additional fees could be incurred for items such as Leasehold packs.

£375,000



Please note the marker reflects the postcode not the actual property

check out more properties at rogerplatt.co.uk



Property Ref:
MHD123771 - 0001

1. MONEY LAUNDERING REGULATIONS Intending purchasers will be asked to produce identification documentation at a later stage and we would ask for your co-operation in order that there is no delay in agreeing the sale. 2. These particulars do not constitute part or all of an offer or contract. 3. The measurements indicated are supplied for guidance only and as such must be considered incorrect. Potential buyers are advised to recheck measurements before committing to any expense. 4. We have not tested any apparatus, equipment, fixtures or services and it is in the buyers interest to check the working condition of any appliances. 5. Where an EPC, or a Home Report (Scotland only) is held for this property, it is available for inspection at the branch by appointment. If you require a printed version of a Home Report, you will need to pay a reasonable production charge reflecting printing and other costs. 6. We are not able to offer an opinion either written or verbal on the content of these reports and this must be obtained from your legal representative. 7. Whilst we take care in preparing these reports, a buyer should ensure that his/her legal representative confirms as soon as possible all matters relating to title including the extent and boundaries of the property and other important matters before exchange of contracts.

Roger Platt is a trading name of Sequence (UK) Limited which is registered in England and Wales under company number 4268443, Registered Office is Cumbria House, 16-20 Hockliffe Street, Leighton Buzzard, Bedfordshire, LU7 1GN. VAT Registration Number is 500 2481 05.

roger platt



01628 773333



Maidenhead@rogerplatt.co.uk



25-29 Queen Street, MAIDENHEAD, Berkshire,
SL6 1NB



rogerplatt.co.uk