



## Hertford House UB5

LONG LET. This spacious two bedroom flat is set within a secure development that offers views of a wonderful marina and is located moments from local amenities

- CLOSE TO AMENITIES
- UNDERGROUND PARKING
- TWO BATHROOMS
- SEPARATE KITCHEN
- MODERN DEVELOPMENT
- WONDERFUL VIEWS OF THE MARINA

£1,750 PCM

# Hertford House

Approximate Gross Internal Area  
700 sq ft - 65 sq m

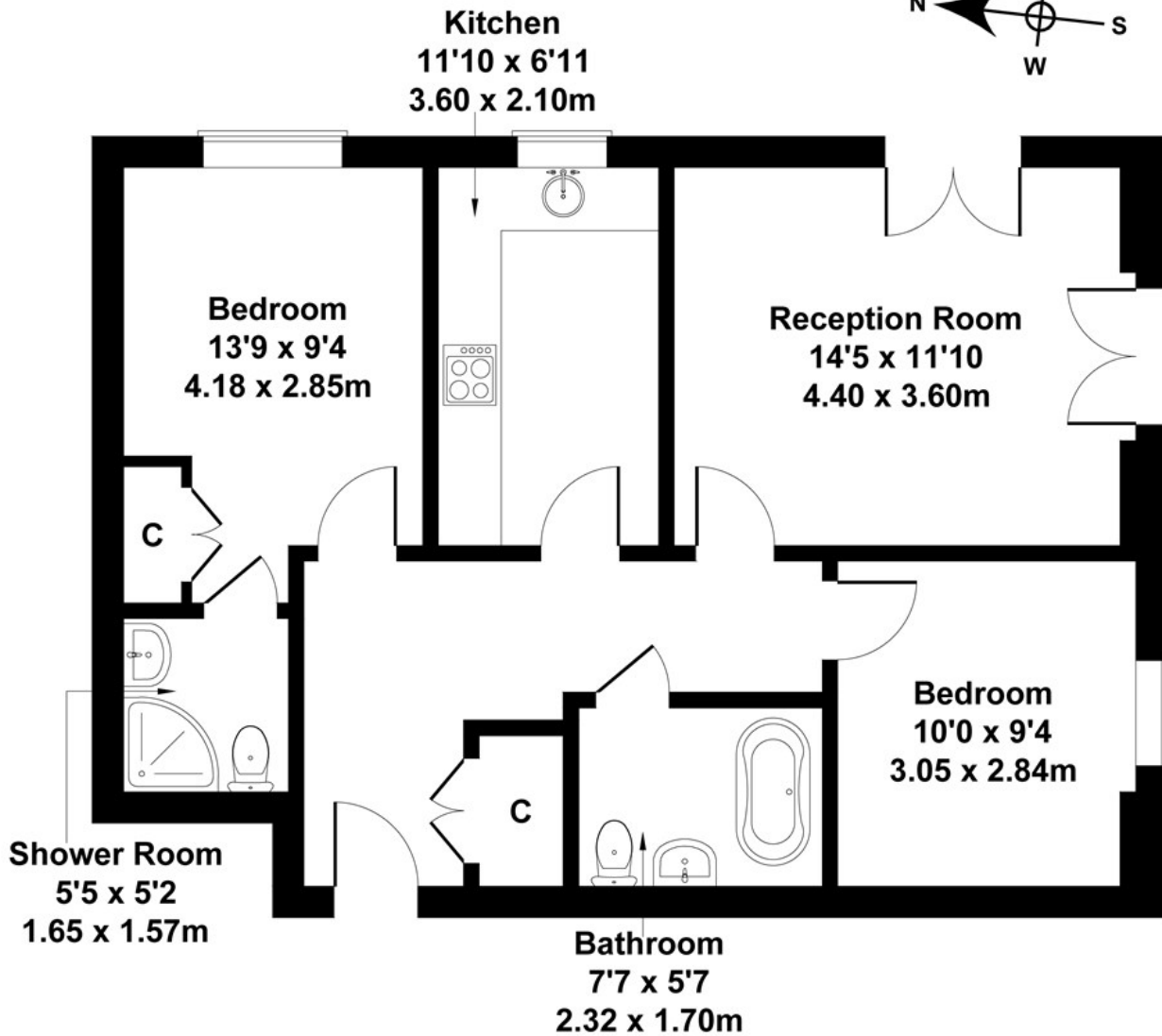
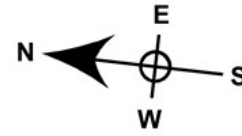

## FIFTH FLOOR

Not to Scale. Produced by The Plan Portal 2023  
For Illustrative Purposes Only.

Energy Efficiency Rating		
	Current	Potential
<i>Very energy efficient - lower running costs</i>		
(92 plus) <b>A</b>		
(81-91) <b>B</b>		
(69-80) <b>C</b>		
(55-68) <b>D</b>		
(39-54) <b>E</b>		
(21-38) <b>F</b>		
(1-20) <b>G</b>		
<i>Not energy efficient - higher running costs</i>		
<b>England &amp; Wales</b>	EU Directive 2002/91/EC	