











Offers Over

**£169,995**

## 2/6 Dalgety Road

Meadowbank | Edinburgh | EH7 5UJ

A fantastic opportunity has arisen to purchase this impressive and tastefully presented first floor flat, forming part of a handsome period terrace, located within easy reach of the city centre, in the popular Meadowbank area of the capital.

-  1 Bedroom
-  1 Box Room
-  1 Public Room
-  1 Bathroom
-  Zoned Parking
-  Communal Garden
-  EPC Rating – D
-  Council Tax Band - B



## Description

The internal accommodation is accessed via secure entry and briefly comprises: welcoming entrance hallway, light and airy reception room with a walk in storage cupboard, stylish modern kitchen fitted with a variety of sleek contemporary units, with splash back and a range of built-in appliances, good sized double bedroom with sunny south facing outlook over the communal garden, versatile box bedroom with window creating the perfect space for a home office, and fully tiled shower room with two piece white suite and electric shower. Further benefits include gas central heating and double glazing.



## Extras

All fitted floor coverings and blinds will be included in the sale together with the gas hob, oven, integrated fridge, integrated freezer and washing machine.

## Gardens & Parking

There is a well kept lawned garden to the rear of the building, with drying facilities and a southerly facing aspect. Permit/meter parking is available to the front and surrounding area.

## Viewing

By appointment through Neilsons 0131 625 2222.





## Location

The property is situated in the popular Meadowbank district of the city which is approximately two miles east of Edinburgh City Centre and within easy walking distance of Holyrood Palace and the Royal Mile. The area has a good choice of leisure and shopping facilities at both Meadowbank Sports Centre and Meadowbank Retail Park, which houses a large Sainsburys supermarket and a good variety of shops. The beautiful outdoor spaces of Holyrood Park and Arthur's Seat within close proximity of the property with the iconic Portobello beach just a short bus journey away. Many of central Edinburgh's fantastic array of attractions, art galleries, restaurants and the impressive St James Quarter, are within close proximity, together with Edinburgh City Bypass and Edinburgh Waverley train station.



Approx. Gross Internal Floor Area 50 Sq M / 534 Sq Ft.

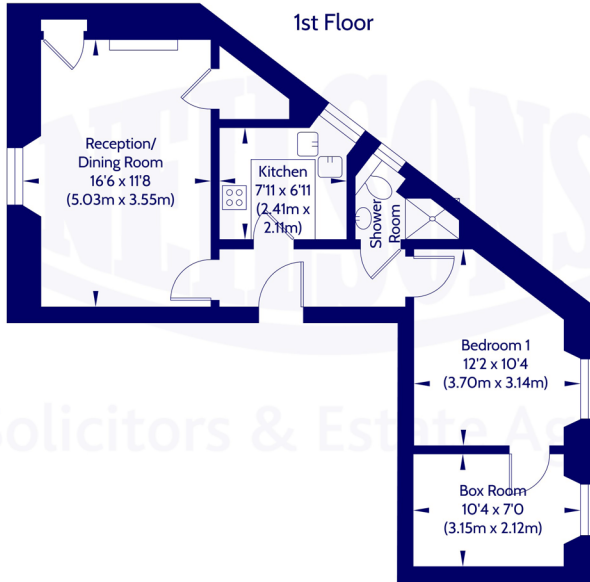

Area excludes garages, outbuildings, attics and eaves if applicable.  
All measurements are approximate. Not to scale. For identification only.  
© 2026 Neilsons Solicitors & Estate Agents. Plans by Planography.co.uk

Whilst we endeavour to ensure that our sales particulars are accurate and reliable, the following general points should be noted with regard to the extent of our investigations prior to marketing the property and therefore if any particular aspect is of crucial relevance to you, please contact this office for verification particularly if you are contemplating travelling some distance to view.

- [1] All measurements have been taken using a sonic measuring device and there may be some minor fluctuations in measurements due to the limitations of the device.
- [2] None of the items included in the sale of a working or running nature have been tested by us and this Firm gives no warranty as to their condition.
- [3] Where alterations or improvements have been undertaken by the sellers or their predecessors, we have not specifically established that the renewal or replacement of any of the services or facilities have been whole or partial.
- [4] Verification of Council Tax banding can be obtained from City of Edinburgh Council or Public Libraries.



Scan the QR code or [click here](#) for the virtual 360 tour, floor plan and further information.



Solicitors & Estate Agents

## Our Services:

- Full estate agency service
- Buying & Selling
- Buy to let advice
- Wills
- Powers of Attorney
- Executries

For helpful, friendly, personal advice, get in touch.

✉ [mail@neilsons.co.uk](mailto:mail@neilsons.co.uk)

☎ 0131 625 2222

💻 [www.neilsons.co.uk](http://www.neilsons.co.uk)

### Head Office

138-142 St John's Road  
Edinburgh  
EH12 8AY

### Property Department

162 St John's Road  
Edinburgh  
EH12 8AZ

### City Centre

2a Picardy Place  
Edinburgh  
EH1 3JT

### South Queensferry

37 High Street  
South Queensferry  
EH30 9HN

### Bonnyrigg

72 High Street  
Bonnyrigg  
EH19 2AE

