



HARDINGS



Kingsbury Drive
Price Guide £350,000





This very well presented one bedroom end-of-terrace property on Kingsbury Drive, in Old Windsor benefits from a contemporary kitchen, modern shower room and large private garden.

A convenient village location within a short distance of local schools, nurseries and amenities, with easy access to Windsor and surrounding transport links.

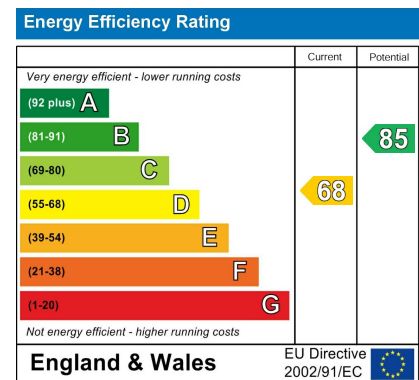

Features

- Village Location
- Modern shower room
- Good sized Private Garden
- Freehold
- Contemporary Kitchen
- Ample parking
- Close to local amenities

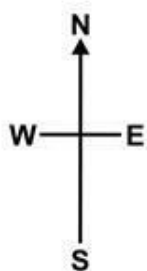

Denotes restricted
head height

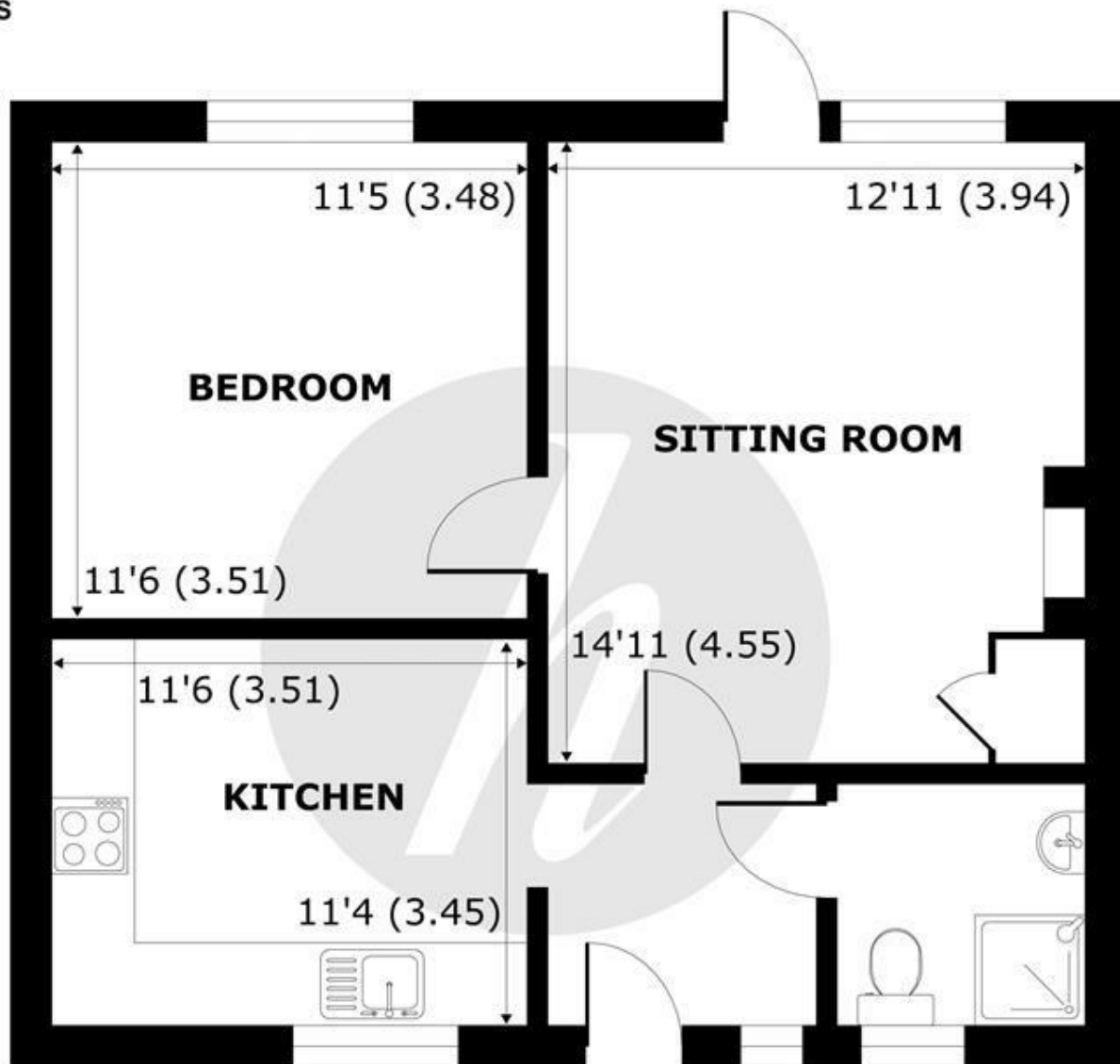

GROUND FLOOR
abt 533 SQFT (49.5 SQMT)

Kingsbury Drive, Old Windsor, Windsor, SL4

Approximate Internal Area = 533 sq ft / 49.5 sq m

For identification only - Not to scale



Floor plan produced in accordance with RICS Property Measurement 2nd Edition,
Incorporating International Property Measurement Standards (IPMS2 Residential). © nichecom 2025.
Produced for Hardings. REF: 1406047





11 High Street, Windsor, Berkshire, SL4 1LD,
T: 01753 833 118 | E: info@hardings.co.uk
www.hardings.co.uk

