



Pound Lane Central Laindon, Basildon, SS15 4EX Guide Price £375,000

**** GUIDE PRICE £375,000 - £400,000 ****

This exceptional two-bedroom residence is presented to the market in impeccable condition throughout, having been meticulously maintained to deliver a truly turnkey luxury home finished to an exacting standard.

The accommodation has been thoughtfully designed to maximise space, light, and flow, creating an elegant yet comfortable living environment. The living areas are bright and beautifully proportioned, offering a refined setting for both everyday living and entertaining. Every detail reflects quality craftsmanship and a contemporary aesthetic.

The property offers two generously sized bedrooms, each providing stylish and tranquil retreats, ideal for professionals, couples, or those seeking luxury living without compromise. The overall layout delivers both practicality and a sense of understated sophistication.

To the front of the property, there is off-street parking for two vehicles, a highly desirable feature that adds both convenience and strong kerb appeal.

To the rear, the home enjoys a professionally landscaped garden, designed to be both low

- GUIDE PRICE £375,000 - £400,000
- TWO BEDROOM HOUSE
- PARKING
- SOUGHT-AFTER LOCATION
- LOW MAINTENANCE LANDSCAPED REAR GARDEN
- OPEN PLAN LIVING
- OUTBUILDING
- HIGH SPECIFICATION
- COUNCIL TAX BAND - C - BASILDON
- EPC - C

Viewing

Please contact our Sales Office on 01268 730707 if you wish to arrange a viewing appointment for this property or require further information.

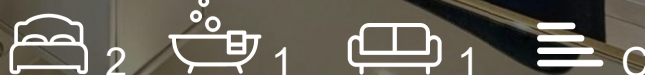

Floor Plan

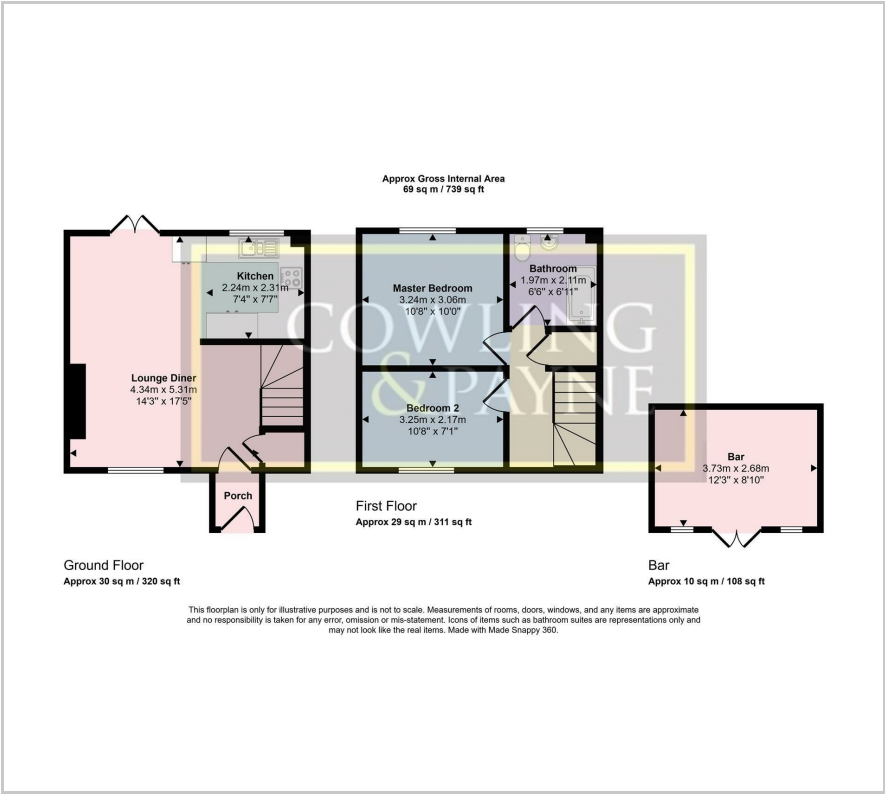

Area Map



Energy Efficiency Graph

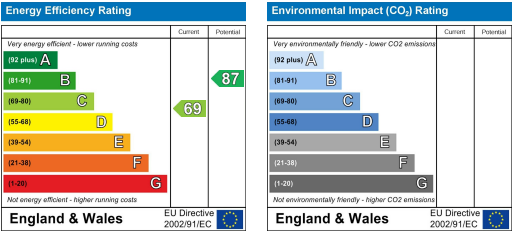

These particulars, whilst believed to be accurate are set out as a general outline only for guidance and do not constitute any part of an offer or contract. Intending purchasers should not rely on them as statements of representation of fact, but must satisfy themselves by inspection or otherwise as to their accuracy. No person in this firms employment has the authority to make or give any representation or warranty in respect of the property.