

**2a Darvell Drive, Chesham, Buckinghamshire,
HP5 2QL**



ROBSONS
RESIDENTIAL SALES

2a Darvell Drive, Chesham, Buckinghamshire, HP5 2QL

A bright and contemporary one-bedroom top-floor apartment, set in a semi-rural location on the outskirts of Chesham adjoining open countryside. This beautifully presented property benefits from a private garden and driveway parking for one car, while enjoying elevated views across surrounding farmland and fields. Offered with a 1/3 share of the freehold and a 999-year lease from 1 January 2019, with no ground rent or service charge payable.

Leasehold - EPC rating: C. Council Tax Band: C

Chesham is a popular old market town within the Chilterns and positioned at the end of the Metropolitan Line providing a fast rail service into the West End and City of London (Baker Street approx. 55 minutes). The town provides a busy pedestrianised high street, featuring a twice weekly market selling local produce, specialist individual shops and national retailers including Waitrose, Boots and Sainsburys. In addition, the Elgiva theatre/cinema offers a regular programme whilst Lowndes Park includes a lake, child's playground and immediate access to the surrounding countryside which forms part of the Chilterns Area of Outstanding Natural Beauty. Chesham Station is approximately 1.15 miles from the property and access to the motorway network can be found at nearby Hemel Hempstead (M1), Chorleywood (M25) and Beaconsfield (M40). The area is also recognised for its highly regarded schooling at both primary and senior level including the acclaimed Chesham Grammar School and the renowned Dr Challoner's Grammar Schools The Beacon School (Boys) for Nursery – Year 8, Heatherton (Girls) and Chesham Prep (Mixed) for Nursery – Year 6: whilst senior schooling can be found at Berkhamsted School (Boys and Girls), Royal Masonic (Girls) & Pipers Corner (Girls).



Viewing by appointment only

via

Robsons Estate Agents

1 White Hill Court

Chesham

Buckinghamshire

HP5 3EA

Tel: 01494 724999

email: property@robsonsbucks.com



Directions: From our Chesham office proceed along Broad Street and turn left onto Townsend Road. At the junction, turn right onto Bellingdon Road, and then take third left turning onto Asheridge Road. Take the 2nd turning on your left onto Darvell Drive. No. 2a can be found immediately on the right.

* The particulars of Sale have been prepared as a general guide only. We have not carried out a detailed survey of the structure or tested the services, equipment and appliances and interested parties should commission their own reports. Room sizes are approximate and should not be relied upon when ordering carpets, curtains or other furnishings. Garden and site measurements are approximate and boundaries have been measured as fenced or taken from the Ordinance Survey via Promap or both.

Purchasers should seek confirmation of the legal boundaries from their solicitor prior to proceeding with a purchase.

* Robsons for themselves and for the vendors or lessors of this property give notice that; (i) the particulars are set out as a general outline only for the guidance of intended purchasers or lessees, and do not constitute part of, an offer or contract; (ii) all descriptions, dimensions, references to condition and necessary permissions for use and occupation, and other details are given without responsibility and any intending purchasers or tenants should not rely on them as statements or representations of fact but must satisfy themselves by inspection or otherwise as to the correctness of each of them; (iii) no person in the employment of Robsons has any authority to make or give any representation or warranty whatever in relation to this property

2a Darvell Drive, Chesham, Buckinghamshire, HP5 2QL

Approx. Gross Area
41 sq m – 441 sq ft

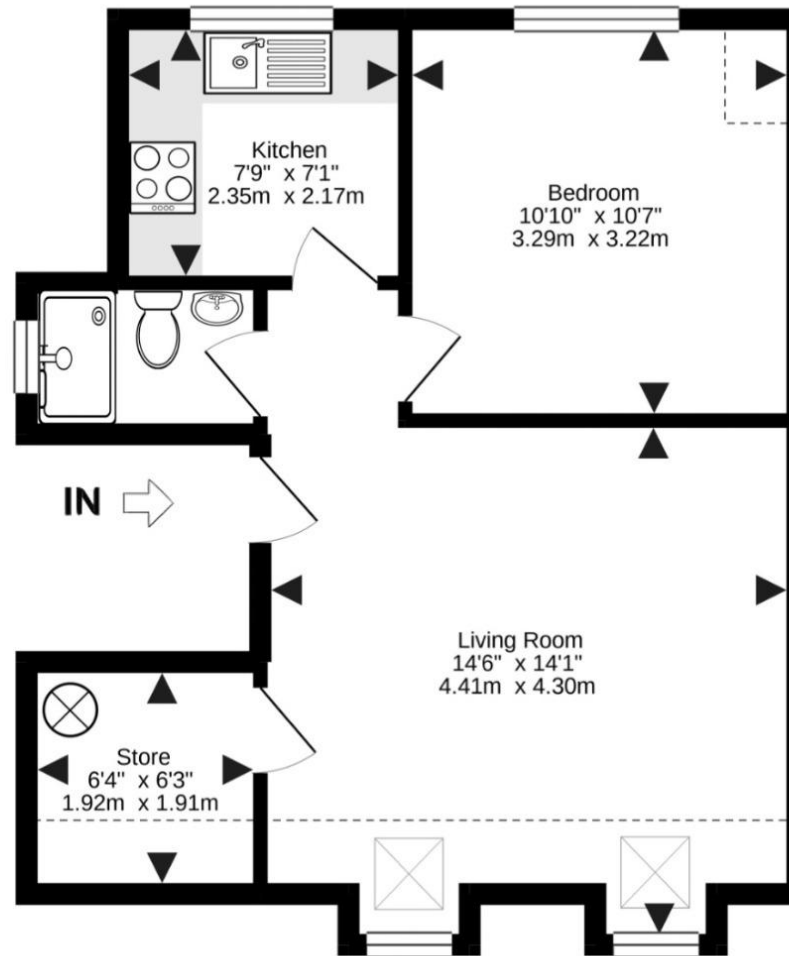

This floor plan is provided by Expert Survey Solutions Ltd and is for indicative guidance only. Whilst every attempt has been made to ensure the accuracy of the floor plans contained here, measurements of doors, windows and rooms are approximate and no responsibility is taken for any error, omission or mis-statement. Details shown on this floorplan including all measurements, areas and proportions cannot be guaranteed by either the provider or Robsons and should not be relied upon. If there is any area where accuracy is required, please contact the selling agent for clarification.

