



## RUNNYMEDE CRESCENT, SW16

£700,000

- Four bedrooms
- Two bathrooms
- Private garden
- Close to amenities
- Excellent transport links
- Energy rating:





## ABOUT THE HOME

A very well-presented four bedroom family home, benefiting from an extended open plan kitchen-family room, a further reception room, two bathrooms and downstairs WC, and a lovely private garden with side access.

Runnymede Crescent is situated in the desirable Streatham Vale area and is close to the shops, cafes and other amenities of Greyhound Lane; and walking distance to the expansive green & open spaces of Streatham Common & the Rookery. Commuters benefit from swift services to London Victoria, Clapham Junction, London Bridge and the City from Streatham Common station, and bus routes into Brixton from the nearby Streatham High Road. The property also benefits from catchment for a number of excellent primary and secondary schools.





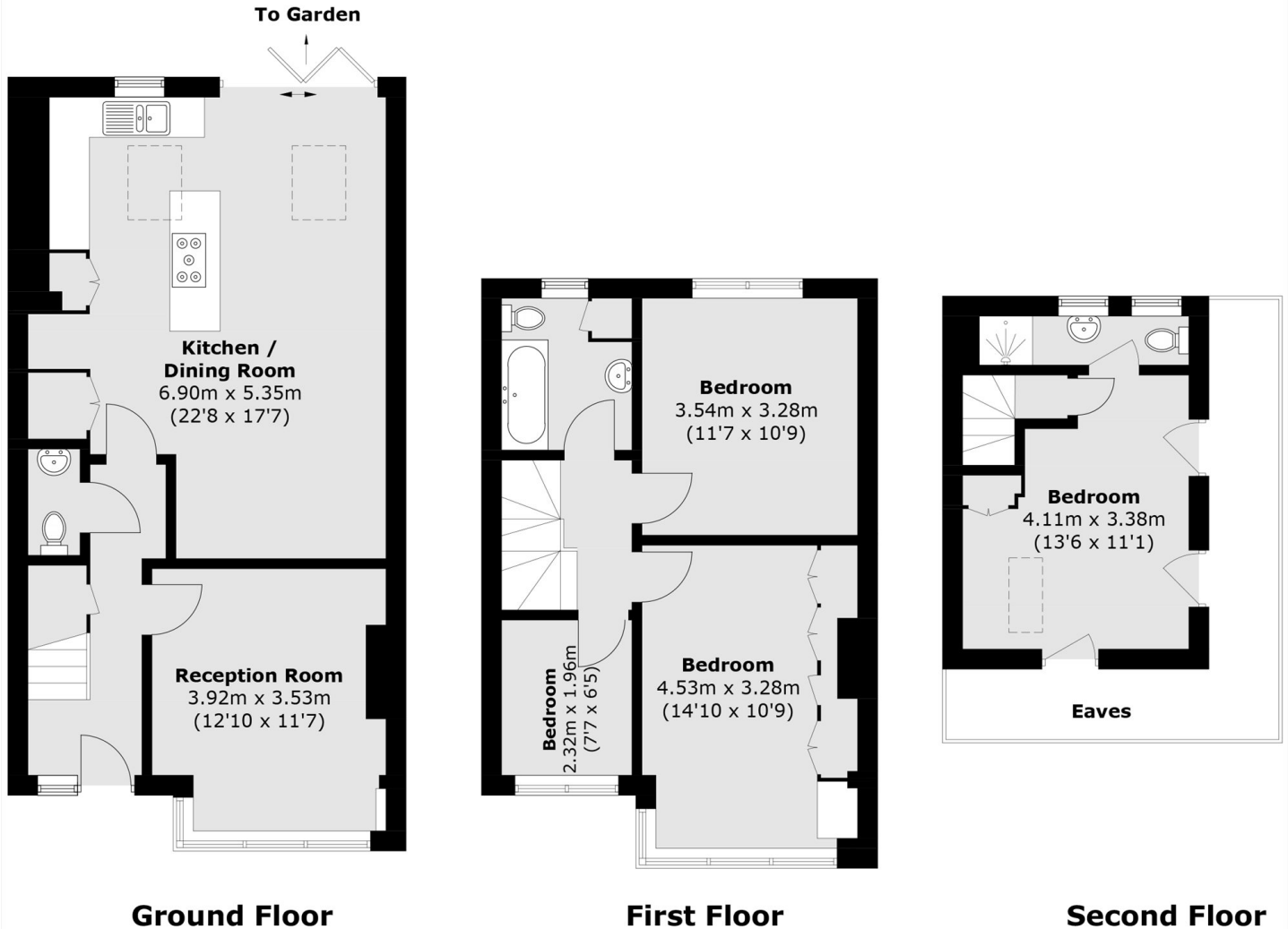

Total area (approx.): 114.3 sq. m (1,230.4 sq. ft)  
(Excluding Eaves)

### JACKSONS STREATHAM

1-3 De Montfort Parade,  
Streatham High Road,  
Sales: 020 8487 3179  
Lettings: 020 8487 3180

Energy Rating: We aim to make our particulars both accurate and reliable. However they are not guaranteed; nor do they form part of an offer or contract. If you require clarification on any points then please contact us, especially if you're traveling some distance to view. Please note that appliances and heating systems have not been tested and therefore no warranties can be given as to their good working order.