



WETHERELL
MAYFAIR'S FINEST PROPERTIES



Curzon Street, W1J

£2,000 Per week

The apartment is situated on the fourth floor of this newly developed building, complete with a lift and porter and located within walking distance of Berkeley Square.

This stylish property comprises two well-proportioned bedrooms, two bathrooms and a large open plan kitchen. The apartment boasts high quality fixtures, fittings and furnishings as well as air-conditioning and wood flooring throughout.

Hyde Park is only a short walk away and there are numerous transport links, including Green Park, Hyde Park and Piccadilly Circus.

Curzon Street is close to Shepherd Market which contains many fine restaurants and private members clubs.



FEATURES

- High Standard Specification • Air Conditioning • Lift Access • Porter • Near Berkeley Square • Open-Plan Kitchen •



Curzon Street,
London, W1J

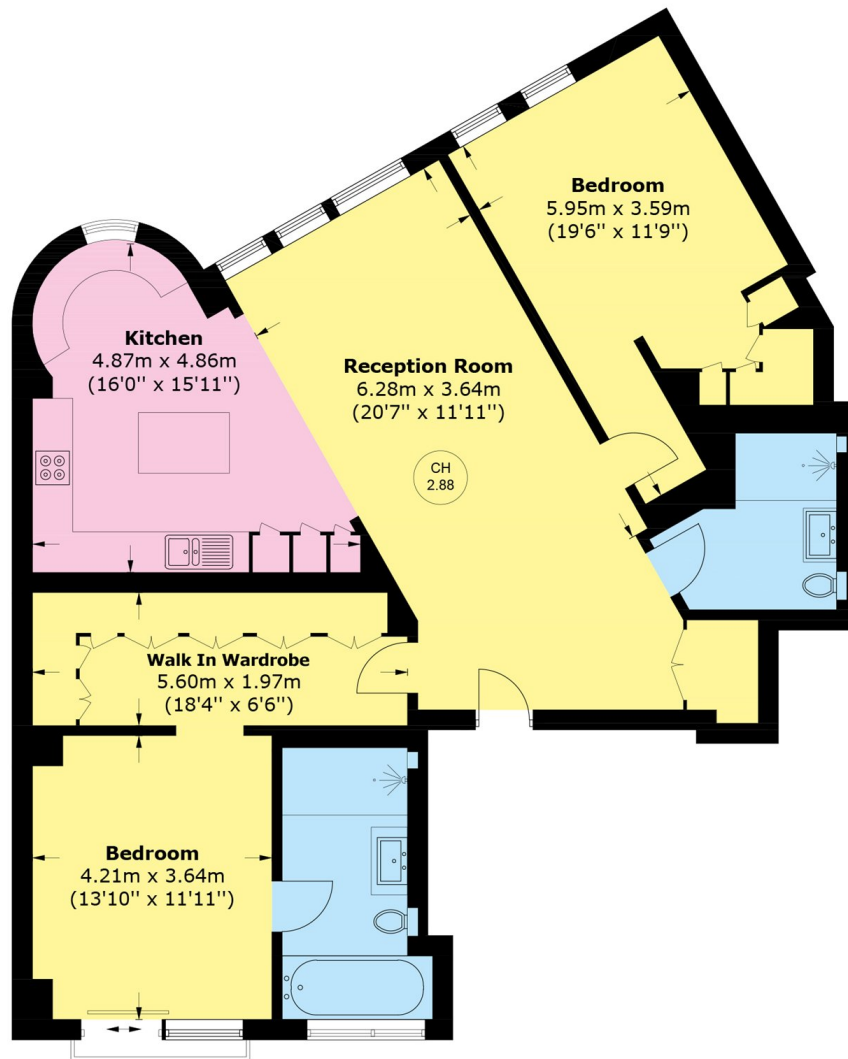

Fourth Floor

Total area (approx.): 115.6 sq. m (1,244.3 sq. ft)



WETHERELL
MAYFAIR'S FINEST PROPERTIES

102 Mount Street,
London, W1K 2TH

T: 020 7529 5588
E: rentals@wetherell.co.uk

We aim to make our particulars both accurate and reliable. However they are not guaranteed; nor do they form part of an offer or contract. If you require clarification on any points then please contact us, especially if you're traveling some distance to view. Please note that appliances and heating systems have not been tested and therefore no warranties can be given as to their working order.



wetherell.co.uk