





£290,000

Situated in the popular area of Walnut Tree is this three-bedroom mid-terrace home. The property comprises a lounge/diner, kitchen and family bathroom. Further benefits include off-road parking.

Property Description

ENTRANCE

Door to entrance porch.

ENTRANCE PORCH

Door to entrance hall.

ENTRANCE HALL

Radiator, stairs to first floor, electric radiator, doors to lounge/diner.

LOUNGE/DINER

Double glazed window to front aspect. Radiator, door to kitchen.

KITCHEN

Double glazed window to rear aspect, frosted double glazed door to garden. Range of wall mounted and floor standing units with work surface over, space for cooker, washing machine and dishwasher, space for tumble dryer and fridge/freezer, one and a half bowl stainless steel single drainer sink with mixer tap

LANDING

Access to loft space, doors to bedrooms bathroom and storage cupboard.

BEDROOM ONE

Double glazed window to rear aspect. Radiator.

BEDROOM TWO

Double glazed window to front aspect. Radiator.

BEDROOM THREE

Double glazed window to front aspect. Radiator.

BATHROOM

Pedestal wash hand basin, low level w.c., heated towel rail, panelled bath with mixer tap and shower over, part tiled walls.

OUTSIDE

PARKING

One allocated parking space.

FRONT GARDEN

Pathway to front door, mainly gravel, door to outbuilding.

REAR GARDEN

Wooden decking area, enclosed by wooden fencing panels, mainly gravel, flower bed, outside tap.

GROUND FLOOR
453 sq.ft. (42.1 sq.m.) approx.

1ST FLOOR
440 sq.ft. (40.9 sq.m.) approx.

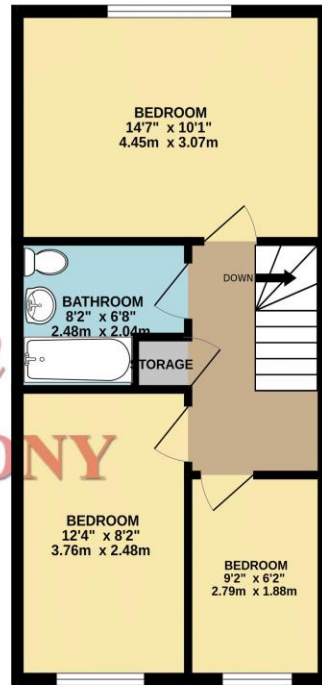
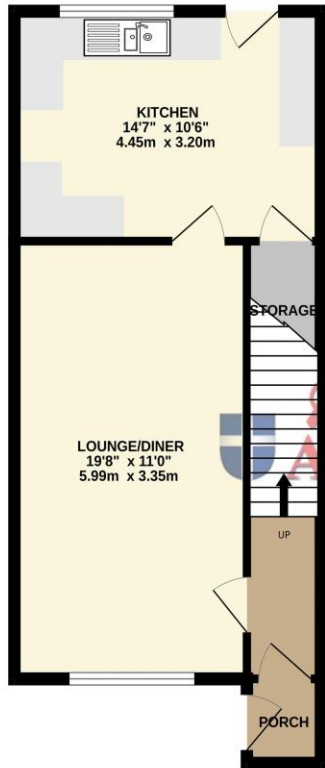

Michael
ANTHONY

TOTAL FLOOR AREA: 893 sq.ft. (83.0 sq.m.) approx.

Whilst every attempt has been made to ensure the accuracy of the floorplan contained here, measurements of doors, windows, rooms and any other items are approximate and no responsibility is taken for any error, omission or mis-statement. This plan is for illustrative purposes only and should be used as such by any prospective purchaser. The services, systems and appliances shown have not been tested and no guarantee as to their operability or efficiency can be given.
Made with Metropix ©2025

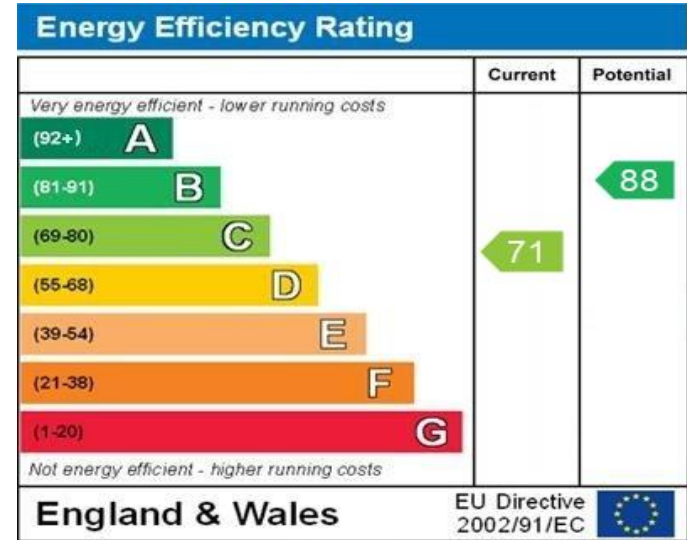

WWW.EPC4U.COM

MONEY LAUNDERING REGULATIONS 2017 intending purchasers will be asked to produce identification and proof of financial status when an offer is received. We would ask for your co-operation in order that there will be no delay in agreeing the sale.

THE CONSUMER PROTECTION REGULATIONS 2008 The Agent has not tested any apparatus, equipment, fixtures and fittings or services and so cannot verify that they are in working order or fit for the purpose. A Buyer is advised to obtain verification from their Solicitor or Surveyor. References to the Tenure of a Property are based on information supplied by the Seller. The Agent has not had sight of the title documents. A Buyer is advised to obtain verification from their Solicitor. You are advised to check the availability of this property before travelling any distance to view. We have taken every precaution to ensure that these details are accurate and not misleading. If there is any point which is of particular importance to you, please contact us and we will provide any information you require. This is advisable, particularly if you intend to travel some distance to view the property. The mention of any appliances and services within these details does not imply that they are in full and efficient working order. These particulars are in draft form awaiting Vendors confirmation of their accuracy. These details must therefore be taken as a guide only and approved details should be requested from the agents

190 Queensway Bletchley Milton Keynes MK2 2ST
01908 648 666 | bletchley@maea.co.uk