



## BOLLO LANE, W4

£320,000

A spacious one-bedroom apartment within a new build development on Bollo Lane, Chiswick. The property offers amazing views, a roof terrace, and a modern specification throughout.

Spacious one-bedroom  
Pocket living scheme  
New build development

Amazing views  
Communal roof terrace  
Energy rating: b

# STEP INSIDE BOLLO LANE

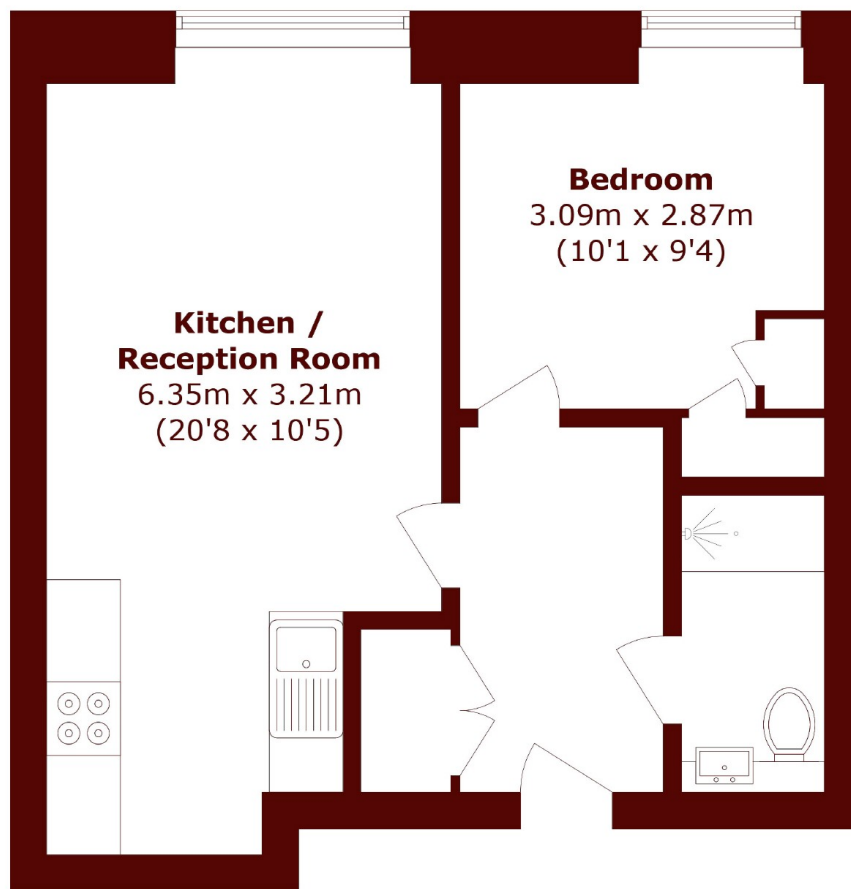

Total area (approx.): 39.2 sq. m (422.0 sq. ft)

Chiswick  
020 8994 2556

Energy Rating: B We aim to make our particulars both accurate and reliable. However, they are not guaranteed; nor do they form part of an offer or contract. If you require clarification on any points then please contact us, especially if you're traveling some distance to view. Please note that appliances and heating systems have not been tested and therefore no warranties can be given as to their good working order

MARSH &  
PARSONS